

# Ashgrove Road

## BEDMINSTER

APPROXIMATE FLOOR AREA  
92.8 SQM / 998 SQFT



GARDEN STORE/WORKSHOP  
0 sq ft (0.0 sq m) approx.



GROUND FLOOR  
421 sq ft (38.1 sq m) approx.

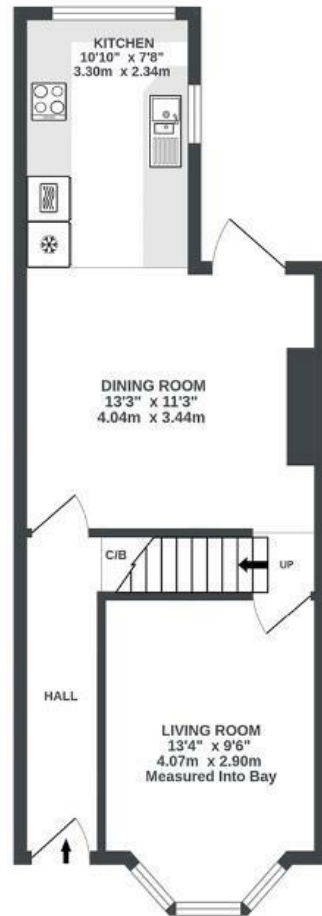

1ST FLOOR  
408 sq ft (37.9 sq m) approx.



2ND FLOOR  
189 sq ft (15.7 sq m) approx.

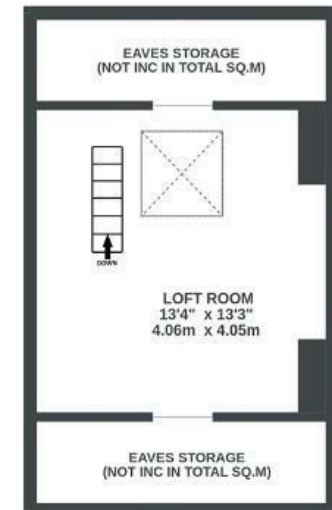

Illustrations are for reference purposes only, measurements are approximate, not to scale.

Boardwalk

# Ashgrove Road

BEDMINSTER, BRISTOL



£450,000



2 Bedrooms



Bristol, BS3



1 Bathrooms

3.1W



*"The south facing garden has been brilliant for entertaining in - the sun appears from around noon and stays until sun down! The kitchen's breakfast bar, overlooking our shed's living roof, has been a feature enjoyed daily since we added a new large window to this end of the room. And of course, the location is amazing!"*