

# County Street

## TOTTERDOWN

APPROXIMATE FLOOR AREA  
44.2 SQM / 476 SQFT



FIRST FLOOR

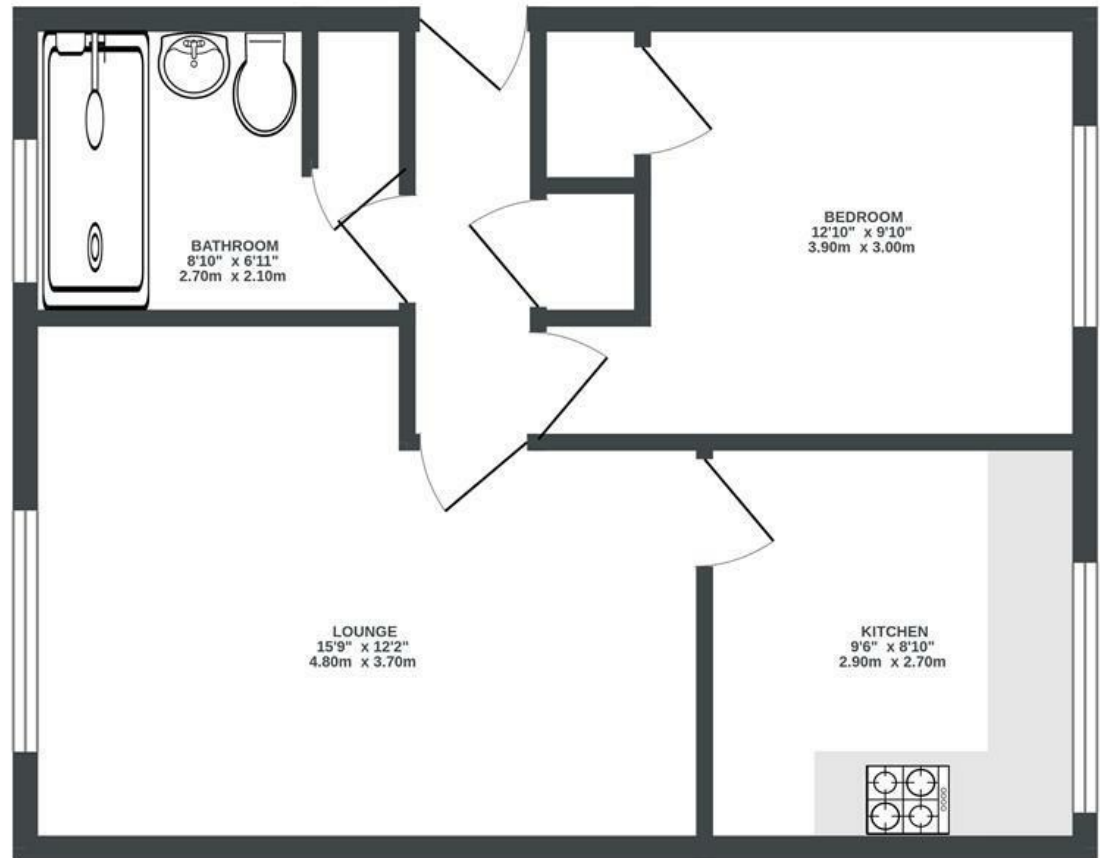

BATHROOM  
8'10" x 6'11"  
2.70m x 2.10m

BEDROOM  
12'10" x 9'10"  
3.90m x 3.00m

LOUNGE  
15'9" x 12'2"  
4.80m x 3.70m

KITCHEN  
9'6" x 8'10"  
2.90m x 2.70m

Boardwalk

# County Street

## TOTTERDOWN, BRISTOL



£200,000



1 Bedrooms



Bristol, BS4  
3AG



1 Bathrooms

*The property is in a hugely convenient location, just a short walk from Bristol Temple Meads, with several of the trendy cafes and independent shops in the Totterdown area also on the doorstep. The flat itself comprises an attractive living space measuring 4.8 x 3.8 metres at maximum points, with an additional kitchen/breakfast room, bedroom and bathroom. To the outside, the property benefits from an allocated parking space.*

