

Kingsgate House

KINGSWOOD

APPROXIMATE FLOOR AREA
58 SQM / 624 SQFT



GROUND FLOOR

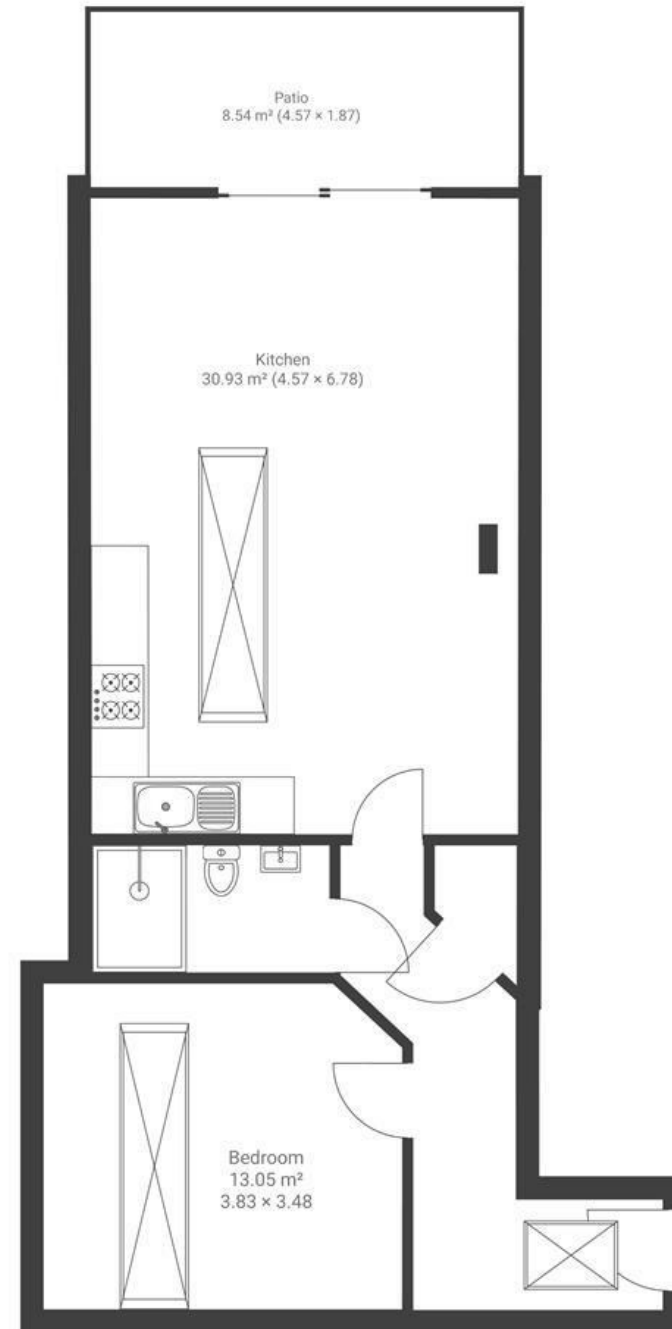

Boardwalk

Church Road , BRISTOL



£200,000



1 Bedrooms



Bristol, BS15



1 Bathrooms

4FT

"This flat has been the perfect first home. Being close to the Bristol-Bath cycle path is amazing for cycle commuting, dog walks, bike rides and flat runs. The Warmley waiting rooms is a favourite café of mine, the Lyons den micropub on the highstreet is fab and the Rose and Crown pub do a cracking roast!"

