

Priory Gardens

HORFIELD

APPROXIMATE FLOOR AREA
67.4 SQM / 726 SQFT



GROUND FLOOR
363 sq.ft. (33.7 sq.m.) approx.

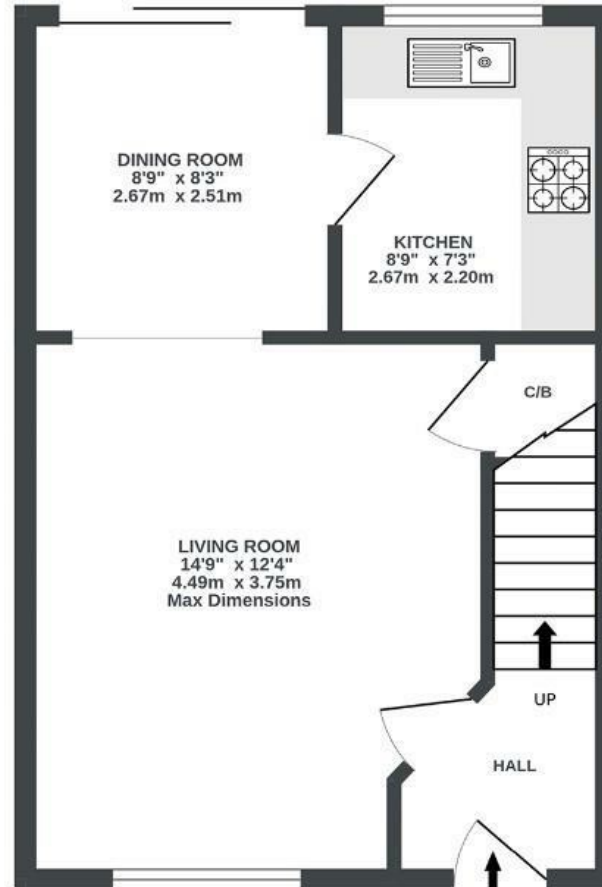

FIRST FLOOR
363 sq.ft. (33.7 sq.m.) approx.

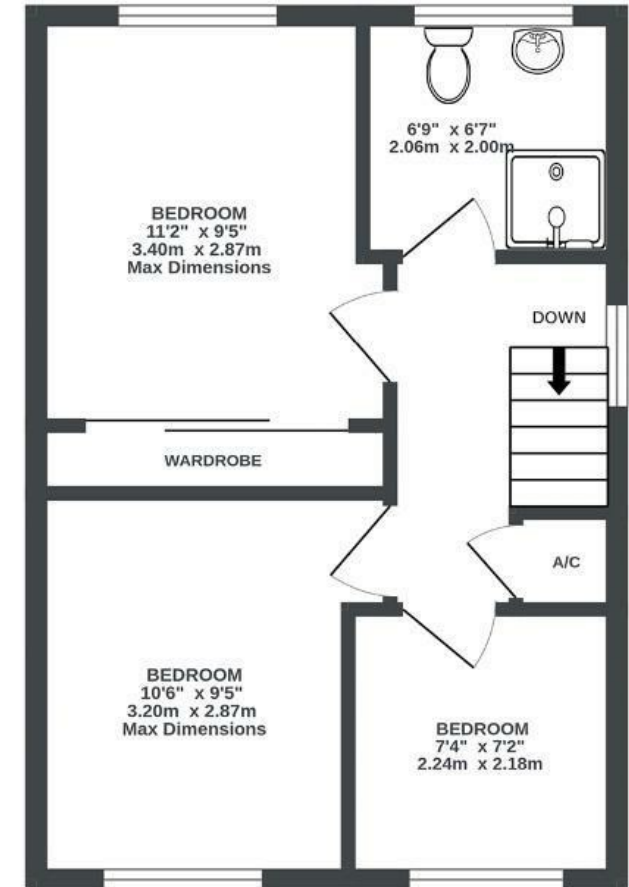

Illustrations are for reference purposes only, measurements are approximate, not to scale.

Boardwalk

Priory Gardens

HORFIELD, BRISTOL



£375,000



3 Bedrooms



Bristol, BS7
OXF



1 Bathrooms

"We have loved living in this street, the neighbours are amazing and there is such a community feel. Being detached has been such a bonus, especially in this area and we will definitely miss our garden. Hopefully the next family will enjoy this home as much as we have."

