

Shadwell Road

BISHOPSTON

APPROXIMATE FLOOR AREA
108.3 SQM / 1166 SQFT



GROUND FLOOR
616 sq.ft. (57.2 sq.m.) approx.

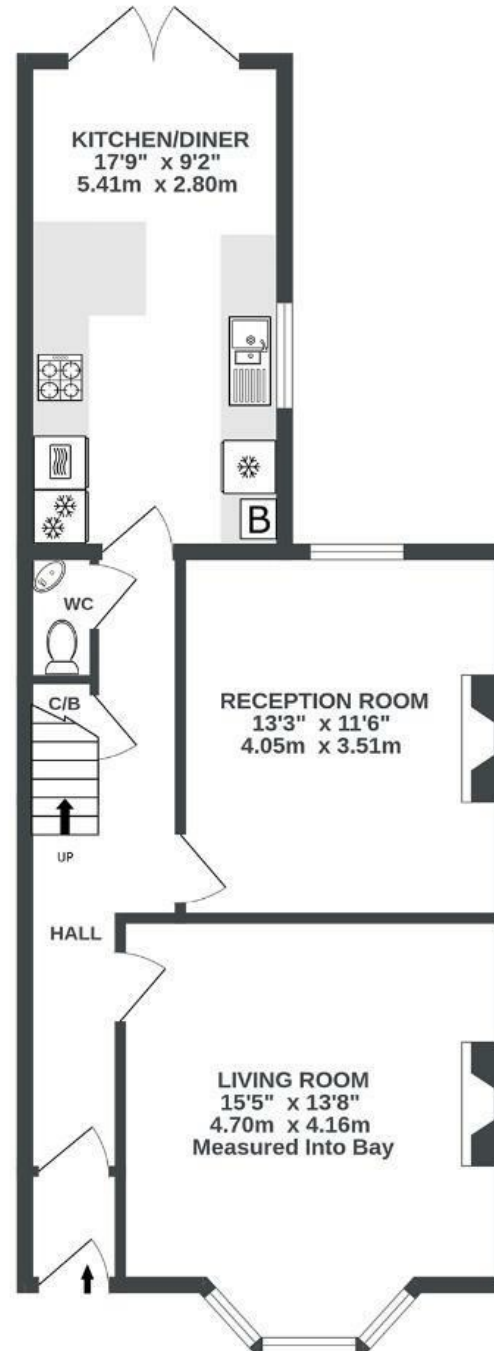

1ST FLOOR
550 sq.ft. (51.1 sq.m.) approx.

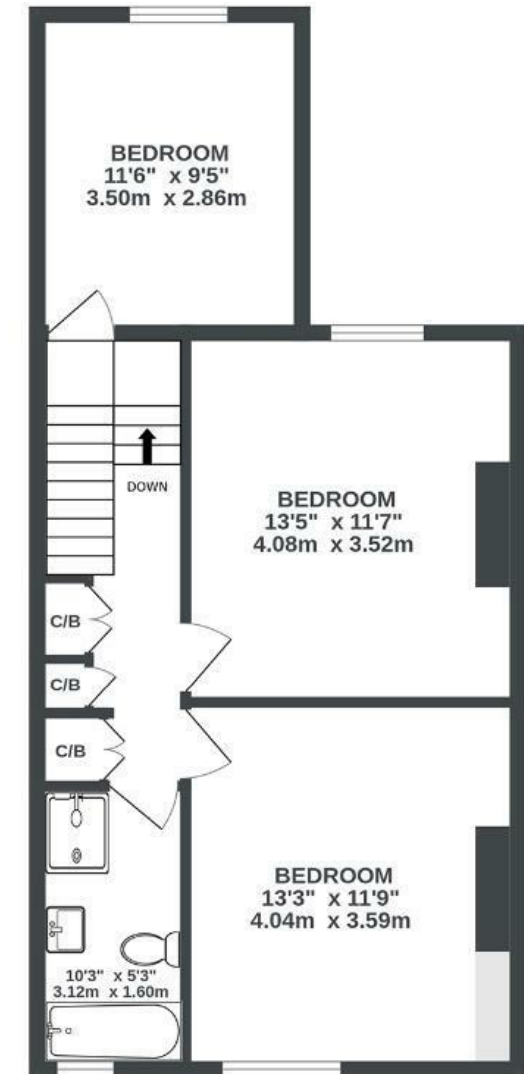

Illustrations are for reference purposes only, measurements are approximate, not to scale.

Boardwalk

Shadwell Road

BISHOPSTON, BRISTOL



£635,000



3 Bedrooms



Bristol, BS7



1 Bathrooms

8FW



"My favourite spot is sitting in the garden in the morning sun with a cuppa, its so peaceful. Shadwell Road has such a great community, there is always someone on hand to help you out if you need any help!"