

# Hardy Road

## BEDMINSTER

APPROXIMATE FLOOR AREA  
93.7 SQM / 1008 SQFT

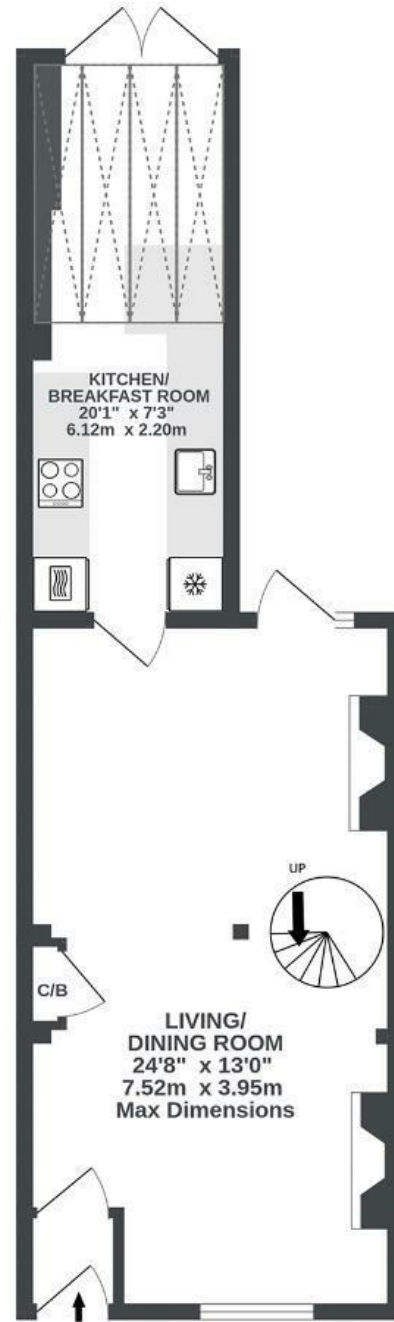

GROUND FLOOR  
443 sq.ft. (41.1 sq.m.) approx.

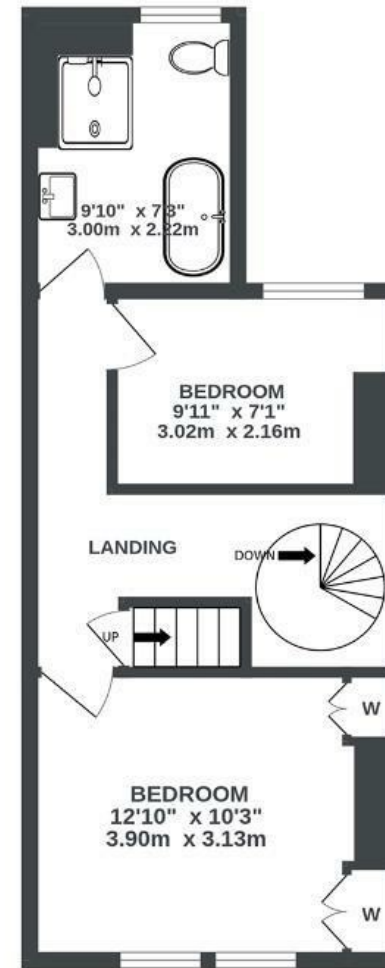

1ST FLOOR  
361 sq.ft. (33.6 sq.m.) approx.

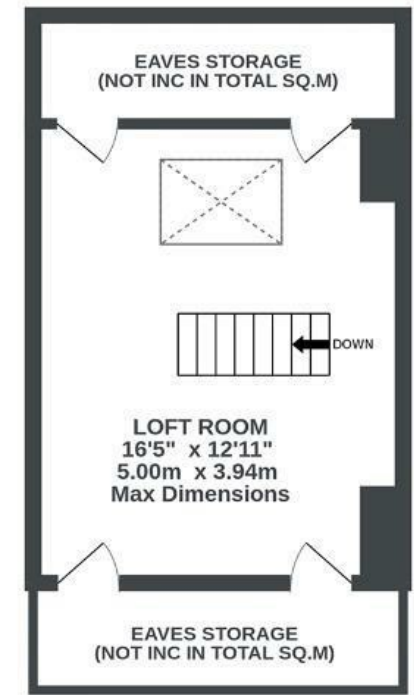

2ND FLOOR  
205 sq.ft. (19.0 sq.m.) approx.



Boardwalk

# Hardy Road , BRISTOL



£395,000



2 Bedrooms



Bristol, BS3



1 Bathrooms

2SN

*"Our home has an open plan lay out that makes cooking and socialising very enjoyable. We love to have breakfast at our breakfast bar, with the sun beaming down on us through the glass ceiling and the backdoors wide open letting in a breeze whilst listening to the radio. On a Sunday we enjoy heading to North Street for a yoga class or swim at Bristol south pool followed by a stroll round the tobacco factory market. Then on to the old bookshop our favourite pub for a drink or friendly records bar where you can often find fiddlers playing as well as guest musicians playing intimate sets."*

