

Ashton Gate Road

SOUTHVILLE

APPROXIMATE FLOOR AREA
121 SQM / 1303 SQFT



GROUND FLOOR
587 sq.ft. (54.5 sq.m.) approx.

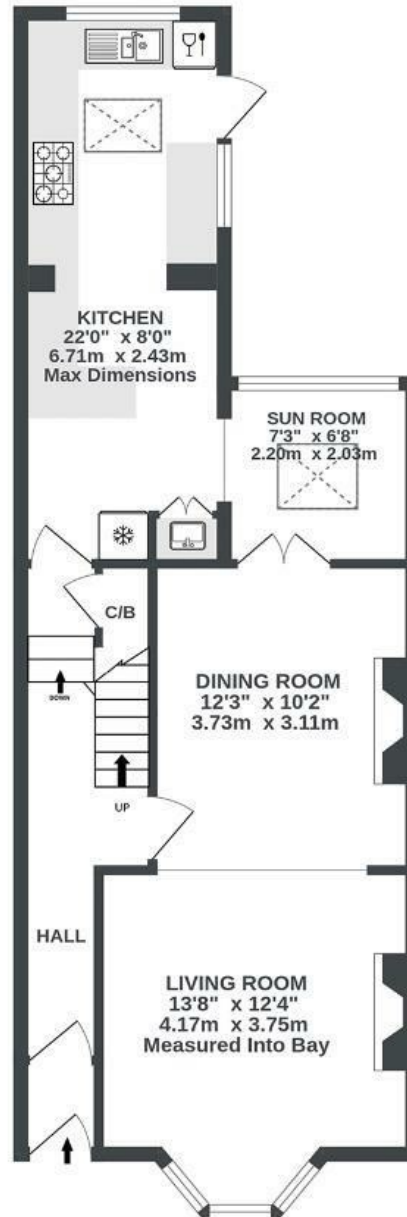

1ST FLOOR
453 sq.ft. (42.1 sq.m.) approx.



2ND FLOOR
263 sq.ft. (24.4 sq.m.) approx.

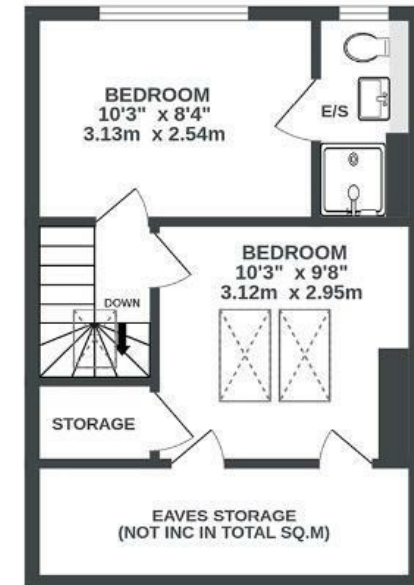

Illustrations are for reference purposes only, measurements are approximate, not to scale.

Boardwalk

Ashton Gate

, BRISTOL



£600,000



4 Bedrooms



Bristol, BS3
1S7



2 Bathrooms

"We have loved living on Ashton Gate Road, a hidden gem in Southville it's moments from Greville Smyth Park, Marks Bread, and all of the amenities North Street has to offer, yet it is beautifully quiet. There's a brilliant community on Ashton Gate Road and it's been a special place to bring up our young family. We have spent many afternoons playing in the garden or building Lego in our bright front room on the carpet, then recovering from the day in our light and airy kitchen with a gin and tonic."

