

Oak Road

HORFIELD

APPROXIMATE FLOOR AREA
88.6 SQM / 953 SQFT

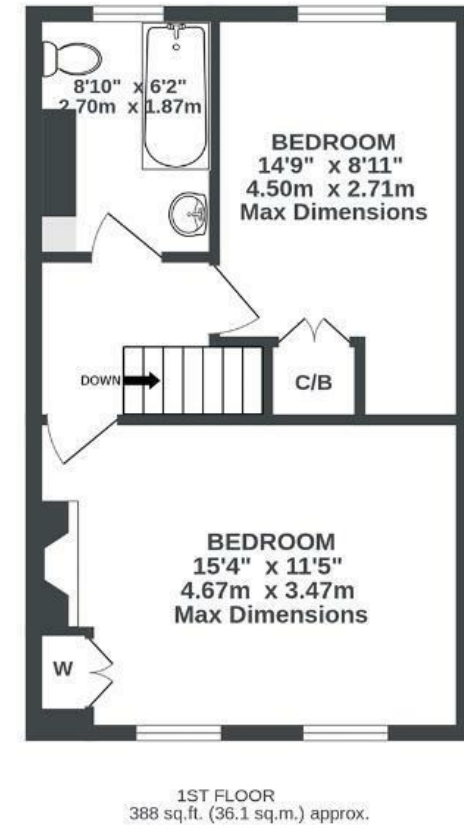
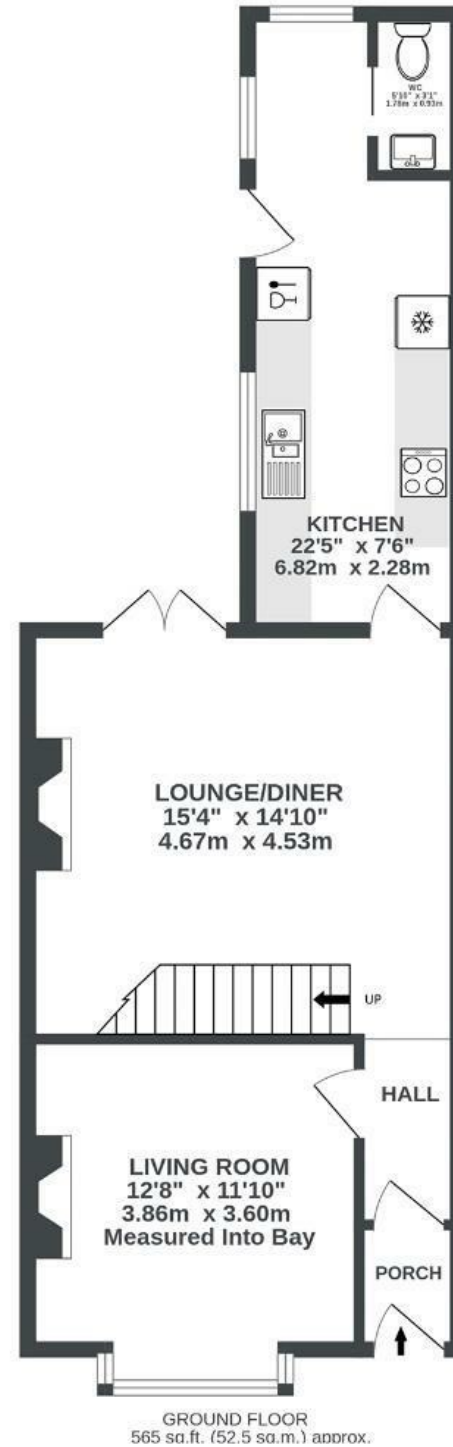

Illustrations are for reference purposes only, measurements are approximate, not to scale.

~~Boardwalk~~

Oak Road

, BRISTOL



£475,000



2 Bedrooms



Bristol, BS7
8R7



1 Bathrooms

"We love Oak Road! Horfield Common is just around the corner and is the best spot for walking, playing tennis and even a coffee and cake at the Ardagh. Our community is full of such friendly people, we will certainly miss it"

