

# Draycott Road

ASHLEY DOWN

APPROXIMATE FLOOR AREA  
92.4 SQM / 995 SQFT



GROUND FLOOR  
520 sq.ft. (48.3 sq.m.) approx.

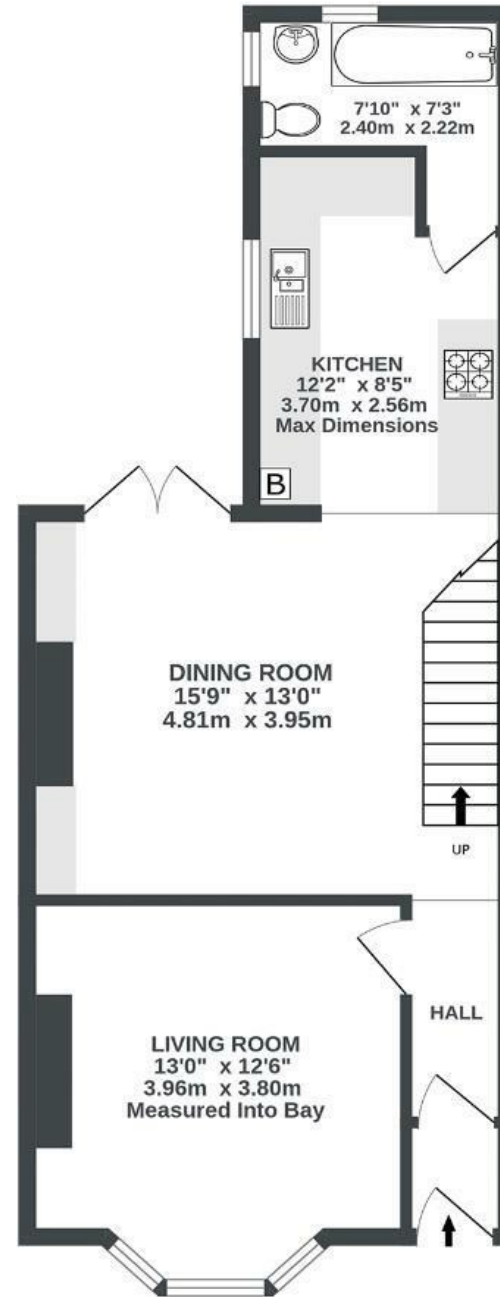

1ST FLOOR  
474 sq.ft. (44.1 sq.m.) approx.

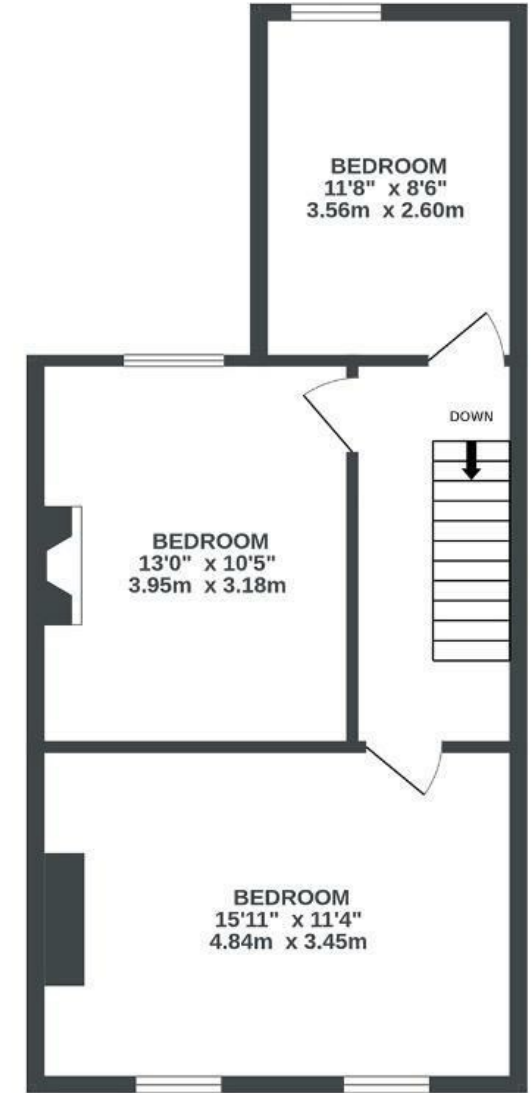

Illustrations are for reference purposes only, measurements are approximate, not to scale.

Boardwalk

# Draycott Road

HORFIELD, BRISTOL



£475,000



3 Bedrooms



Bristol, BS7

90Y



1 Bathrooms

*"Draycott Road has suited us wonderfully both as a young professional couple and more recently a family of four. The Lazy Dog is a great local serving top drinks, great food and being a hive of community spirit! Guild of Dough offers a top artisan bakery whilst the amazing independent bars, restaurants, cafes and shops on Gloucester Road are super close. For outings think Purdown, St Werburghs city farm, St Andrews Park and Horfield common. We hope you'll be as happy here as we have!"*

