

Longfield Road

ST ANDREWS

APPROXIMATE FLOOR AREA
141.4 SQM / 1522 SQFT

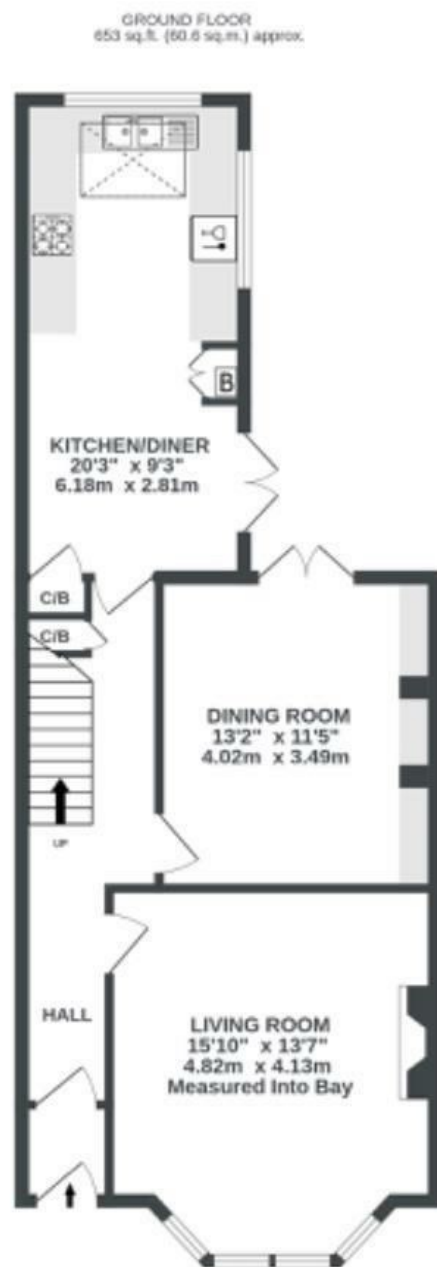

Illustrations are for reference purposes only, measurements are approximate, not to scale.

Boardwalk

Longfield Road , BRISTOL

£

£650,000

ZZ

4 Bedrooms



Bristol, BS7

9AG



2 Bathrooms

"I've lived on Longfield Road for over 30 years and have loved it there. It's a friendly, neighbourly road, just round the corner from beautiful St Andrew's Park, a well-used and lively urban green space. Everything you could possibly want is on the Gloucester Road, from independent shops to eateries, a lovely library and just about anything else you can imagine. The upper levels at the front of the house have fantastic views over Bristol – great for balloon-watching during the Fiesta!"

