

# Coronation Road

## SOUTHVILLE

APPROXIMATE FLOOR AREA  
167.6 SQM / 1805 SQFT



GROUND FLOOR  
797 sq.ft. (74.0 sq.m.) approx.

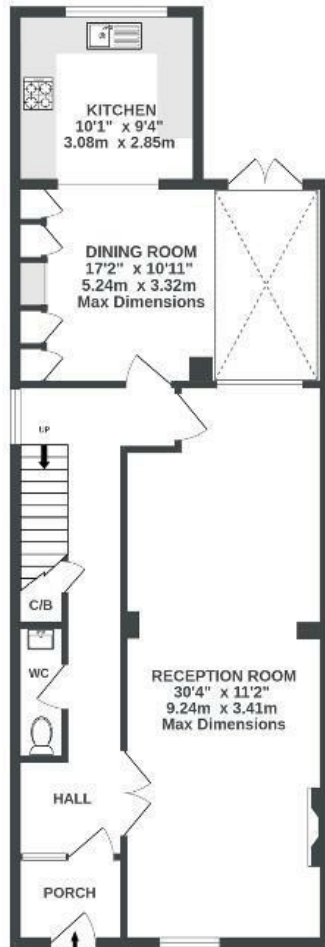

1ST FLOOR  
506 sq.ft. (47.0 sq.m.) approx.

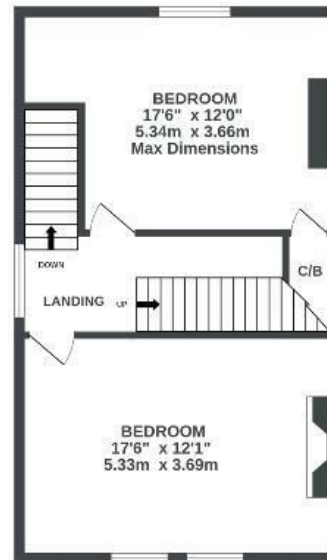

2ND FLOOR  
502 sq.ft. (46.6 sq.m.) approx.



Illustrations are for reference purposes only, measurements are approximate, not to scale.

**Boardwalk**

# Coronation Road

## SOUTHVILLE, BRISTOL

---

£

£625,000

zZz

4 Bedrooms



Bristol, BS3

1RO



2 Bathrooms

---

*We love our house because it has amazing natural light and is one of the largest houses we know of in Southville with four double rooms and views across the river towards Clifton and Hotwells.*

*It's been really useful for our family to be just a couple of minutes away from an Outstanding school, Ashton Gate Primary School. Sonny Stores and Soukitchen are amazing restaurants just a short walk away, and the Tobacco Factory and Bristol Beer Factory are also luckily just down the road.'*

