

# Larch Way PATCHWAY

APPROXIMATE FLOOR AREA  
82.3 SQM / 885 SQFT



GROUND FLOOR



FIRST FLOOR

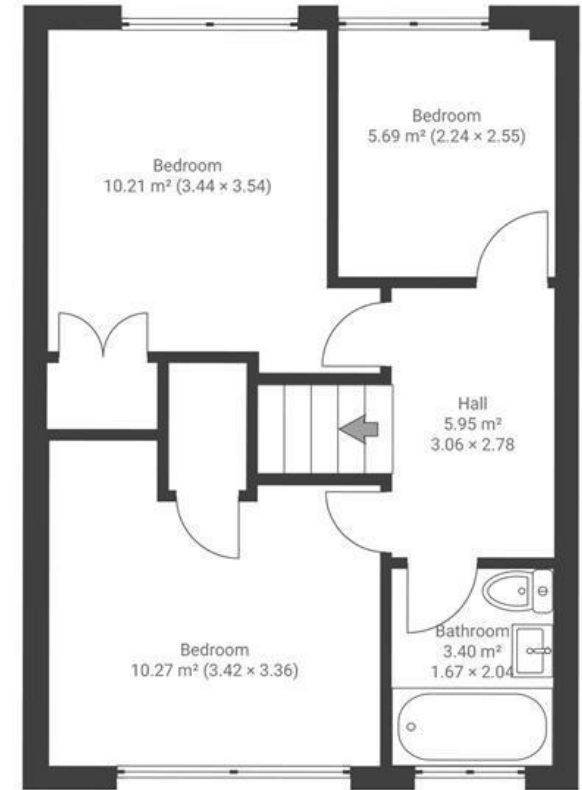

**Boardwalk**

# Larch Way

PATCHWAY, BRISTOL

---



£315,000



3 Bedrooms



Bristol, BS34  
5DI



2 Bathrooms

---

*"A quiet location with lovely neighbours and big gardens with full sun all year round. A cosy home with everything we needed while our 2 children lived at home and since they moved out. It is close to so many local facilities, doctors, vets and local shops, including The Mall, cinema, many restaurants and supermarket's. There are great local easy and regular bus routes."*

