

# Lawrence Avenue

## EASTON

APPROXIMATE FLOOR AREA  
100.8 SQM / 1085 SQFT

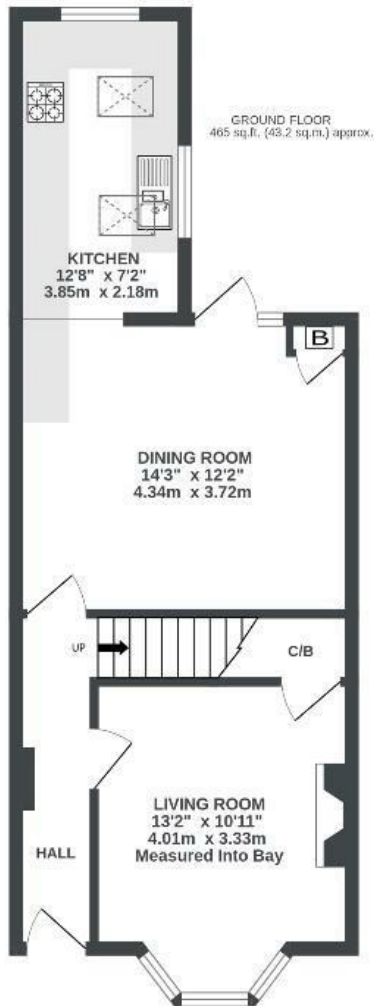

Illustrations are for reference purposes only, measurements are approximate, not to scale.

**Boardwalk**

# Lawrence

EASTON, BRISTOL

£

£400,000

z z z

3 Bedrooms



Bristol, BS5

OF



2 Bathrooms

*"We love the welcoming and cosy feel of our home on a quiet, friendly street. The large kitchen and dining room is perfect for hosting dinner parties and the ensuite loft bedroom has an amazing light and airy feel. We are spoilt for choice with the cafes, restaurants, and shops of vibrant St Marks Road less than a minute away. We will massively miss our time at Lawrence Avenue, and hope the next buyers enjoy it as much as we have".*

