

# Vicarage Road

## SOUTHVILLE

APPROXIMATE FLOOR AREA  
58.8 SQM / 632 SQFT



LOWER GROUND FLOOR

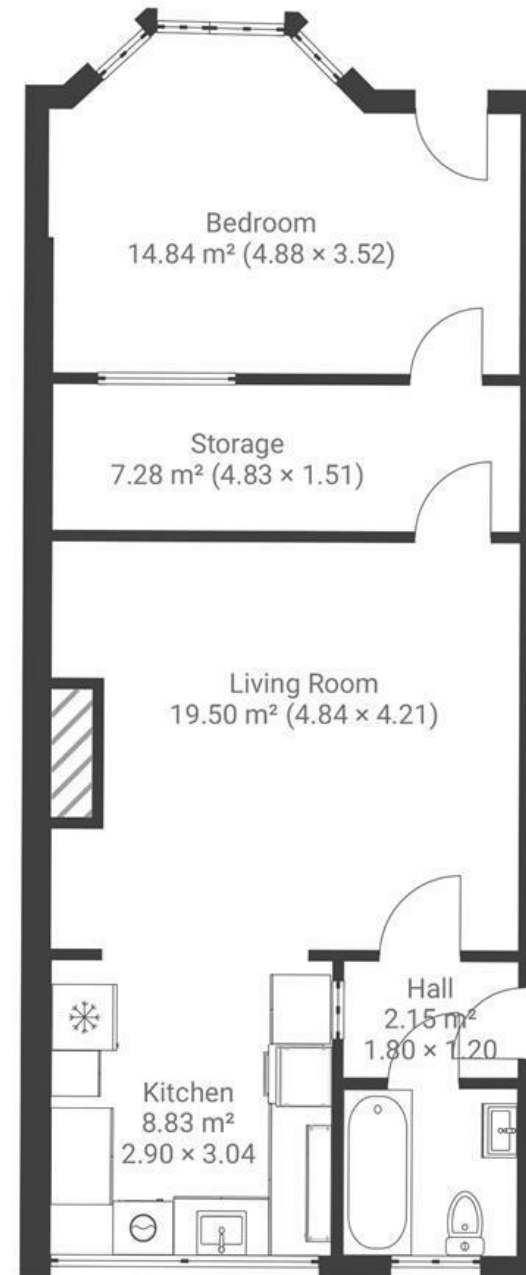

**Boardwalk**

# Vicarage Road

**SOUTHVILLE, BRISTOL**

£

£280,000

zZz

1 Bedrooms



Bristol, BS3

1PD



1 Bathrooms

*"I've loved living here with the independent shops and cafes of North Street on the doorstep, while also being able to escape the city to Ashton Court within minutes. Getting home after a long day and not having to drive around looking for a parking space is a bonus, as well as enjoying bridge views from the kitchen. I was drawn to the flat by how spacious it is for relaxing and hosting, as well as having loads of storage. I've been really happy here and will be sad to move away."*

