

Leighton Road

SOUTHVILLE

APPROXIMATE FLOOR AREA
163.9 SQM / 1764 SQFT



GROUND FLOOR
757 sq.ft. (70.3 sq.m.) approx.

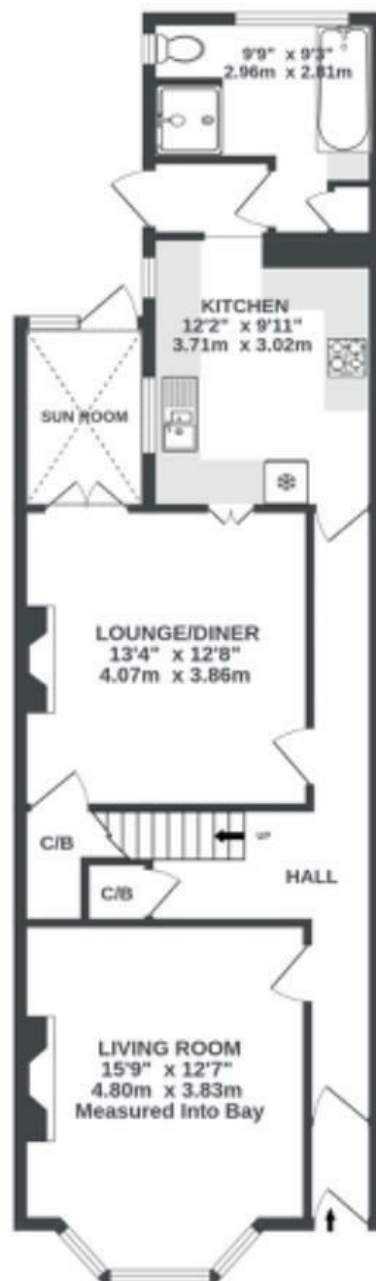

1ST FLOOR
704 sq.ft. (65.4 sq.m.) approx.



2ND FLOOR
303 sq.ft. (28.2 sq.m.) approx.

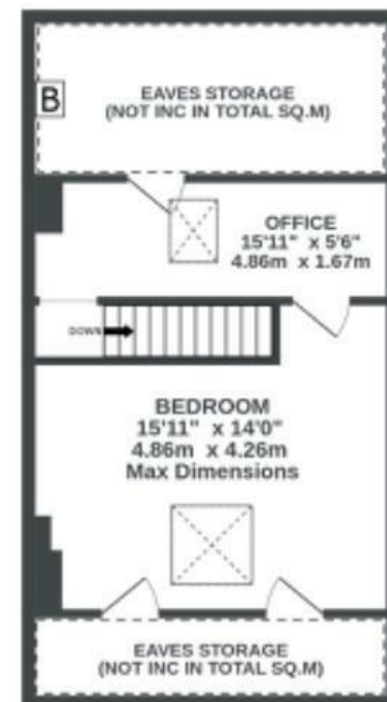

Illustrations are for reference purposes only, measurements are approximate, not to scale.

Boardwalk

Leighton Road

SOUTHVILLE, BRISTOL

£

£785,000



Bristol, BS3

1NS

zzz

4 Bedrooms



2 Bathrooms

"We've lived in Bristol for many, many years and it's been a privilege to live on Leighton Road. If we were not relocating this was going to be our forever home and we have loved and restored it as if it were. It's a very special house. I love sitting in the sun filled lounge or cosying up in the in the back reception room listening to records. We often do a 25 minute morning walk of dropping the kids to school in minutes, going onto Marks Bread for coffee, onto the harbourside and back home over Vauxhall bridge. Equally a morning coffee in the garden sunshine is amazing! A wonderful start to the day, what's not to love! The street has a wonderful community feel, with caring neighbours. It feels very safe and family friendly. Halloween and Christmas are particularly special with the window decorations. The city and countryside are both on our doorstep with Cycle lanes leading to Leigh Woods and Ashton Court."

