

Bromley Road

ASHLEY DOWN

APPROXIMATE FLOOR AREA
74.8 SQM / 805 SQFT



GROUND FLOOR
483 sq.ft. (44.8 sq.m.) approx.

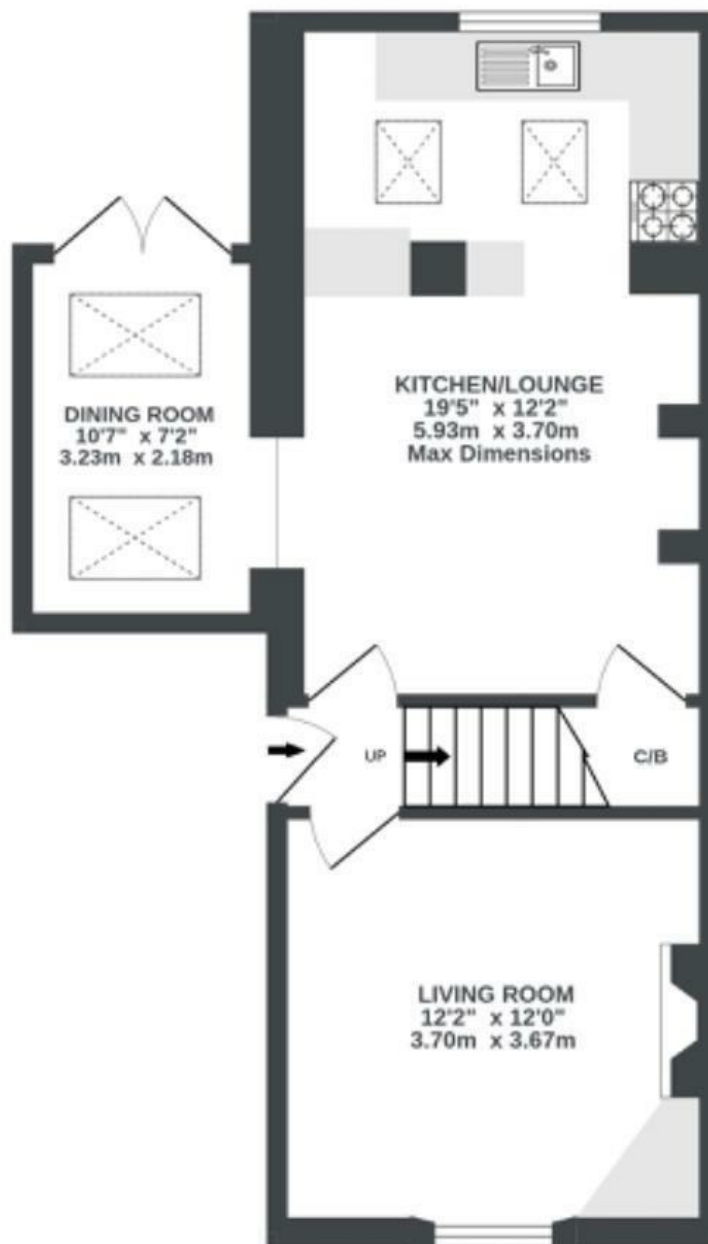

1ST FLOOR
323 sq.ft. (30.0 sq.m.) approx.



Illustrations are for reference purposes only, measurements are approximate, not to scale.

Boardwalk

Bromley Road , BRISTOL



£450,000



2 Bedrooms



Bristol, BS7



1 Bathrooms

91A

'We think Bromley Road has it all! A quiet, friendly street close to Gloucester Road, with all it's amazing bars, restaurants and independent shops, but also a range of beautiful nearby green spaces. A favourite activity includes walking along the cycle path to St Werburghs, picking up pizza and drinks from local breweries and sitting up on 'the mound' overlooking the city. At home we've enjoyed cosy nights by the fire and hosting bbqs in our sunny garden. We've made so many happy memories here.'

