

# Henry Street

## TOTTERDOWN

APPROXIMATE FLOOR AREA  
118.2 SQM / 1273 SQFT



BASEMENT FLOOR



GROUND FLOOR

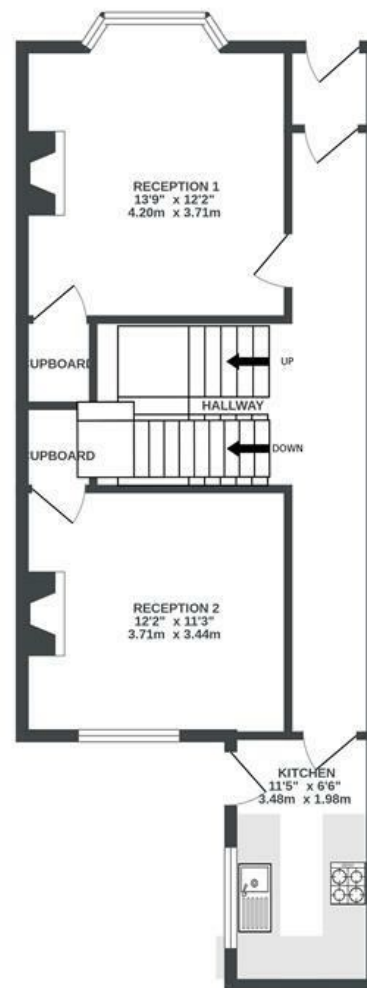

FIRST FLOOR

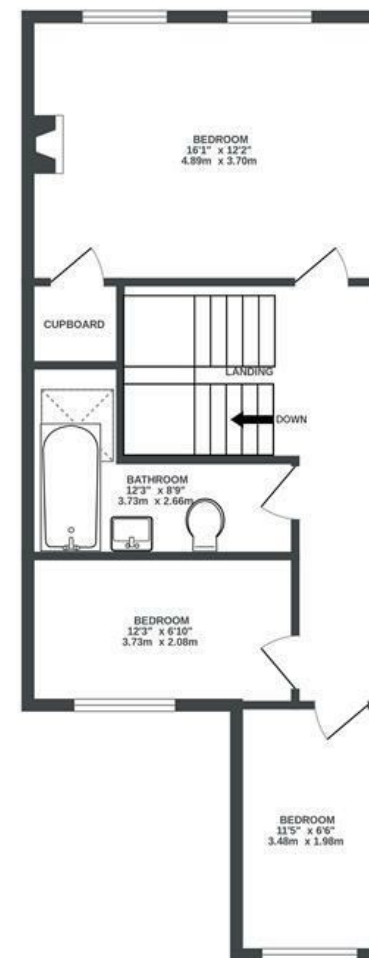

**Boardwalk**

# Henry Street

## TOTTERDOWN, BRISTOL

---

£

£435,000

zZz

3 Bedrooms



Bristol, BS3

4UID



1 Bathrooms

*"It has been a pleasure living in this vibrant, friendly neighbourhood. The location is amazing and we love being able to walk into the city centre, and then retreat back to the cosy, colourful comfort of Totterdown. Our little one has grown up here, spending countless hours playing in the incredible Victoria Park and chatting to the animals at Windmill Hill City Farm (the ducks are still her favourite). The nearby cluster of independent shops, pubs and restaurants is fantastic. There is always something going on; street parties, live music and all sorts of family fun giving the neighbourhood a lovely, warm, community feel. A highlight for us is the annual Front Room Arts Trail (Bristol's oldest). You can pop in and out of the colourful houses, be impressed by the creative talent of your neighbours, and have a wee snoop!"*

