

Baden Road

ST GEORGE

APPROXIMATE FLOOR AREA
86 SQM / 930 SQFT



GROUND FLOOR
480 sq.ft. (44.6 sq.m.) approx.

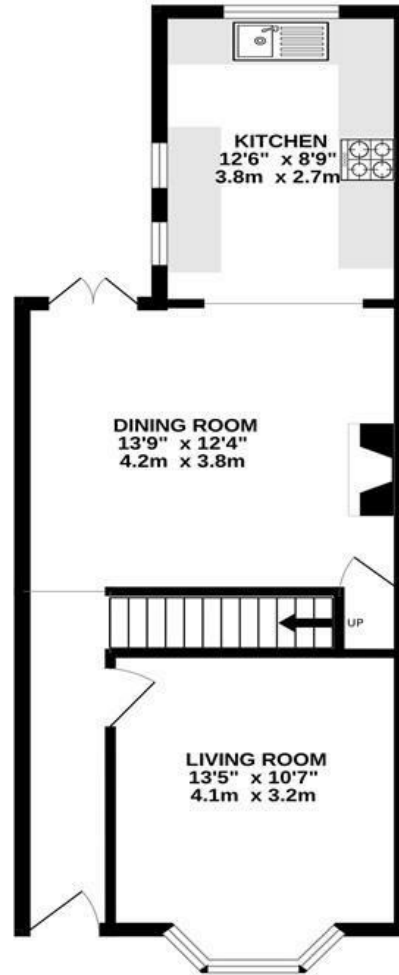

1ST FLOOR
450 sq.ft. (41.8 sq.m.) approx.



TOTAL FLOOR AREA : 930 sq.ft. (86.4 sq.m.) approx.

Whilst every attempt has been made to ensure the accuracy of the floorplan contained here, measurements of doors, windows, rooms and any other items are approximate and no responsibility is taken for any error, omission or mis-statement. This plan is for illustrative purposes only and should be used as such by any prospective purchaser. The services, systems and appliances shown have not been tested and no guarantee as to their operability or efficiency can be given.

Made with Metropix ©2024

Boardwalk

Baden Road

ST. GEORGE, BRISTOL



£395,000



2 Bedrooms



Bristol, BS5
90F



1 Bathrooms

"Our first house that we really have loved turning into a home. We've given it a lot of love over the 5 years we've been here and have created so many amazing memories. In that time we've also got to know St. George - making friends with neighbours, fellow dog walkers and many of the local cafe, bar and shop owners. The best bread, wine and fish and chips in Bristol are all within a 5-minute walk from the door, and there are green spaces everywhere!"

