

Gloucester Street

CLIFTON

APPROXIMATE FLOOR AREA
33.8 SQM / 364 SQFT



FIRST FLOOR
364 sq.ft. (33.8 sq.m.) approx.

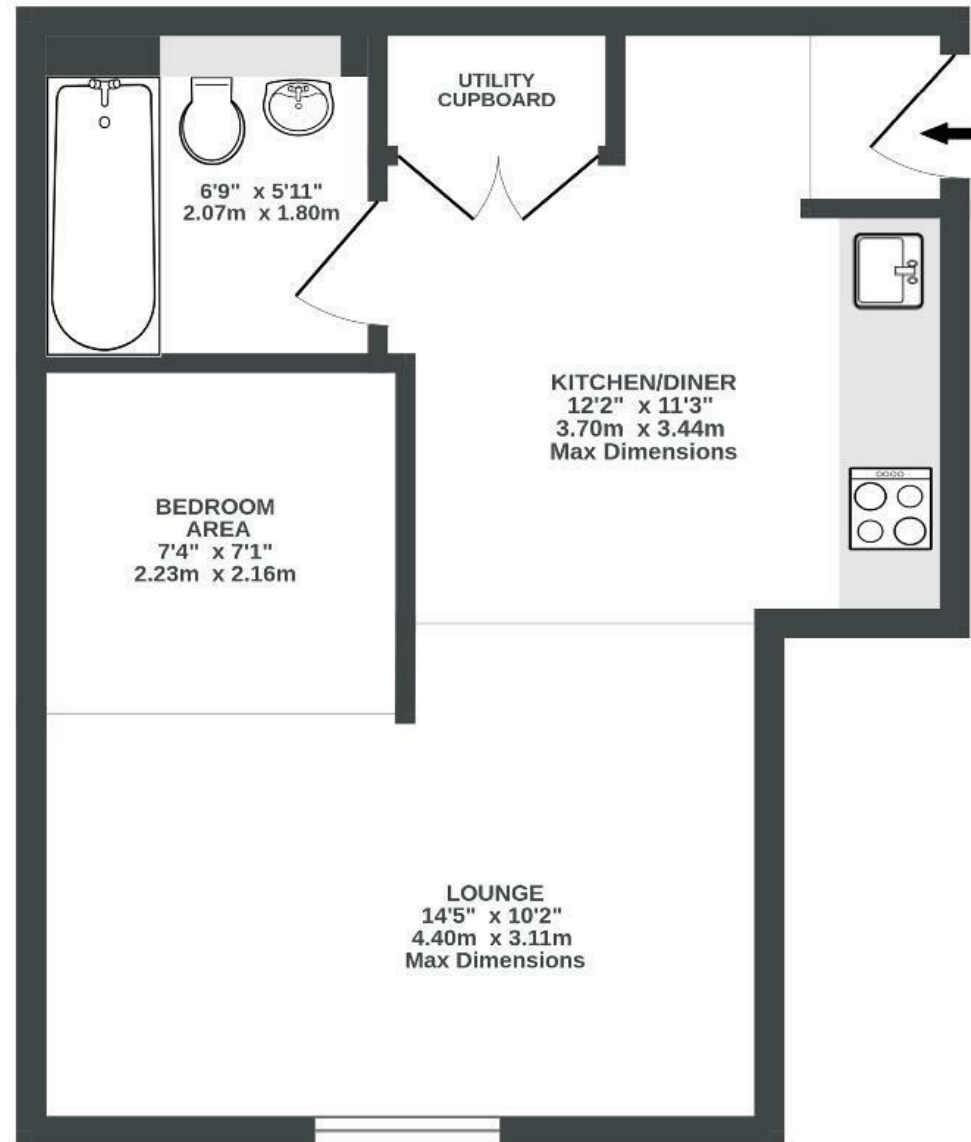

Illustrations are for reference purposes only, measurements are approximate, not to scale.

Boardwalk

Gloucester Street

CLIFTON, BRISTOL



£235,000



1 Bedrooms



Bristol, BS8



1 Bathrooms

4.1F

"Undeniably one of the best spots in Clifton, this flat has proved to be a great place to live. I love the fact you can step outside your front door and you have all the best shops, cafes and restaurants in Bristol, my favourite being Bar Chocolat which serves the best coffee. The downs is a short walk away and you can also take a visit to the Suspension Bridge within minutes."

