

Lime Road

SOUTHVILLE

APPROXIMATE FLOOR AREA
124.9 SQM / 1344 SQFT



GROUND FLOOR
552 sq.ft. (51.3 sq.m.) approx.

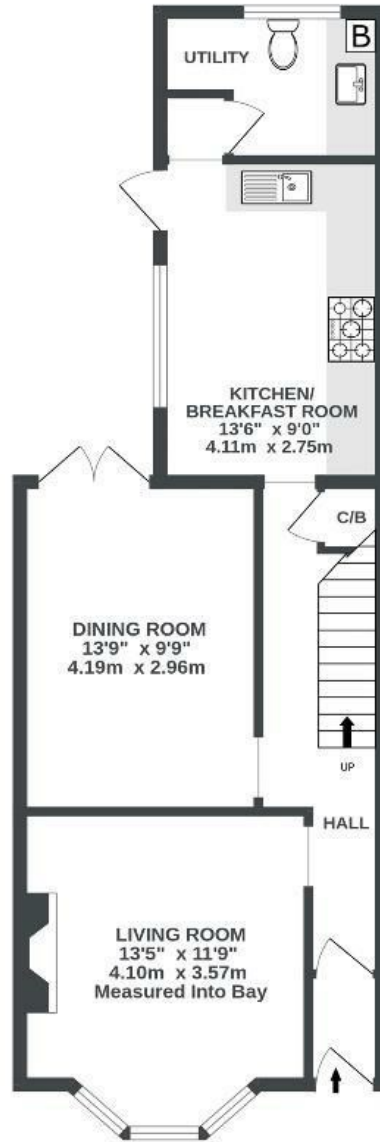

1ST FLOOR
527 sq.ft. (49.0 sq.m.) approx.

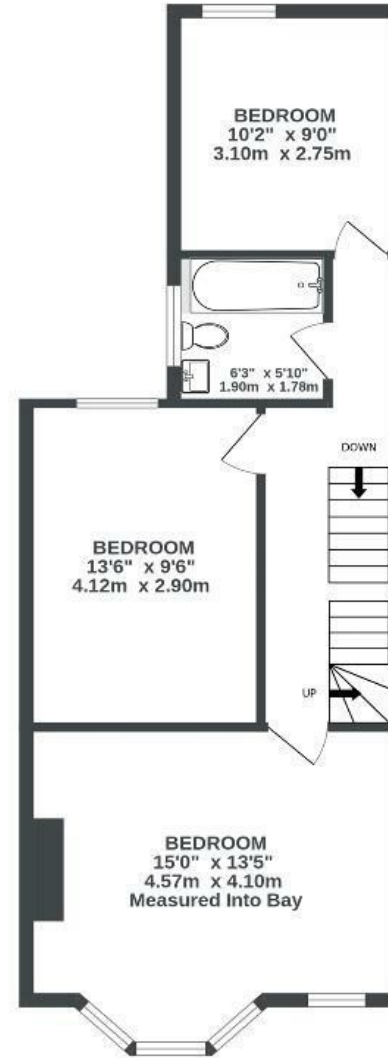

2ND FLOOR
265 sq.ft. (24.6 sq.m.) approx.

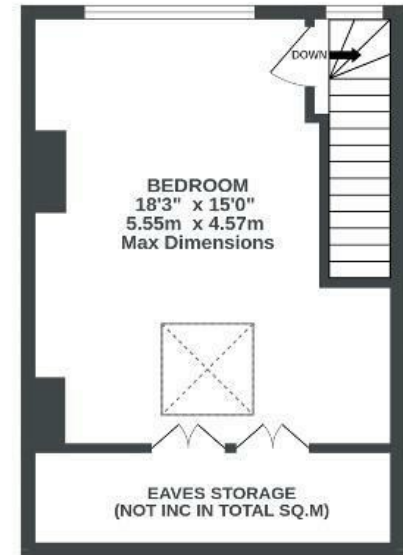

Illustrations are for reference purposes only, measurements are approximate, not to scale.

Boardwalk

Lime Road

SOUTHVILLE, BRISTOL



£625,000



4 Bedrooms



Bristol, BS3



1 Bathrooms

11 S

"We have loved living in Southville over the last few years because of its central location and community spirit. We are lucky that North Street is on our doorstep with so many great cafes, restaurants and pubs. We particularly love going to watch the rugby at Ashton Gate Stadium, popping for walks at Ashton Court or along the harbour, and heading out for dinner at some of our favourite restaurants like Cor and Souk Kitchen. It has been the perfect place for our first family home."

