

Hamilton Court

STOKES CROFT

APPROXIMATE FLOOR AREA
59.2 SQM / 637 SQFT



SECOND FLOOR
637 sq.ft. (59.2 sq.m.) approx.

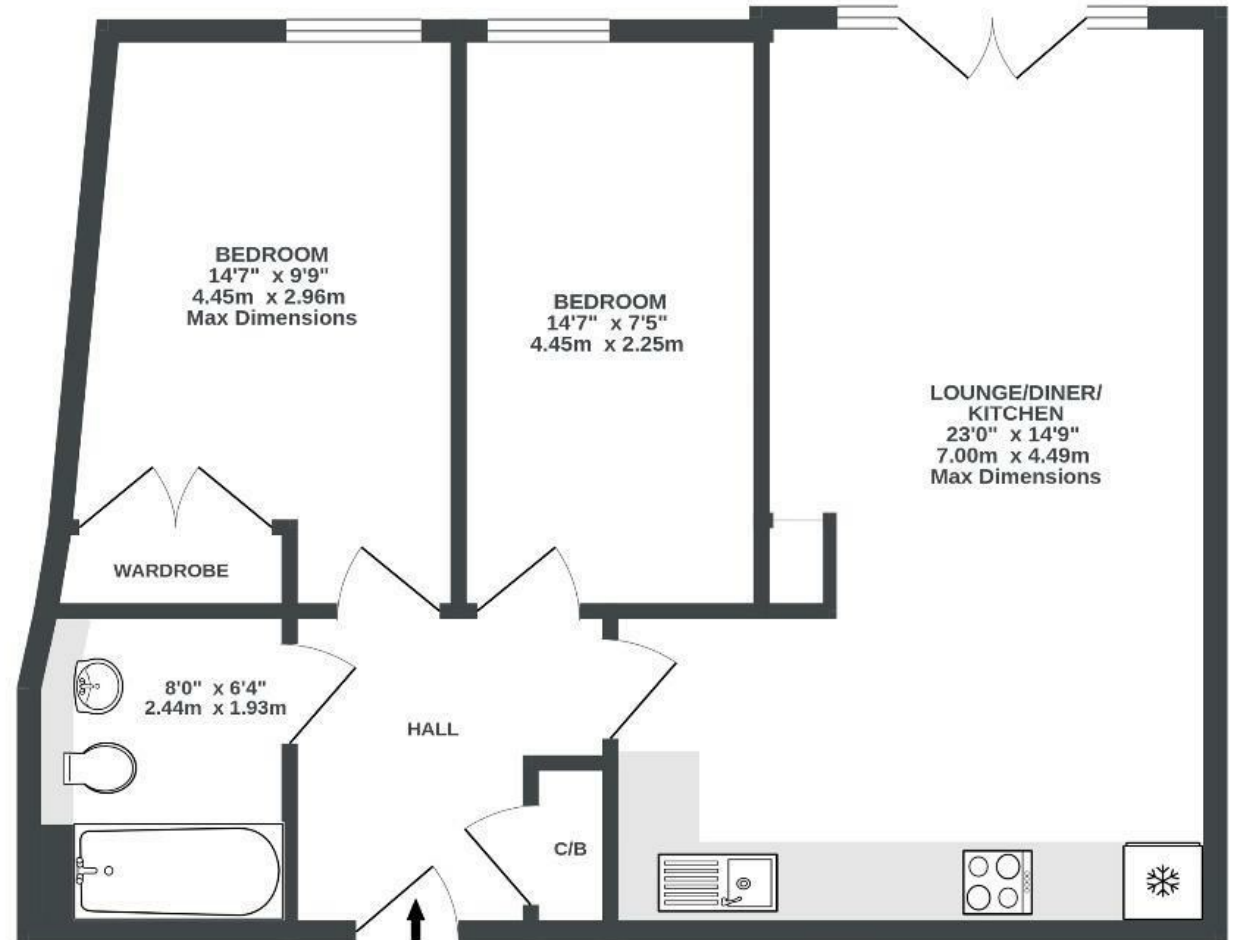

Illustrations are for reference purposes only, measurements are approximate, not to scale.

Boardwalk

Montague Street

STOKES CROFT, BRISTOL



£250,000



2 Bedrooms



BS2 8NY



1 Bathrooms

"The flat offers such a great location in a bustling part of Bristol. The flat is a stones throw from Cheltenham Road and is so accessible to more central areas such as the Clifton Triangle and Cabot Circus. Inside the flat is really light and perfect for young professionals!"

