

Berkeley Crescent

CLIFTON

APPROXIMATE FLOOR AREA
42.1 SQM / 453 SQFT



FIRST FLOOR
453 sq.ft. (42.1 sq.m.) approx.

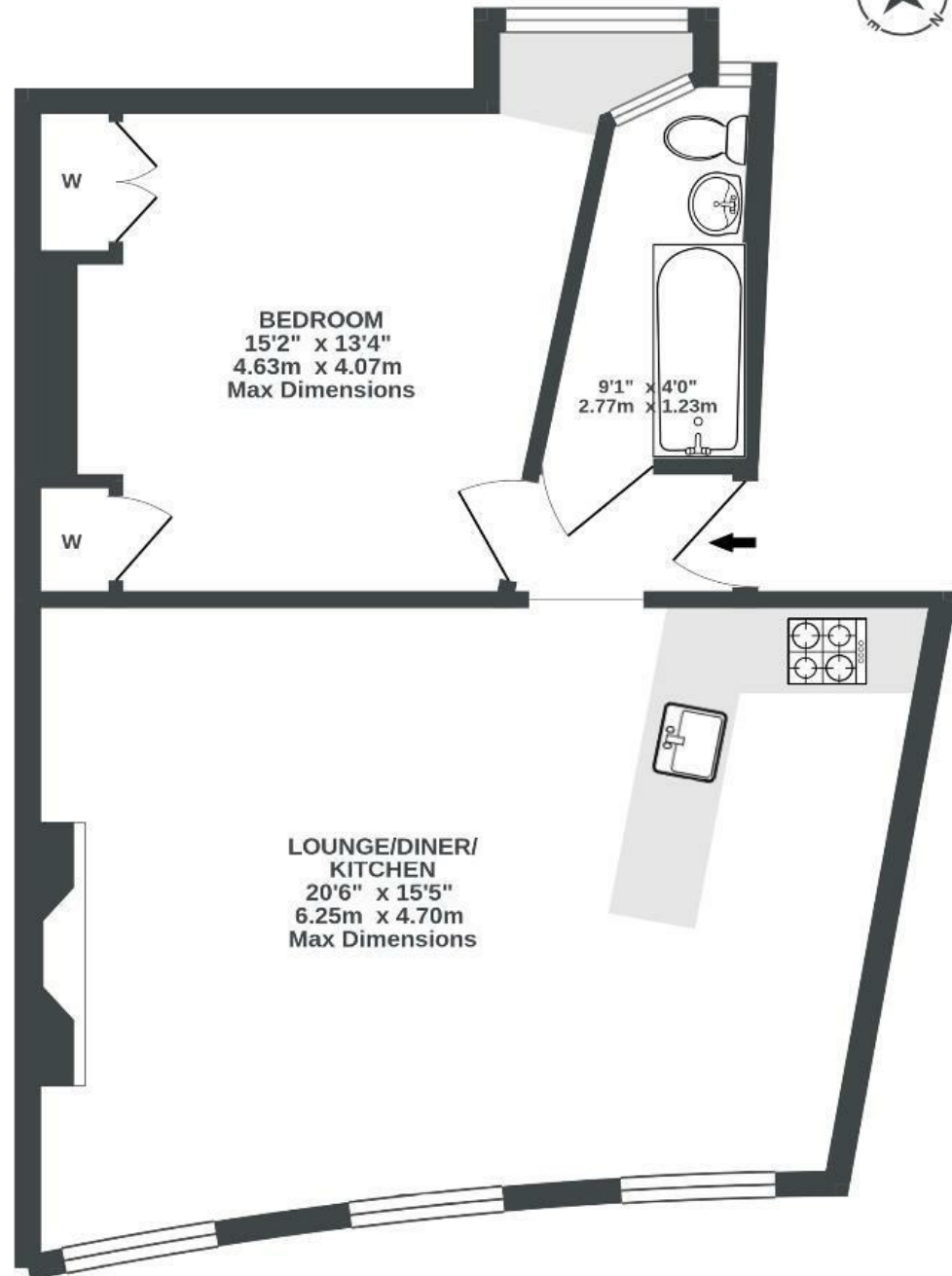

Illustrations are for reference purposes only, measurements are approximate, not to scale.

Boardwalk

Berkeley

CLIFTON, BRISTOL

£

£300,000

zZz

1 Bedrooms



Bristol, BS8

1HA



1 Bathrooms

"The history and charm of the building and the surrounding Berkeley Square, along with the location - right on the Clifton triangle - makes Berkeley Crescent pretty unbeatable. Within 100m of the flat there are gyms (Nuffield and Anytime Fitness), grocery stores (Waitrose and Sainsburys), bars (The Botanist, Lost and Found), specialty coffee shops (Pinkmans, Coffee Under Pressure) and even the Bristol Museum & Art Gallery. And of course the beautiful Brandon Hill for views of the city."

