

The Oxe Yard

YATTON

APPROXIMATE FLOOR AREA
143 SQM / 1539 SQFT



OUTBUILDING:
99 sq ft (9.17 m²) approx.



1ST FLOOR
624 sq ft (57.7 m²) approx.

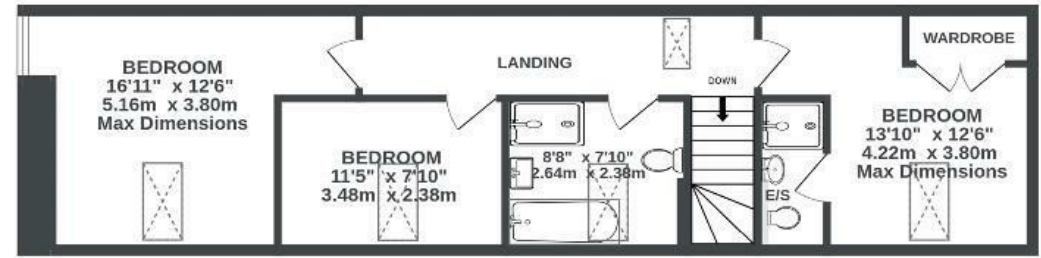

GROUND FLOOR
850 sq ft (77.9 m²) approx.

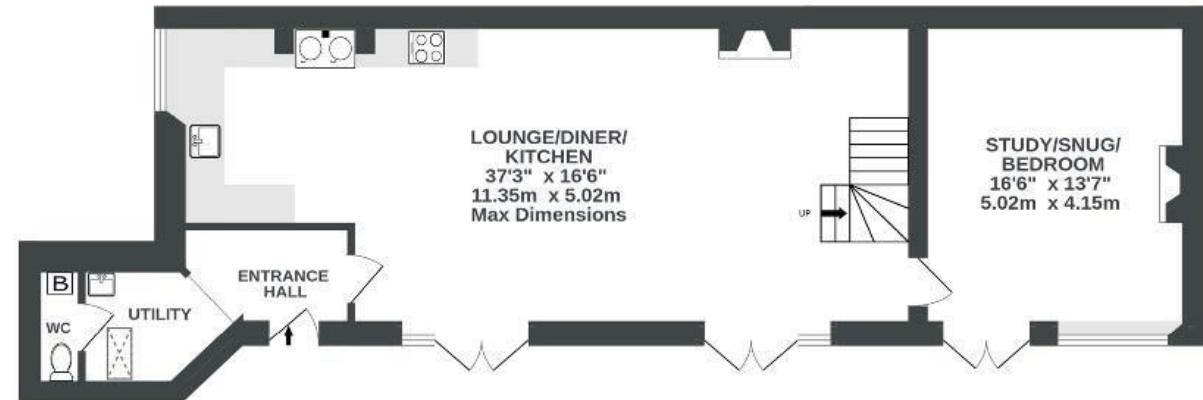

Illustrations are for reference purposes only, measurements are approximate, not to scale.

Boardwalk

North End Road

YATTON, BRISTOL



£699,950



3 Bedrooms



Bristol, BS49



3 Bathrooms

4 AS

"From an old barn to a home, a labour of love we've had the pleasure of calling home for 16 years.

We'll always have great memories of enjoying the gardens and the patio in the Summer, as well as the Aga and the log burner in the winter."

