

# Armidale Place

MONTPELIER

APPROXIMATE FLOOR AREA  
57.4 SQM / 618 SQFT



Ground Floor

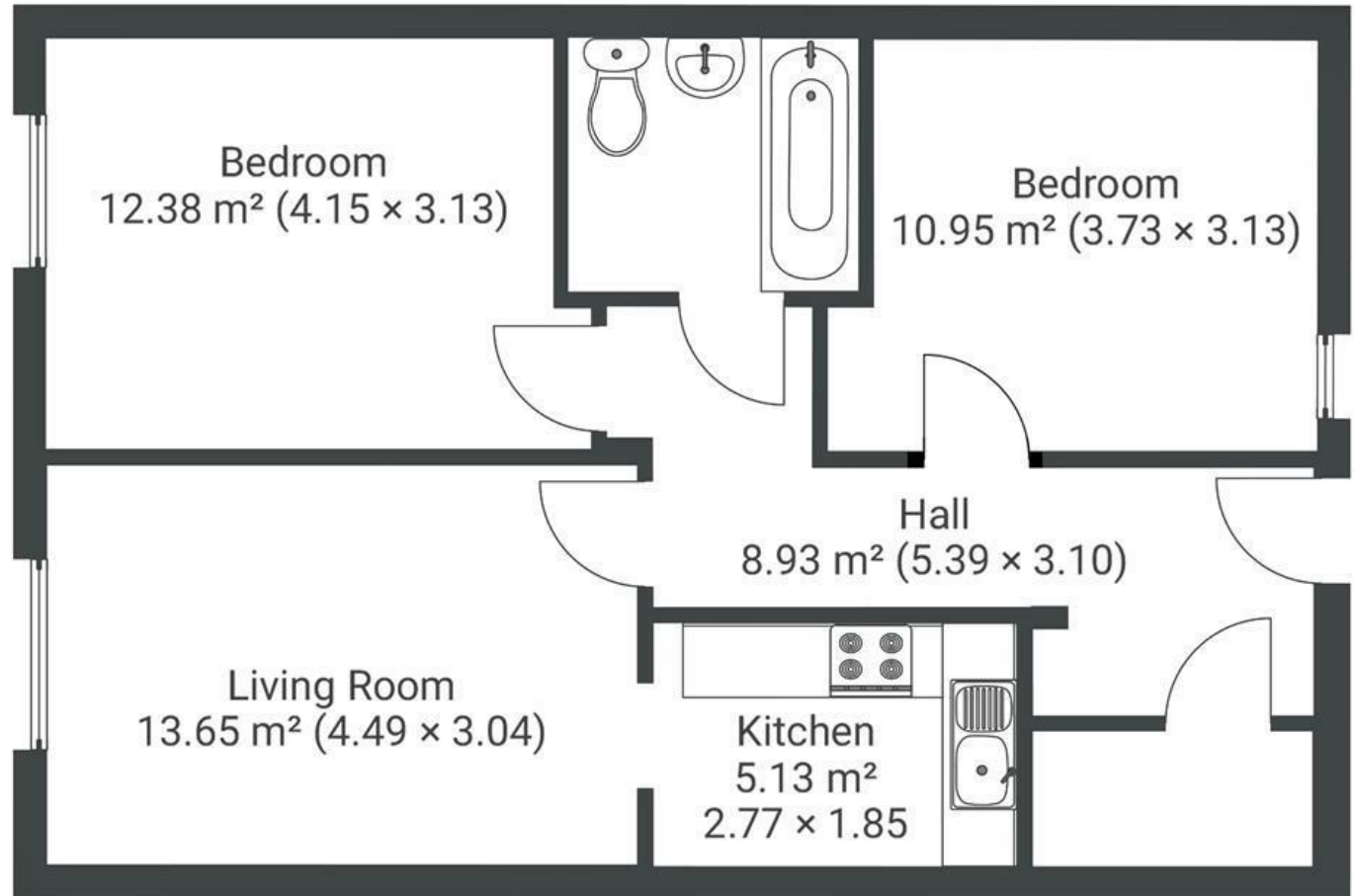

Boardwalk

# Armidale Place

, BRISTOL

£

£265,000

ZZZ

2 Bedrooms



Bristol, BS6  
5BQ



1 Bathrooms

*"Armidale Place has been the perfect mix of both stimulation and tranquillity. Montpelier is a fantastic location, just a 10-minute walk from the city centre, and there's so much to see, do, drink and eat! On summer days, I love popping to Boston Tea Party just next door and having breakfast outside, and a five-minute stroll away is The Cadbury, which has a very friendly vibe and yummy Sunday roasts. The view of the sun setting behind the beautiful Arley Chapel from my sofa will be a particularly fond memory."*

