



Perry Mead, Enfield

Under Offer (SSTC)

£425,000 (Freehold)





Nestled in the charming Perry Mead of Enfield, this mid-terrace house is a hidden gem waiting to be discovered. Boasting one reception room, three bedrooms with a lovely back garden.

Baker and Chase are delighted to present you this mid-terrace house located in the picturesque Perry Mead, Enfield. This property boasts a cosy reception room, alongside three bedrooms and a well-appointed bathroom, this property offers a comfortable living space for you to make your own.

This property is brimming with potential. Imagine the possibilities as you envision transforming this house into your dream home. It presents a fantastic opportunity for those looking to put their own stamp on a home.

The lounge area is a highlight with its double doors leading out to the garden, offering a seamless indoor-outdoor living experience. With three bedrooms, including two spacious double bedrooms, there is ample space for a growing family or those in need of a home office or guest room.

Step outside into the lovely garden, where you'll find a paved area ideal for al fresco dining, while the rest of the garden is beautifully laid to lawn, creating a peaceful retreat right at your doorstep. Additionally, a timber-built shed provides extra storage space for all your gardening tools and outdoor equipment.

Situated in a sought-after area, this property offers the ideal blend of suburban tranquility and urban convenience. Perry Mead is known for its friendly community atmosphere and proximity to local amenities, making it a desirable location for families and professionals alike.

Don't miss the opportunity to make this house your home. Whether you're looking to settle down or invest in a promising property, this mid-terrace house in Perry Mead is sure to exceed your expectations. Book a viewing today and discover the endless possibilities that this charming property has to offer.

Local Authority: Enfield
Tax Band: D

Front Garden

Paved area, access to tunnel-link, gas meter box.

Inner Hallway

Laminate wood flooring, stairs to first floor landing, radiator, door to kitchen, door to lounge.

Lounge

'Myson' heater, sliding double glazed door leading to rear garden, carpet.

Kitchen

Eye and base level units, radiator, double glazed window to front aspect, stainless steel sink with mixer tap, space for electric oven, space for washing machine, under stairs storage cupboard, access to lobby.

Lobby

Lino flooring, frosted window to rear aspect, wall mounted boiler, door leading to tunnel-link, door leading to rear garden.

First Floor Landing

Laminate wood flooring, loft access, double glazed window front aspect, doors to all bedrooms, door to bathroom, door to WC.

Bedroom 1

Double glazed window to rear aspect, radiator, laminate wood flooring, fitted cupboard.

Bedroom 2

Double glazed window to rear aspect, radiator, carpet.

Bedroom 3

Double glazed window to front aspect, radiator, fitted cupboard, laminate wood flooring.

Bathroom

Carpet, frosted double glazed window to front aspect, part-tiled walls, pedestal wash hand basin with mixer tap, panelled bath with mixer tap, electric shower.





BAKER
AND
CHASE

WC

Frosted double glazed window to front aspect, lino flooring, extractor fan, low level WC.

Rear Garden

Paved area, rest laid to lawn, timber-built shed.

Disclaimer

Consumer Protection from Unfair Trading Regulations 2008: The Agent has not tested any apparatus, equipment, fixtures and fittings or services and so cannot verify that they are in working order or fit for the purpose. A Buyer is advised to obtain verification from their Solicitor or Surveyor. References to the Tenure of a Property are based on information supplied by the Seller. The Agent has not had sight of the title documents. A Buyer is advised to obtain verification from their Solicitor.

Measurements: These approximate room sizes are only intended as general guidance. You must verify the dimensions carefully before ordering carpets or any built-in furniture.

Services: Please note we have not tested the services or any of the equipment or appliances in this property, accordingly we strongly advise prospective buyers to commission their own survey or service reports before finalising their offer to purchase.

Fixtures and fittings: Items shown in photographs are NOT included. A list of the fitted carpets, curtains, light fittings and other items fixed to the property which are included in the sale (or may be available by separate negotiation) will be provided by the Seller's Solicitors.

Particulars: These particulars are not an offer or contract, nor part of one. You should not rely on statements by Baker and Chase Ltd in the particulars or by word of mouth or in writing ("information") as being factually accurate about the property, its condition or its value. Neither Baker and Chase Ltd nor any joint agent has any authority to make any representations about the property, and accordingly any information given is entirely without responsibility on the part of the agents, seller(s) or lessor(s).







Media: (Photos, Videos etc)The photographs, property videos and virtual viewings etc. show only certain parts of the property as they appeared at the time they were taken.

Regulations etc: Any reference to alterations to, or use of, any part of the property does not mean that any necessary planning, building regulations or other consent has been obtained. A buyer or lessee must find out by inspection or in other ways that these matters have been properly dealt with and that all information is correct.

VAT: The VAT position relating to the property may change without notice

Copyright: You may download, store and use the material for your own personal use and research. You may not republish, retransmit, redistribute or otherwise make the material available to any party or make the same available on any website, online service or bulletin board of your own or of any other party or make the same available in hard copy or in any other media without the website owner's express prior written consent. The website owner's copyright must remain on all reproductions of material taken from this website.

Anti-Money Laundering Regulations: Intending parties will be asked to produce identification documentation at offer stage and we would ask for your co-operation in order that there will be no delay in agreeing the sale/rental.

Availability: Interested parties must check the availability of any property and make an appointment to view before embarking on any journey to see a property.

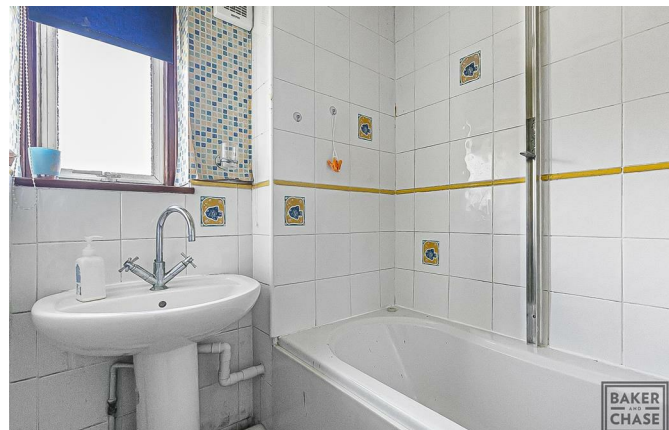



Approximate Gross Internal Area 824 sq ft – 76 sq m
Ground Floor Area 402 sq ft – 37 sq m
First Floor Area 422 sq ft – 39 sq m

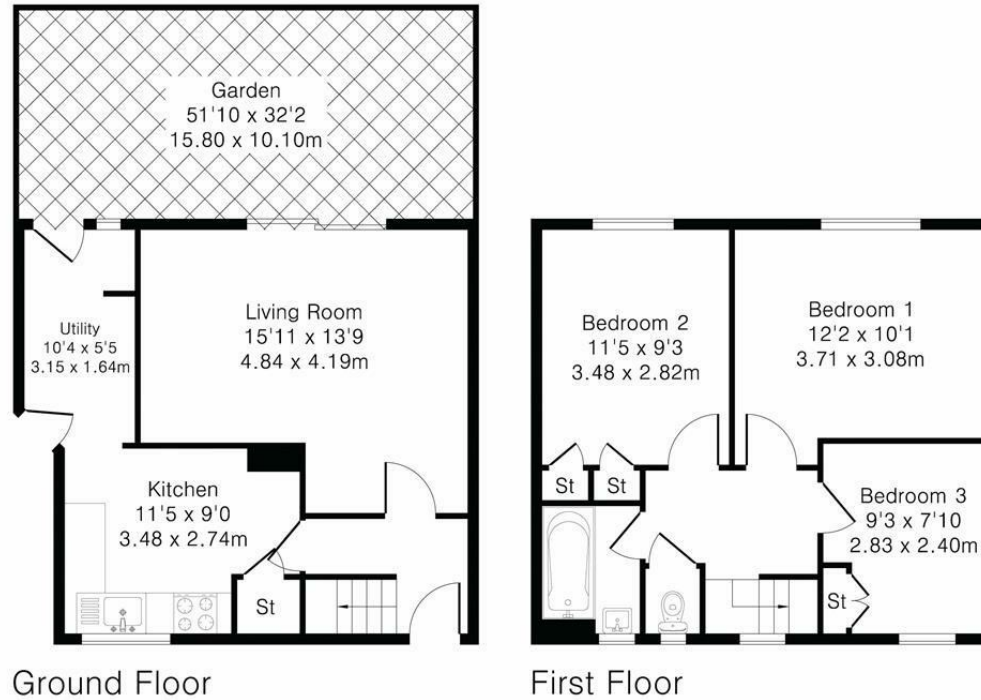

Although Pink Plan Ltd ensures the highest level of accuracy, measurements of doors, windows and rooms are approximate and no responsibility is taken for error, omission or misstatement. These plans are for representation purposes only as defined by RICS code of measuring practise. No guarantee is given on total square footage of the property within this plan. The figure icon is for initial guidance only and should not be relied on as a basis of valuation.



EPC Rating D / Local Authority: Enfield / Council Tax Band: D

