



REAL ESTATE
ESTATE AGENCY. REDEFINED.

Edgar Close

West Malling | ME19 4JE



Edgar Close Kings Hill, West Malling, ME19 4JE

£1,800 Per Calendar Month

CR REAL ESTATE ARE THRILLED TO PRESENT THIS EXCEPTIONAL AND RARELY AVAILABLE FAMILY HOME IN THE HEART OF KINGSHILL — A TRUE HIDDEN GEM THAT YOU WON'T WANT TO MISS!

PERFECTLY POSITIONED WITHIN WALKING DISTANCE OF AN OFSTED-RATED OUTSTANDING NURSERY AND PRIMARY SCHOOL,

- SPACIOUS THREE BEDROOM HOME IN KINGSHILL
- EPC RATING C
- COUNCIL TAX BAND E
- INTEGRAL GARAGE
- THREE BALCONIES
- NUSERY AND PRIMARY SCHOOL LOCALLY
- HOLDING DEPOSIT £415.00
- SECURITY DEPOSIT £2076.00
- AVAILABLE NOW
- PROPERTIES RARELY AVAILABLE TO LET IN THIS AREA

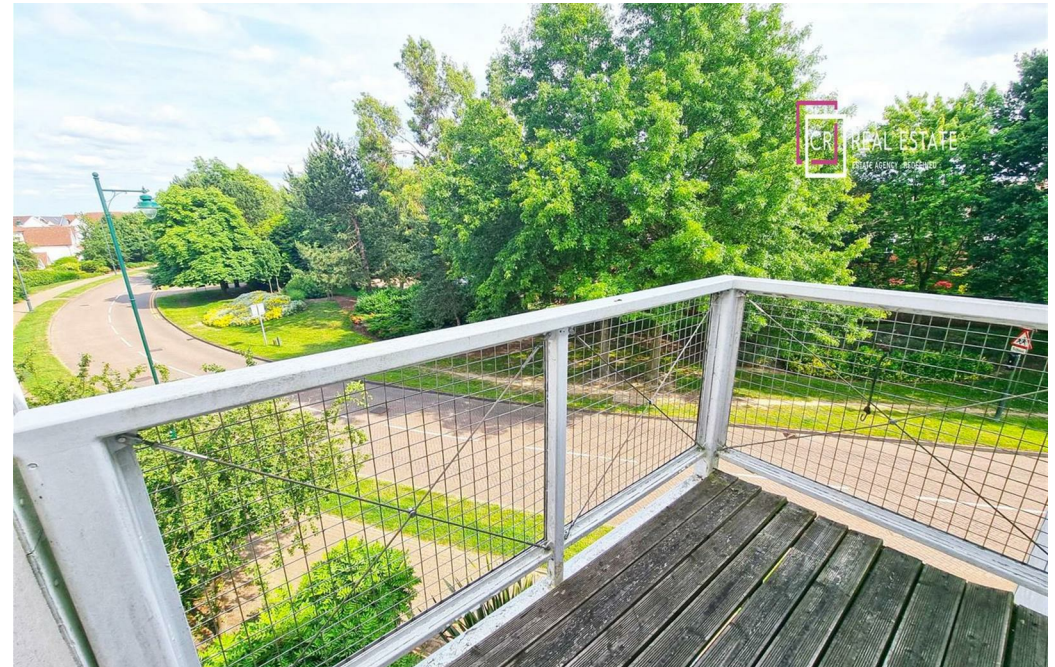

Ground Floor

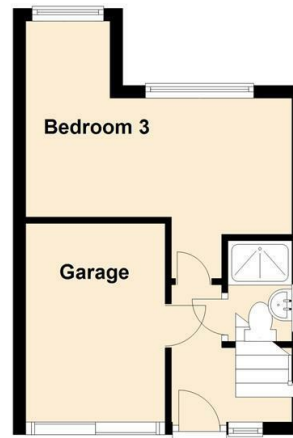

First Floor



Second Floor

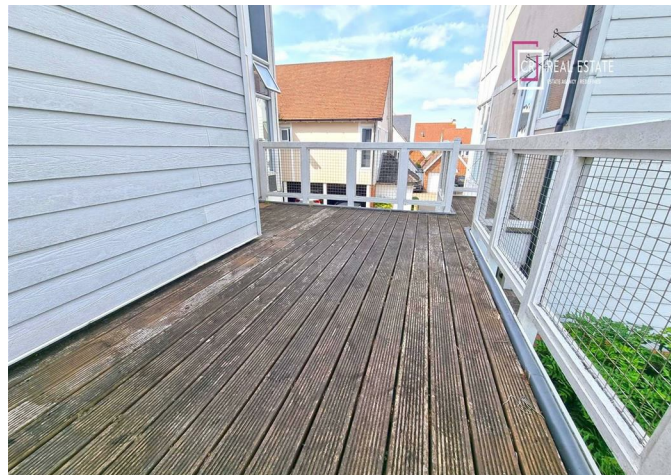



REAL ESTATE
ESTATE AGENCY : REDEFINED

18 - 20 High Street
Gillingham
Kent
ME7 1BB

01634 570057

www.crralestate.co.uk
twitter.com/CRRealEstateUK
facebook.com/CRRealEstateUK



rightmove
find your happy

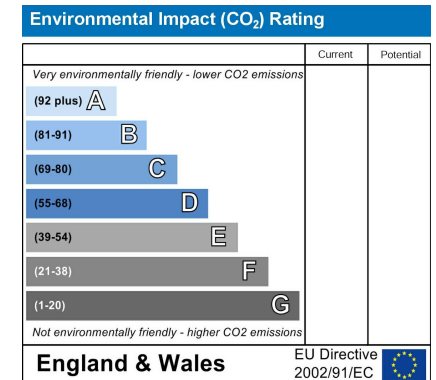
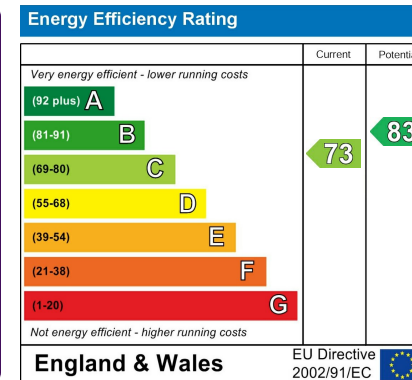

CR Real Estate endeavour to maintain accurate depictions of properties in Virtual Tours, Floor Plans and descriptions, however, these are intended only as a guide and purchasers must satisfy themselves by personal inspection.