



8 FAIRHEAD ROAD SOUTH
COLCHESTER, CO4 0BH

£1,300 PCM

Looking for off street parking with a great garden? Then look no further!



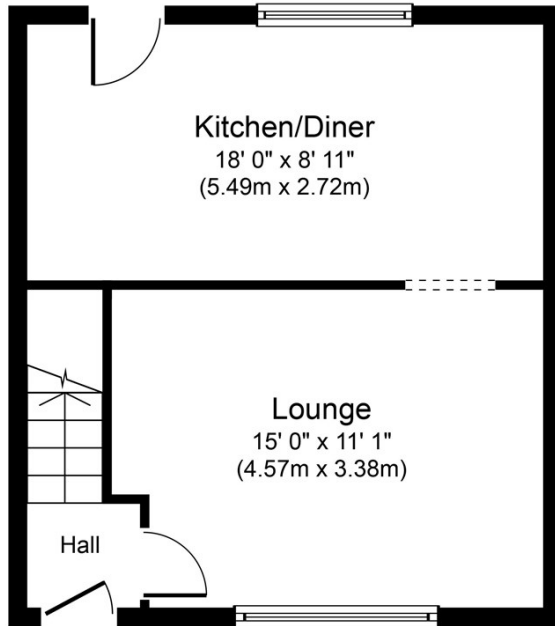

Ground Floor
Approximate Floor Area
366 sq. ft.
(34.0 sq. m.)

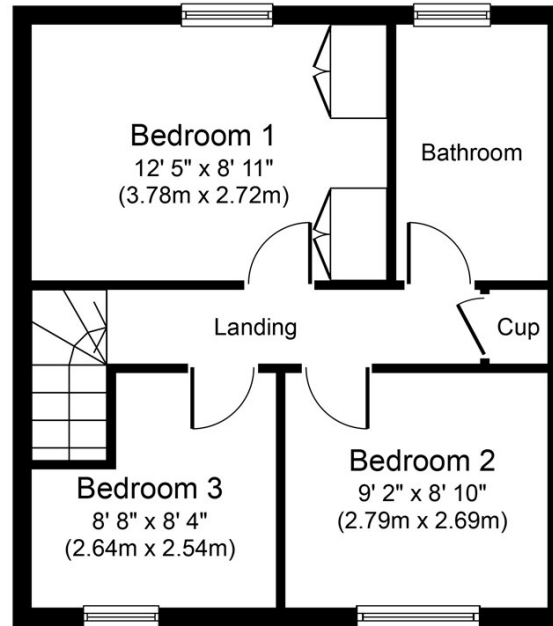

First Floor
Approximate Floor Area
366 sq. ft.
(34.0 sq. m.)

Whilst every attempt has been made to ensure the accuracy of the floor plan contained here, measurements of doors, windows, rooms and any other items are approximate and no responsibility is taken for any error, omission, or mis-statement. This plan is for illustrative purposes only and should be used as such by any prospective purchaser or tenant. The services, systems and appliances shown have not been tested and no guarantee as to their operability or efficiency can be given.
www.virtual360.net



Energy Efficiency Rating		Current	Potential
Very energy efficient - lower running costs			
(92 plus) A			
(81-91) B			
(69-80) C			
(55-68) D			
(39-54) E			
(21-38) F			
(1-20) G			
Not energy efficient - higher running costs			
England & Wales		EU Directive 2002/91/EC	

Agents Note: Whilst every care has been taken to prepare these particulars, they are for guidance purposes only. All measurements are approximate and are for general guidance purposes only and whilst every care has been taken to ensure their accuracy, they should not be relied upon and potential buyers/tenants are advised to recheck the measurements

The Personal Property Shop Ltd
Lettings
Brook Farm, Braintree Road
Wethersfield
Braintree
Essex
CM7 4BX

01279 940840
info@thepersonalpropertyshop.co.uk
<https://personalpropertyshop.co.uk/>

