



**GILSON GRAY**

LAW • PROPERTY • FINANCE

**59 EILDON STREET**

Inverleith, Edinburgh, EH3 5JX



Benefiting from garage parking and delightful south-facing gardens, this two-bedroom lower villa is quietly situated in sought-after Inverleith, enviably close to the Water of Leith and several public parks. The inviting home includes excellent storage, an airy shower room, and a wonderfully bright reception room and adjoining kitchen - both with garden access.

Extras: All fitted floor and window coverings and light fittings will be included in the sale.

## FEATURES

- Lower villa with a quiet leafy address
- Bright entrance porch and hall with storage
- Dual-aspect living/dining room with storage and garden access
- Bright kitchen with garden access
- Two bedrooms with storage (one double and one single)
- Airy shower room
- South-facing mature gardens to the front and side
- Detached single garage
- Resident permit parking or meter parking
- Gas central heating and double-glazing







"THE DELIGHTFUL CITY HOME AND ITS LEAFY SETTING WILL APPEAL TO PROFESSIONALS, YOUNG FAMILIES, AND DOWNSIZERS."





EPC RATING:



COUNCIL TAX BAND:



VIEWINGS: by appointment with Gilson Gray on 0131 516 5366

### Garage

Approx. 19.0 sq. metres (204.5 sq. feet)

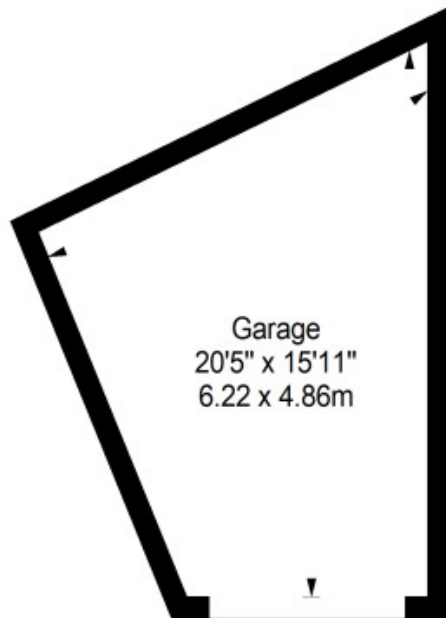

### Ground Floor

Approx. 76.3 sq. metres (821.3 sq. feet)

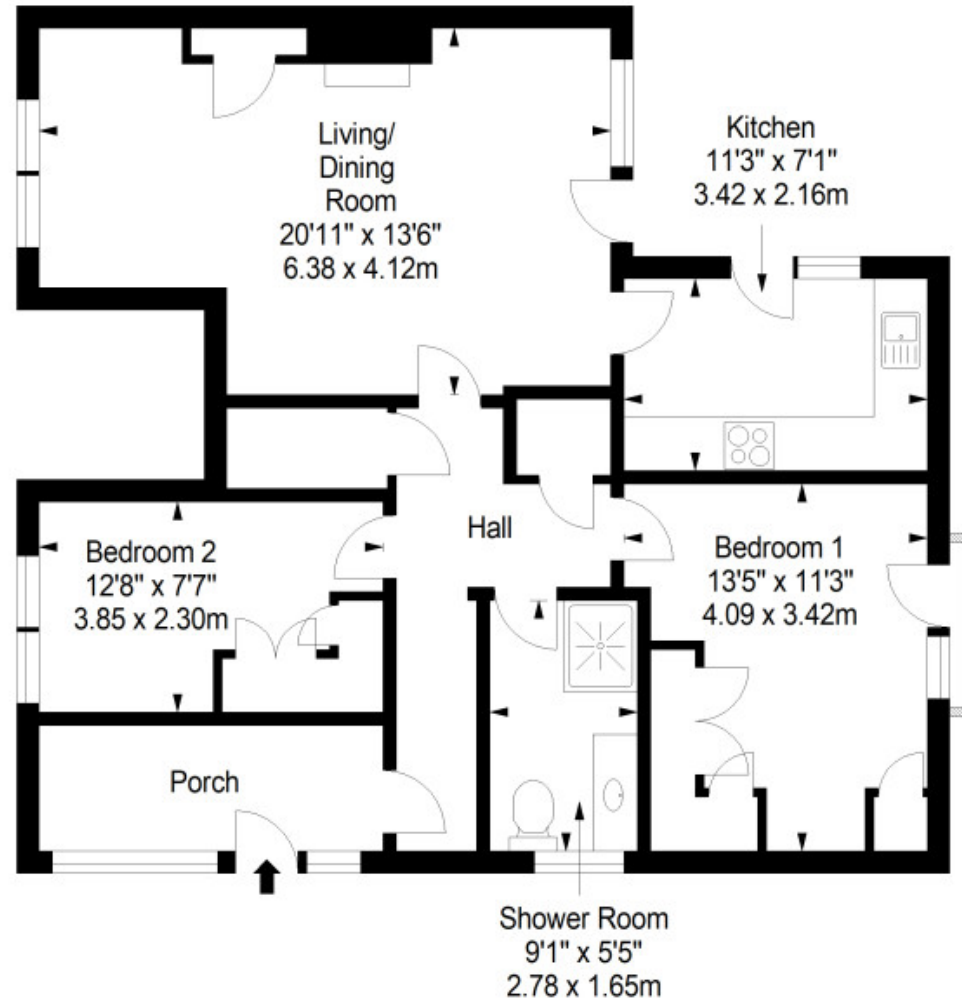

Total area: approx. 95.3 sq. metres (1025.8 sq. feet)



GILSONGRAY.CO.UK

## EDINBURGH

29 Rutland Square  
EH1 2BW  
0131 516 5366



## GLASGOW

160 West George Street  
G2 2HQ  
0141 530 2021



## EAST LOTHIAN

33 Westgate  
EH39 4AG  
01620 893 481



## DUNDEE

2 West Marketgait  
DD1 1QN  
01382 201 000



## BORDERS

01890 880 008



@gilsongrayprop



gilson gray property



gilson gray property



@gilsongrayprop



These particulars were prepared on the basis of our own knowledge of the local area and, in respect of the property itself, information supplied to us by our clients; all reasonable steps were taken at the time of preparing these particulars to ensure that all details contained in them were accurate. All statements contained in the particulars are for information only and all parties should not rely upon them as statements or representations of fact. In particular, (a) descriptions, measurements and dimensions, which may be quoted in these particulars are approximate only and (b) all references to conditions, planning permission, services, usage, constructions, fixtures and fittings and movable items contained in the property are for guidance only. Our clients may instruct us to set a closing date for offers at short notice and therefore if you wish to pursue interest in this property, you should immediately instruct your solicitor to note interest with us. Our clients reserve the right to conclude a bargain for the sale of the above subjects or any part thereof ahead of a notified closing date and will not be obliged to accept either the highest or indeed any offer for the above subjects or any part thereof. All measurements have been taken using a sonic tape and cannot be regarded as guaranteed given the limitations of the device. Services and/or appliances referred to in these particulars have not been tested and no warranty is given that they are in full working order.