



**£220,000**

128 Queensway Burton Latimer NN15 5QJ



**Carter Williams**  
Estate and Letting Agents





Welcomed to the market with no onward chain is this charming two bedroomed semi-detached bungalow in the sought-after town of Burton Latimer.

Stepping inside the property, you are initially greeted by a generously sized entrance hallway which provides access to the internal accommodation.

Benefiting from views over the front aspect, the spacious living room provides ample space for sitting and dining furniture alike. The fitted kitchen comprises of base and eye-level fitted storage, plumbing for white goods, sink with mixer tap and a sizeable window to front helps to fill the space with natural light. From the main reception space, an inner hallway provides access to the remaining accommodation. Here you will find the double sized master bedroom, three piece family bathroom and further good sized second bedroom which is currently used as a second reception space. Externally, a well manicured, generously sized rear garden provides an idyllic setting for dining al-fresco with patio area, lawn, gated side access to garage and driveway and a storage shed to the foot of the plot also offered. To the front aspect, a block paved driveway offers parking for multiple vehicles and leads to the single garage.



Situated only a short distance from local amenities, this practical bungalow presents a fantastic opportunity for versatile living and is available for one buyer to call home. Carter Williams highly recommend viewing this property to truly appreciate everything it has to offer- contact us today!

Council Tax Band: B  
EPC Rating: To Follow







Living Room 3.08m (10' 1") x 4.80m (15' 9")

Kitchen 2.56m (8' 5") x 2.29m (7' 6")

Entrance Hall 2.33m (7' 8") x 1.77m (5' 10")

Bedroom 4.26m (14' 0") x 2.66m (8' 9")

Bedroom 3.31m (10' 10") x 2.73m (8' 11")

Bathroom 1.77m (5' 10") x 1.69m (5' 7")





GROUND FLOOR  
524 sq.ft. (48.7 sq.m.) approx.

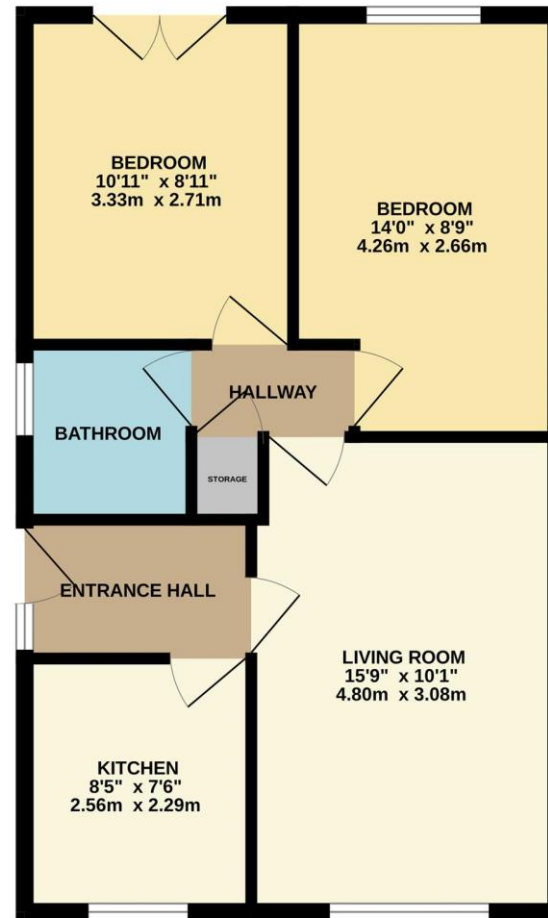

TOTAL FLOOR AREA : 524 sq.ft. (48.7 sq.m.) approx.

Whilst every attempt has been made to ensure the accuracy of the floorplan contained here, measurements of doors, windows, rooms and any other items are approximate and no responsibility is taken for any error, omission or mis-statement. This plan is for illustrative purposes only and should be used as such by any prospective purchaser. The services, systems and appliances shown have not been tested and no guarantee as to their operability or efficiency can be given.  
Made with Metropix ©2025



# Selling your property?

Get in touch to arrange your  
FREE market appraisal!

- Honest, friendly advice from a hardworking dedicated team
- Regular market updates
- Professional photography
- Floorplans
- Advertising on major property portals
- Exposure on social media
- Excellent local knowledge
- Mortgage advice
- In-house energy performance assessor
- Fantastic customer service

Find out why so many people trust  
Carter Williams with their property needs!



60 High Street  
Burton Latimer  
NN15 5LB  
01536 723561  
[info@carter-williams.co.uk](mailto:info@carter-williams.co.uk)  
[www.carter-williams.co.uk](http://www.carter-williams.co.uk)

