



The Tower  
One St George Wharf

  
**PRIME LONDON**  
[www.PrimeLondonResidential.com](http://www.PrimeLondonResidential.com)



[www.PrimeLondonResidential.com](http://www.PrimeLondonResidential.com)

An elite apartment with an astounding panorama of London, bespoke designed and with extensive lateral space totalling some 3,360 sq ft (315.12 sqm).

The apartment benefits from exquisite finishes and integrated media and room comfort controls, and commences with a beautifully lit entrance, leading to the reception room and expansive separate eat in kitchen/dining room.

The master bedroom incorporates a walk-in dressing area and en suite (bath and shower), and two further bedrooms add an en suite, further shower room and extensive integrated storage.

Amenities at The Tower include front door concierge service with valet parking, first floor gym, pool and sauna facilities as well as a private cinema.

St George Wharf offers on site riverside bars and restaurants such as Waterfront London, The Riverside, Four Degree and Pop Art Sushi. For additional convenience other on site outlets include Tesco Express, Pret a Manger, Hudson's Dry Cleaners, Riverside Medical Centre, Dental Spa and more.

- Elite apartment
- Astounding panorama
- Extensive lateral space
- 3,360 sq ft (315.12 sqm)
- Integrated media
- Concierge service with valet parking
- Gym, pool and sauna facilities
- On site riverside bars and restaurants









**THE TOWER, ONE ST GEORGE WHARF, LONDON SW8**  
**APPROXIMATE GROSS INTERNAL AREA**  
**3,360 SQ FT / 312.15 SQM**

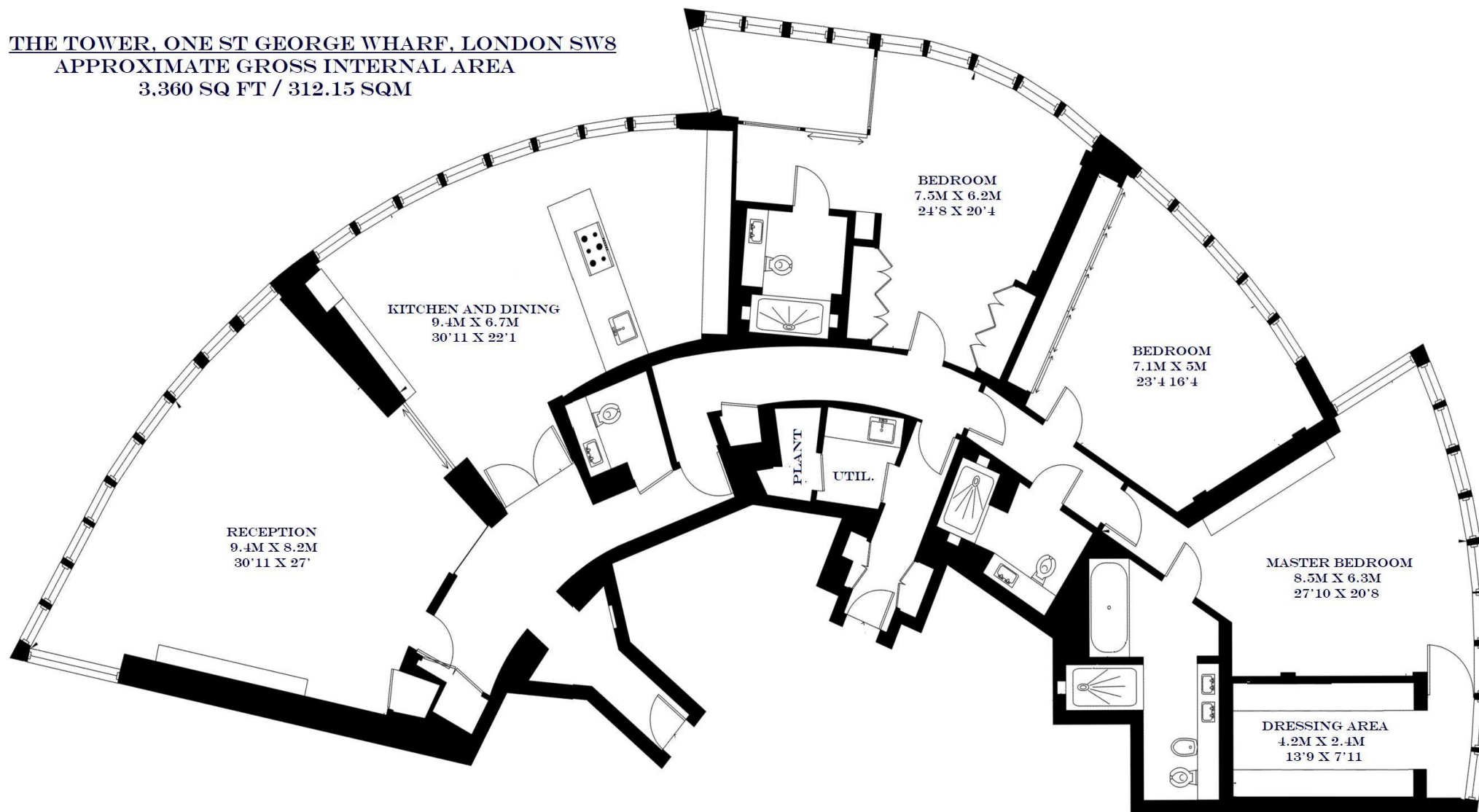

📍 Palace View, 131 Lambeth Road, London SE1 7JN  
☎ 020 7928 6663  
✉ [office@PrimeLondonResidential.com](mailto:office@PrimeLondonResidential.com)  
[www.PrimeLondonResidential.com](http://www.PrimeLondonResidential.com)

IMPORTANT: we would like to inform prospective purchasers that these sales particulars have been prepared as a general guide only. A detailed survey has not been carried out, nor the services, appliances and fittings tested. Room sizes should not be relied upon for furnishing purposes and are approximate. If floor plans are included, they are for guidance only and illustration purposes only and may not be to scale. If there are any important matters likely to affect your decision to buy, please contact us before viewing the property.



  
**PRIME LONDON**