

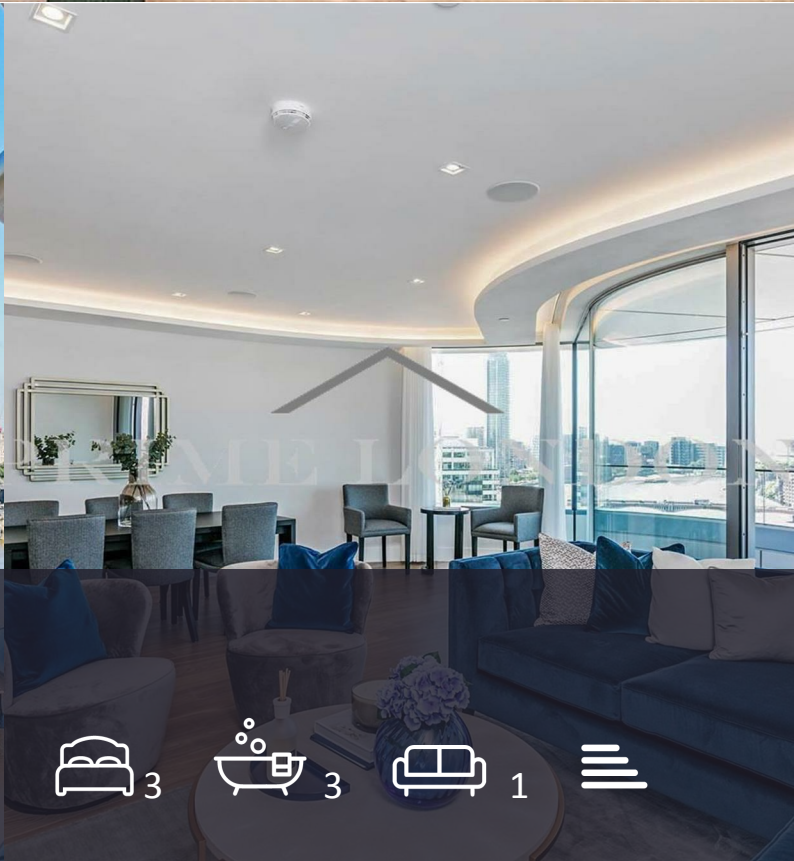

The Corniche

23 Albert Embankment, SE1 7GG

Asking Price £2,700,000



Floor Plan

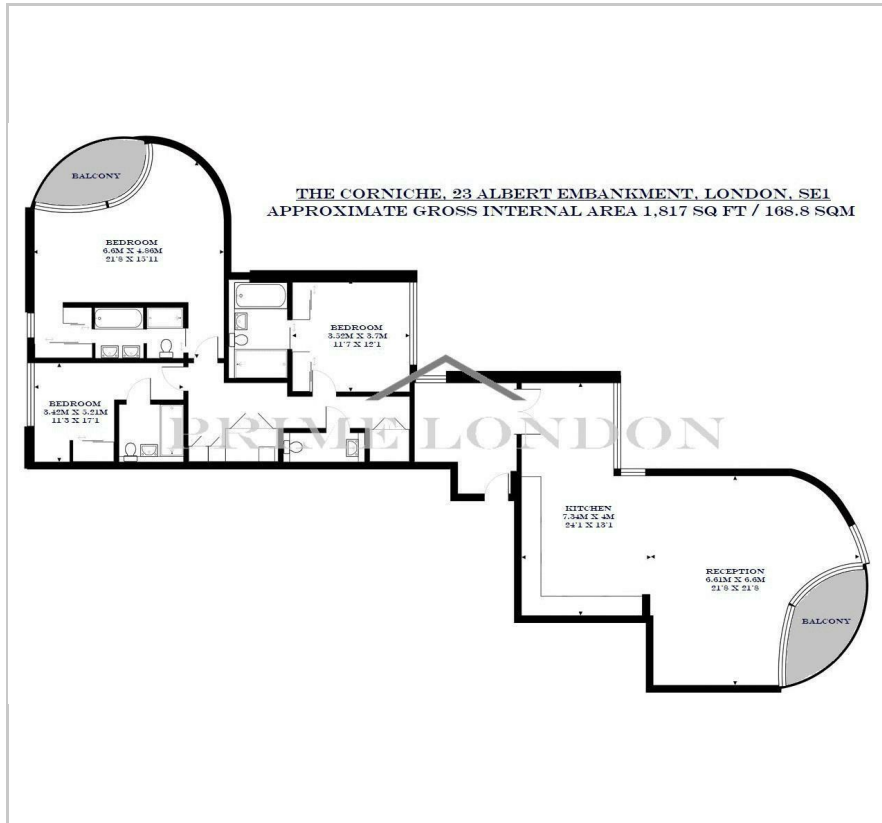

Area Map



Energy Efficiency Graph

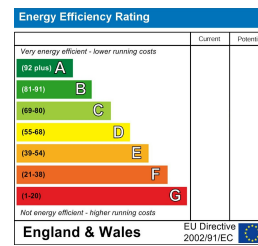

Viewing

Please contact our on 0207 928 6663 if you wish to arrange a viewing appointment for this property or require further information.

- Large living area and terrace
- Views of Battersea Power Station
- Resident's leisure facilities and 24 concierge
- Innovative and striking architecture
- Secure Underground Parking



An exceptional apartment in The Corniche totalling 1,817 sq ft (168.8 sqm) of lateral space and with three aspects capturing some of London's most exquisite views, available chain free through Prime London.

Located in an enviable position on the bank of the River Thames, The Corniche includes extensive residents facilities including a Gym, Spa, Pool and Cinema. The development also features a residents' club, offering views from the nineteenth floor of the Houses of Parliament and the River Thames, the Tate Britain, London Eye and the City beyond.



These particulars, whilst believed to be accurate are set out as a general outline only for guidance and do not constitute any part of an offer or contract. Intending purchasers should not rely on them as statements of representation of fact, but must satisfy themselves by inspection or otherwise as to their accuracy. No person in this firm's employment has the authority to make or give any representation or warranty in respect of the property.