

## Whitehouse Apartments

9 Belvedere Road, South Bank, SE1 8YP

£807 Per Week



2



2



1



C

Floor Plan

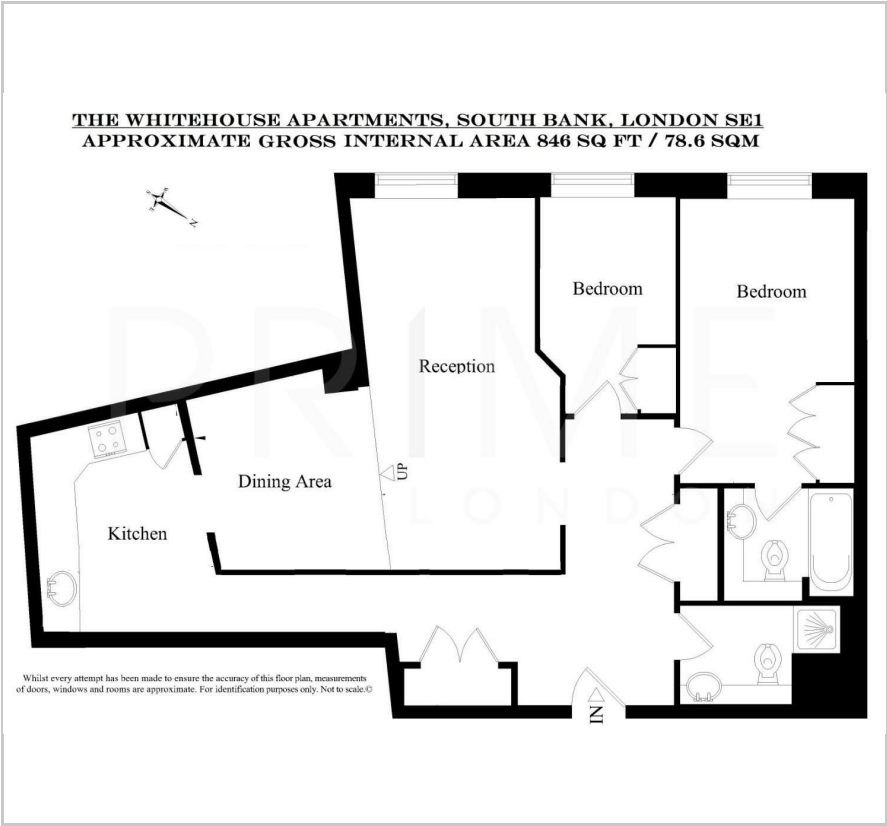

Area Map



Energy Efficiency Graph

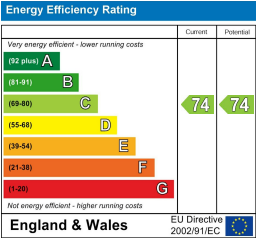

Viewing

By appointment. Contact us on 0207 928 6663 if you wish to arrange a viewing appointment for this property, or require further information.

- Large style two bedroom ■ 846 sq ft (78.6 sqm) apartment
- Direct views of the London Eye ■ Well positioned and spacious property
- Exclusive access to the spa ■ Gymnasium, heated swimming pool, steam room and sauna

With views of the London Eye from all principal rooms, and exclusively through Prime London, this significantly apartment offers an extremely rare opportunity to lease such a spacious property within the Whitehouse Apartments, South Bank.

The apartment offers a large and open reception, two double bedrooms with built-in storage (master with en suite), a fully fitted kitchen, dining/office area and separate shower room.

Additionally, residents enjoy exclusive access to the spa and fitness centre complete with fully equipped gymnasium, heated swimming pool, steam room and sauna.

The Whitehouse Apartments further features a 24 hour concierge service and communal roof terrace. Positioned moments from the South Bank, the location offers an array of some of London's finest cultural attractions, restaurants, cafes and shops.

Nearby Waterloo station provides superb transport links via the Bakerloo, Jubilee, Northern and Waterloo & City lines.



These particulars, whilst believed to be accurate are set out as a general outline only for guidance and do not constitute any part of an offer or contract. Intending purchasers should not rely on them as statements of representation of fact, but must satisfy themselves by inspection or otherwise as to their accuracy. No person in this firms employment has the authority to make or give any representation or warranty in respect of the property.