



The Dumont

Albert Embankment, SE1 7AP

£1,107 Per Week



Floor Plan

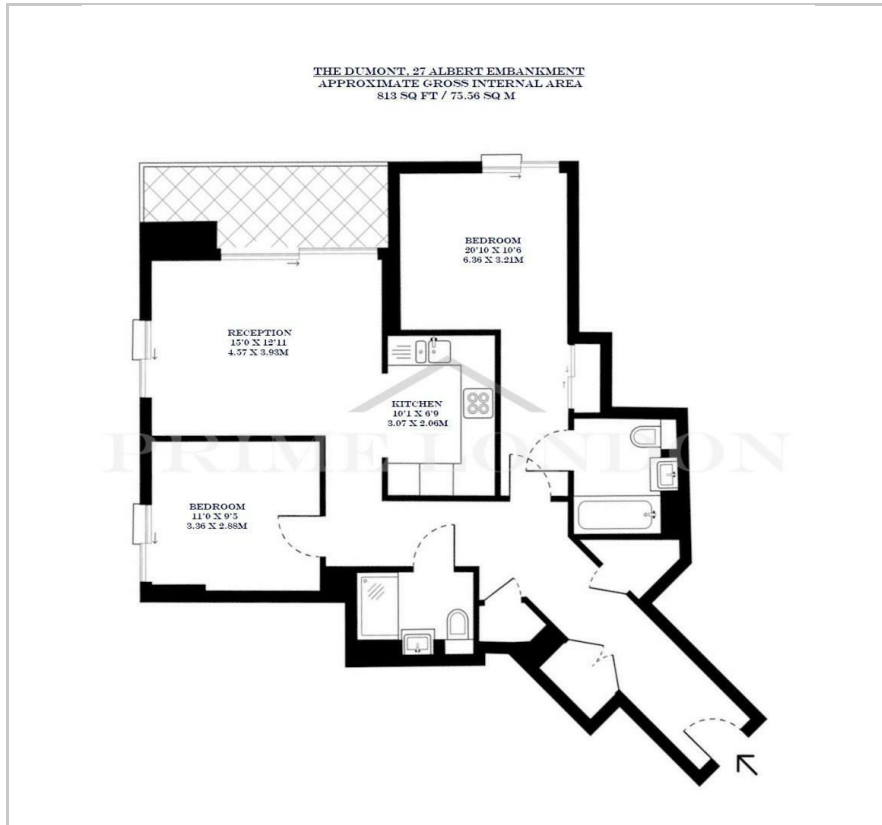

Area Map

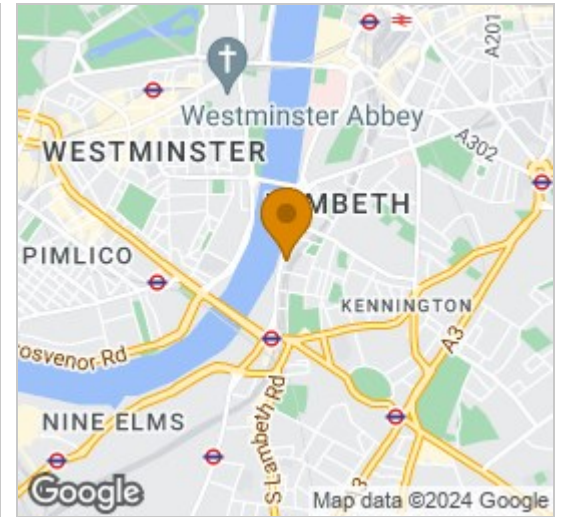

Energy Efficiency Graph

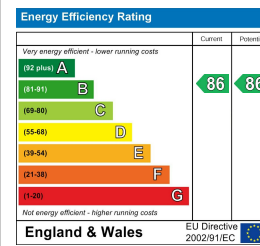

Viewing

By appointment. Contact us on 0207 928 6663 if you wish to arrange a viewing appointment for this property, or require further information.

- Modern two bedroom ▪ 813 sq ft / 75.56 sq m apartment
- Direct views of the River Thames ▪ Infinity pool, gym and spa facilities
- Twelfth floor residents' lounge ▪ 24 hour concierge

This beautifully presented and elegantly finished two bedroom apartment of 813 sq ft / 75.56 sq m in The Dumont, with direct views of the River Thames, is available fully furnished to let through Prime London.

This property benefits from an open plan reception room with a fully fitted kitchen, views of the River Thames, big ben, Parliament and the city. The apartment has two luxury double bedrooms, one is a master bedroom with an ensuite and the other is a large double bedroom following through to a family bathroom and a utility cupboard with good storage.

Facilities within the development include ten pin bowling and a games room, twelfth floor residents' lounge, dining room and roof terrace, 24 hour concierge and an infinity pool, gym and spa facilities located in The Corniche.

The Dumont completes the St James' trio of buildings on the Albert Embankment, situated between the cultural South Bank and the new Embassy District of Nine Elms.

*Images are of a similar style property and are intended to show example layout and finishes only.



These particulars, whilst believed to be accurate are set out as a general outline only for guidance and do not constitute any part of an offer or contract. Intending purchasers should not rely on them as statements of representation of fact, but must satisfy themselves by inspection or otherwise as to their accuracy. No person in this firm's employment has the authority to make or give any representation or warranty in respect of the property.