

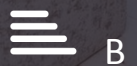

The Tower

St. George Wharf, SW8 2DA

£1,550 Per Week



Floor Plan

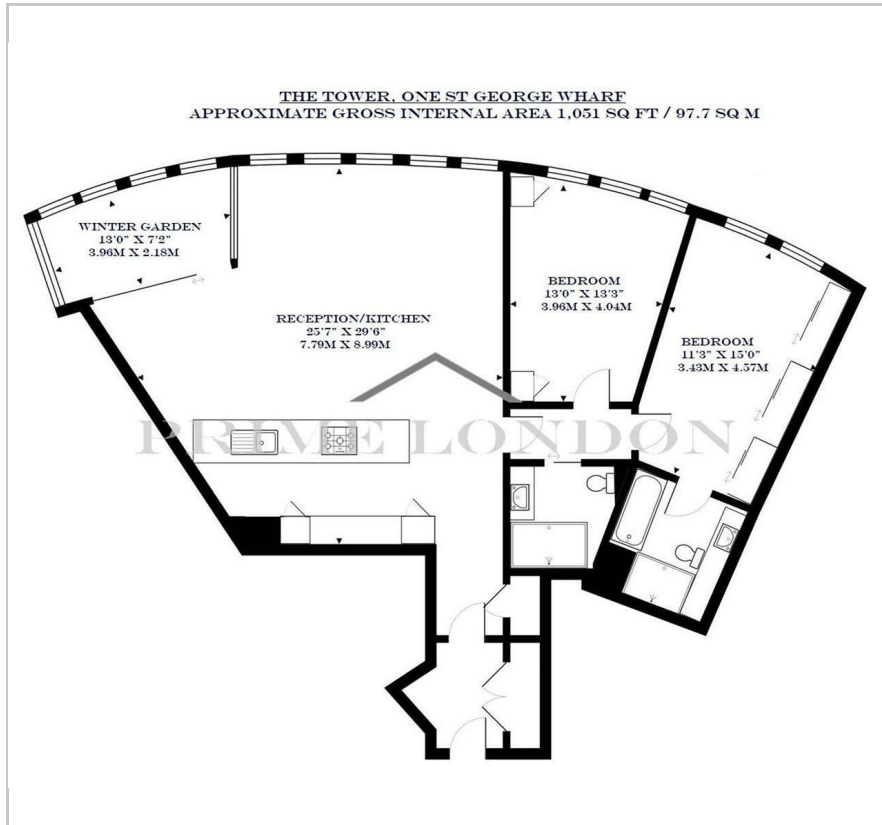

Area Map

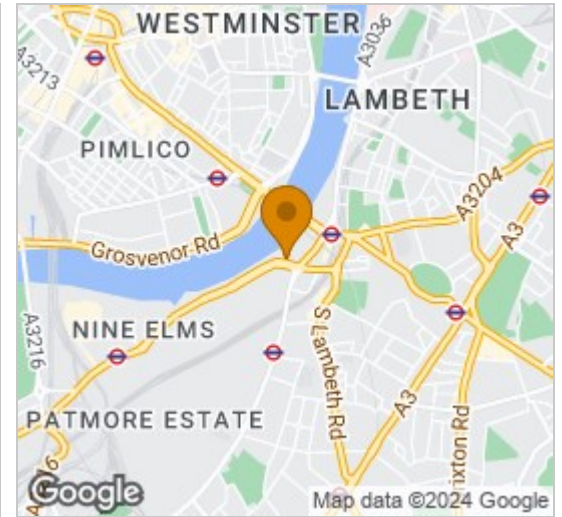

Energy Efficiency Graph



Viewing

By appointment. Contact us on 0207 928 6663 if you wish to arrange a viewing appointment for this property, or require further information.

- Exceptional two bedroom apartment
- Impressive views
- High specification bathrooms with exquisite tiling
- Automated controls
- Valet parking
- 1,051 sq ft / 97.7 sq m
- Fully integrated kitchen with Miele appliances
- Comfort cooling
- Full Leisure suite
- 24 hour concierge

A wonderfully furnished and beautifully designed two bedroom apartment with impressive views, totalling 1,051 sq ft (97.7 sq m), available for lease in The Tower, One St George Wharf, through Prime London. The property is also offered with excellent furnishings throughout and valet parking.

The apartment offers a fully integrated kitchen with Miele appliances, high specification bathrooms with exquisite tiling and fittings, comfort cooling, touch panel controls, recessed lighting and automated winter garden.

This exclusive development offers a valet parking service, and also a dedicated door service, 24 hour concierge, private health club with gym, infinity hydro pool, sauna and steam room, business facilities including a boardroom with conference facility, a business lounge and a private screening room and landscaped exterior gardens.

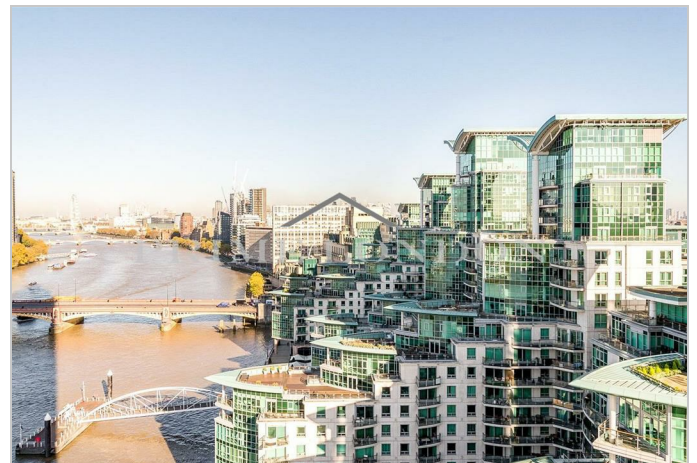

These particulars, whilst believed to be accurate are set out as a general outline only for guidance and do not constitute any part of an offer or contract. Intending purchasers should not rely on them as statements of representation of fact, but must satisfy themselves by inspection or otherwise as to their accuracy. No person in this firm's employment has the authority to make or give any representation or warranty in respect of the property.