

The Corniche

23 Albert Embankment, SE1 7GG

Asking Price £3,800,000



Floor Plan

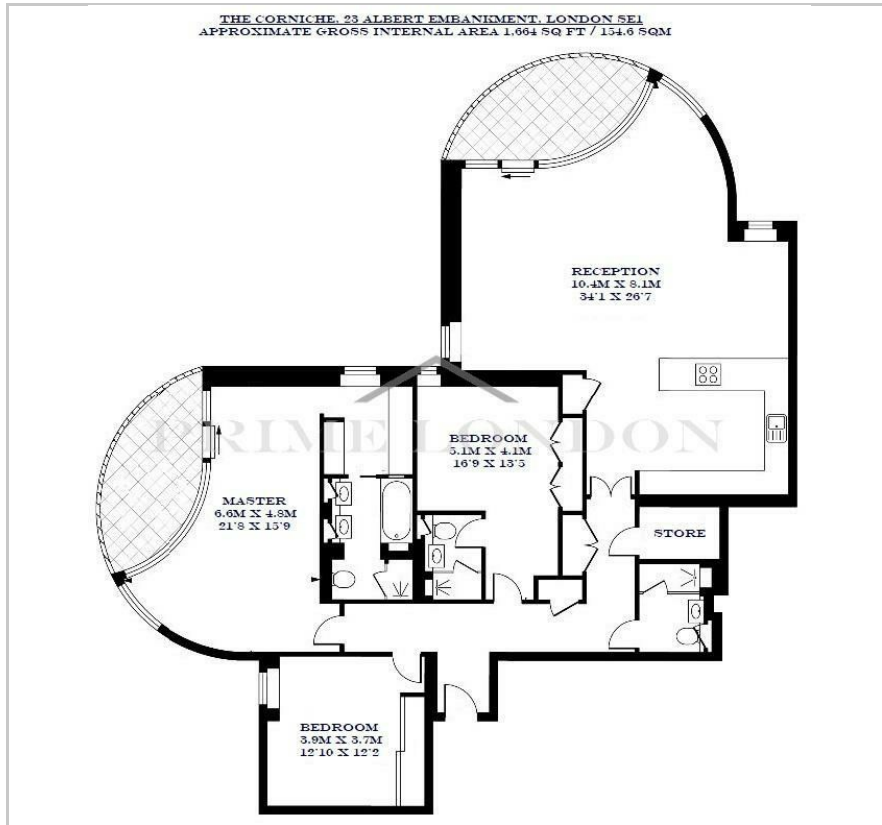

Area Map



Energy Efficiency Graph



Viewing

By appointment. Contact us on 0207 928 6663 if you wish to arrange a viewing appointment for this property, or require further information.

- Elite three bedroom ▪ 1,664 sq ft (154.59 sqm) apartment
- Secure Parking
- Turnkey
- Extensive residents facilities
- Vacant occupation and chain free

An interior designed elite dual aspect three bedroom apartment of 1,664 sq ft (154.59 sqm), with secure parking, available for purchase in The Corniche through Prime London.

Located in an enviable position on the bank of the River Thames, The Corniche (designed by Foster & Partners) captures some of London's most exquisite views, not only of the Houses of Parliament and the River Thames, but also the Tate Britain, London Eye and the City.

The development includes extensive residents facilities including a gym, spa, pool and cinema, and also a resident's club with roof terrace.



These particulars, whilst believed to be accurate are set out as a general outline only for guidance and do not constitute any part of an offer or contract. Intending purchasers should not rely on them as statements of representation of fact, but must satisfy themselves by inspection or otherwise as to their accuracy. No person in this firm's employment has the authority to make or give any representation or warranty in respect of the property.