



Parliament View Apartments

1 Albert Embankment, SE1 7XQ

Asking Price £525,000

- 1 Bed
- 1 Bath
- 1 Living
- 3 C

## Floor Plan

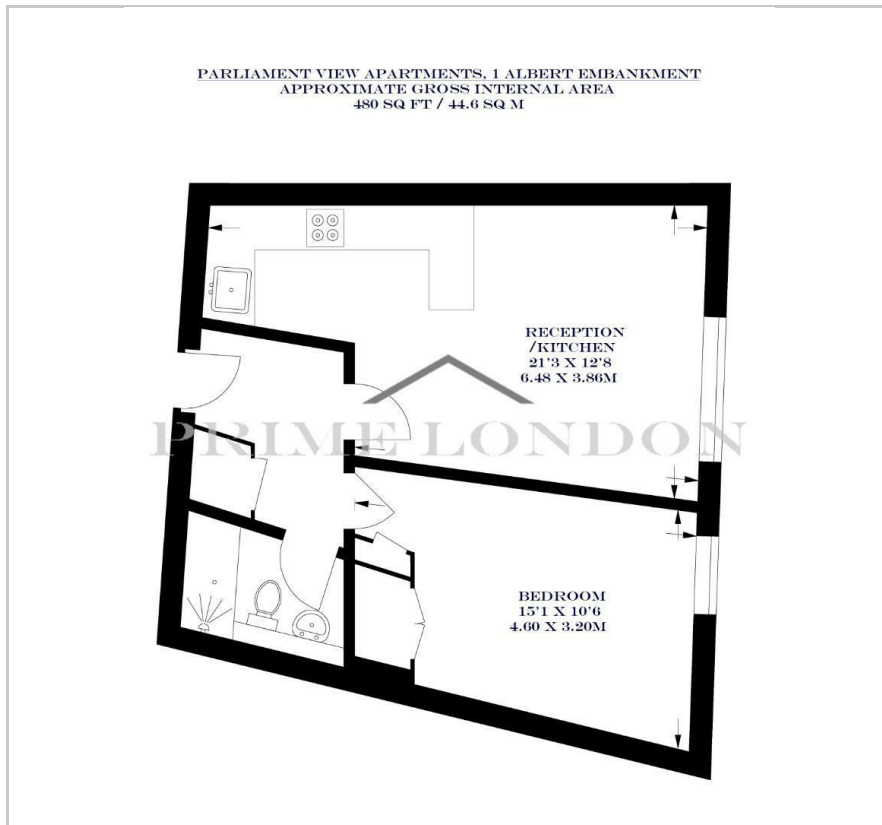

## Area Map



## Energy Efficiency Graph

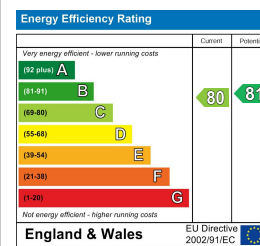

## Viewing

By appointment. Contact us on 0207 928 6663 if you wish to arrange a viewing appointment for this property, or require further information.

- Upgraded throughout
- Modern one bedroom apartment
- Wooden flooring and air cooling
- Residents' gym
- Chain free
- 24 hour concierge service

This spacious and upgraded one bedroom apartment in Parliament View, offering bright views from all principle rooms, is available for chain free sale through Prime London. Beautifully presented throughout, the property offers a generous reception, open plan fully fitted kitchen, spacious double bedroom and separate guest bathroom. Parliament View itself offers a 24 hour concierge service, resident's gymnasium and an excellent location on the river between Lambeth and Vauxhall Bridge. As a result, the development is within easy reach of the West End, Westminster, the City and South Bank. Vauxhall rail and underground station.



These particulars, whilst believed to be accurate are set out as a general outline only for guidance and do not constitute any part of an offer or contract. Intending purchasers should not rely on them as statements of representation of fact, but must satisfy themselves by inspection or otherwise as to their accuracy. No person in this firm's employment has the authority to make or give any representation or warranty in respect of the property.