



Ambassador Building

Embassy Gardens, Nine Elms, SW11 7BN

Asking Price £1,175,000



Floor Plan

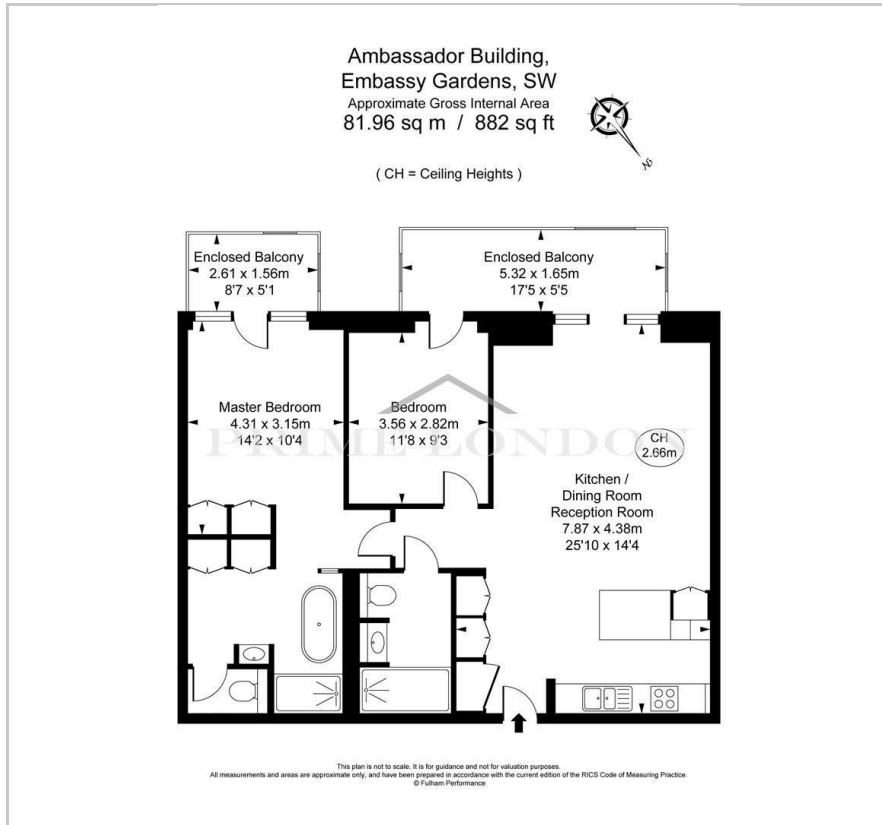

Area Map



Energy Efficiency Graph



Viewing

By appointment. Contact us on 0207 928 6663 if you wish to arrange a viewing appointment for this property, or require further information.

- 1 x Valet parking
- Chain free
- Gym, sky pool & deck, jacuzzi and cinema
- 882 sq ft / 81.9 sq m
- Direct views of the River Thames
- 24 hour concierge



This spacious and excellently finished two bedroom two bathroom apartment with valet parking, on the river side of Embassy Gardens with a private enclosed balcony with views of the River Thames, totalling 882 sq ft / 81.9 sq m, is available for chain free sale through Prime London.

Designed to the highest specification, the apartment boasts high ceilings, walnut parquet flooring, private balcony, comfort cooling and abundant natural light reminiscent of a Manhattan loft apartment.

Located on the banks of the Thames and near London's cultural South bank, residents enjoy a wealth of the Capital's finest attractions and amenities practically on their doorstep, and premium residents facilities including an exclusive private club and health spa.



These particulars, whilst believed to be accurate are set out as a general outline only for guidance and do not constitute any part of an offer or contract. Intending purchasers should not rely on them as statements of representation of fact, but must satisfy themselves by inspection or otherwise as to their accuracy. No person in this firm's employment has the authority to make or give any representation or warranty in respect of the property.