



Drake House

St George Wharf, Vauxhall, SW8 2LR

Asking Price £700,000



Floor Plan

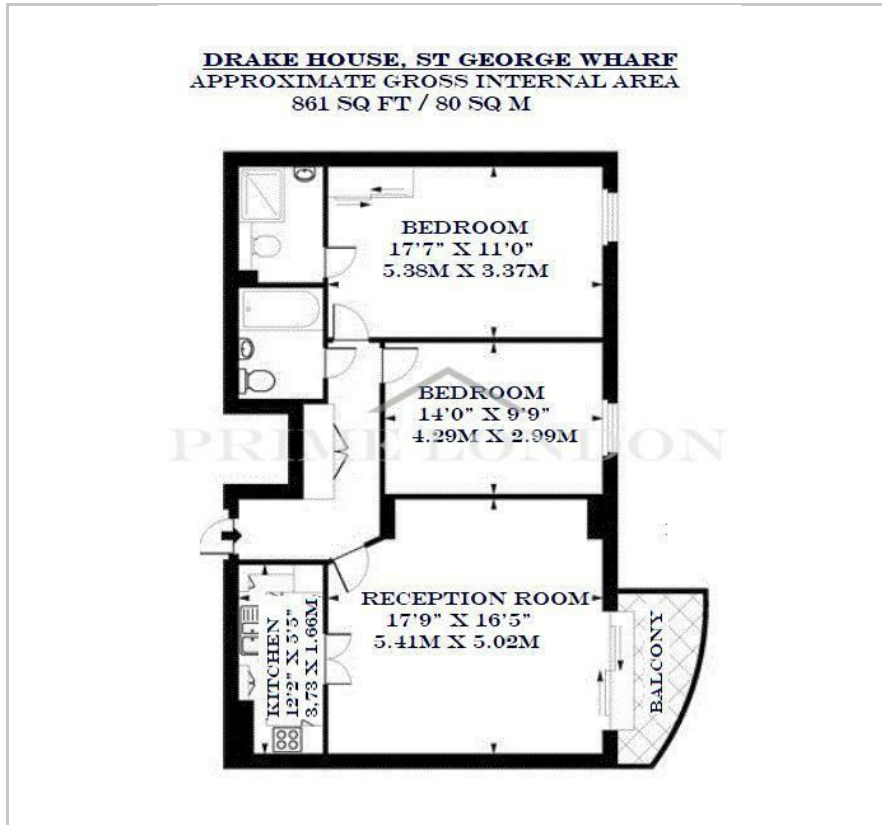

Area Map

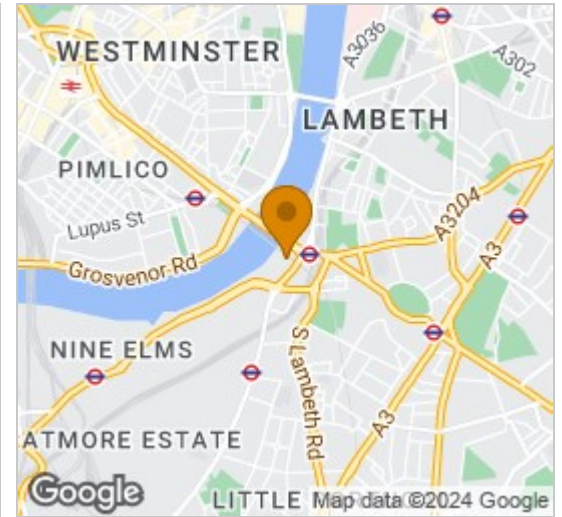

Energy Efficiency Graph

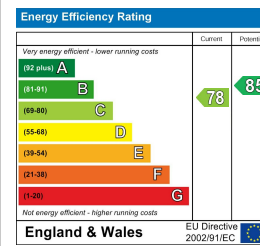

Viewing

By appointment. Contact us on 0207 928 6663 if you wish to arrange a viewing appointment for this property, or require further information.

- Modern two bedroom
- 861 sq ft / 80 sq m apartment
- Views of the River Thames
- Private balcony
- Excellent transport links
- 24 hour concierge



This modern two double bedroom apartment of 861 sq ft / 80 sq m with private balcony, positioned with views of the River Thames, and set within the highly sought after St George Wharf, is available for chain free sale through Prime London Residential.

The apartment comprises of a larger style and well-designed reception room leading to a private balcony with river views, a semi separate and fully fitted modern kitchen, two double bedrooms with plenty of storage (one with en suite bathroom), and a further family bathroom. The property also features wooden flooring in the reception.

This apartment benefits from the fantastic transport links afforded by this very well kept complex by The River Thames. St George Wharf offers on site riverside bars and restaurants such as Waterfront London, The Riverside, Four Degree and Pop Art Sushi as well as direct access to Vauxhall Underground Station on the Victoria Line. For additional convenience other on site outlets include The Gym Group, Tesco Express, Pret a Manger, Hudson's Dry Cleaners, Riverside Medical Centre & Dental Spa and more.



These particulars, whilst believed to be accurate are set out as a general outline only for guidance and do not constitute any part of an offer or contract. Intending purchasers should not rely on them as statements of representation of fact, but must satisfy themselves by inspection or otherwise as to their accuracy. No person in this firm's employment has the authority to make or give any representation or warranty in respect of the property.