



WHITEHORSES

Buy. Sell. Let. Relax!

0114 268 8533
info@whitehorses.com
www.whitehorses.com

36 Spurr Street, Heeley

Sheffield

Guide Price £235,000 - £245,000

36 Spurr Street

Heeley, Sheffield

Nestled in the heart of the ultra-fashionable Heeley area, this fabulous three-bedroom end of terrace house presents a wonderful opportunity for first-time buyers, professional couples, or young families seeking a stylish home within walking distance of Central Sheffield. Boasting convenient access to numerous local amenities, this property offers an ideal blend of urban living and suburban peacefulness. The property is thoughtfully laid out across two floors totalling an impressive 877 sq feet, providing spacious and light-filled interiors that have been meticulously finished to a high standard by the current vendors. With no upward chain involved and also benefitting from easy on-road parking to the front and a private rear terrace. Situated close to numerous local amenities and excellent public links number 36 simply must be viewed internally to be fully appreciated. Council Tax band: A Tenure: Leasehold

- FABULOUS THREE BEDROOM END OF TERRACE HOME
- HEART OF ULTRA FASHIONABLE HEELEY
- WALKING DISTANCE TO CENTRAL SHEFFIELD AND NUMEROUS LOCAL AMENITIES
- PERFECT FOR THE FIRST TIME BUYER PROFESSIONAL COUPLE OR YOUNG FAMILY ALIKE
- AVAILABLE WITH NO UPWARD CHAIN INVOLVED
- PRIVATE REAR TERRACE GARDEN AND EASY ON ROAD PARKING TO THE FRONT
- SPACIOUS AND LIGHT ACCOMMODATION ACROSS TWO FLOORS
- FINISHED INTERNALLY TO A HIGH STANDARD





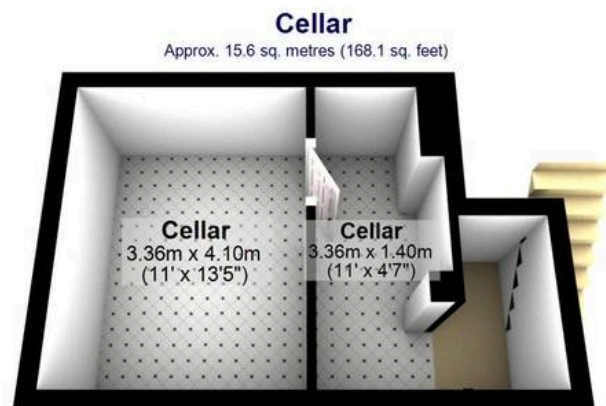

Total area: approx. 81.5 sq. metres (877.3 sq. feet)

All measurements are approximate
Plan produced using PlanUp.

WHITEHORNES
Buy. Sell. Let. Relax!

0114 268 8533
info@whitehornes.com
www.whitehornes.com