

24 Woodstock Road, Nether Edge

Sheffield

Guide Price £350,000

24 Woodstock Road

Nether Edge, Sheffield

Nestled on a quiet residential road in the heart of the sought-after Nether Edge, this fabulous three-bedroom, two-bathroom villa-style bay window Victorian terraced house is a true gem. Recently refurbished to an exceptionally high standard by the current vendors, this immaculate property boasts a double rear off-shot and a private rear garden with no through fare from neighbouring properties and easy on road parking to the front. Positioned just a short stroll to the fashionable Abbeydale Road and Nether Edge Village that offer up a wide range of eateries, cafes and shops. This home is perfectly situated to also enjoy excellent schooling catchments, including Mercia Secondary, Chelsea Park is also a short walk and not forgetting The Peak District is on the doorstep. Spread across three floors, the property offers a total of 1,347 square feet of light and spacious accommodation, featuring newly fitted kitchen flowing into an open-plan Council Tax band: C

Tenure: Leasehold

- FABULOUS THREE BEDROOM TWO BATHROOM VILLA STYLE BAY WINDOW VICTORIAN TERRACED
- RECENTLY REFURBISHED TO AN EXCEPTIONALLY HIGH STANDARD BY THE CURRENT VENDORS
- DOUBLE REAR OFF SHOT PRIVATE REAR GARDEN WITH NO THROUGH FARE FROM NEIGHBOURING PROPERTIES AND EASY ON ROAD PARKING
- QUIET RESIDENTIAL ROAD IN THE VERY HEART OF ULTRA POPULAR NETHER EDGE
- SHORT STROLL TO FASHIONABLE ABBEYDALE ROAD





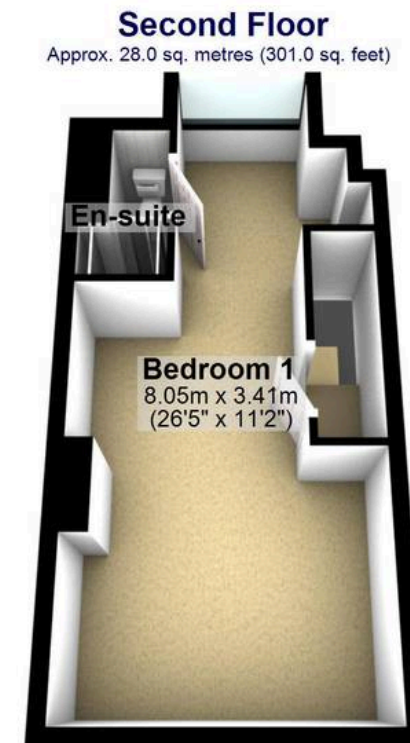
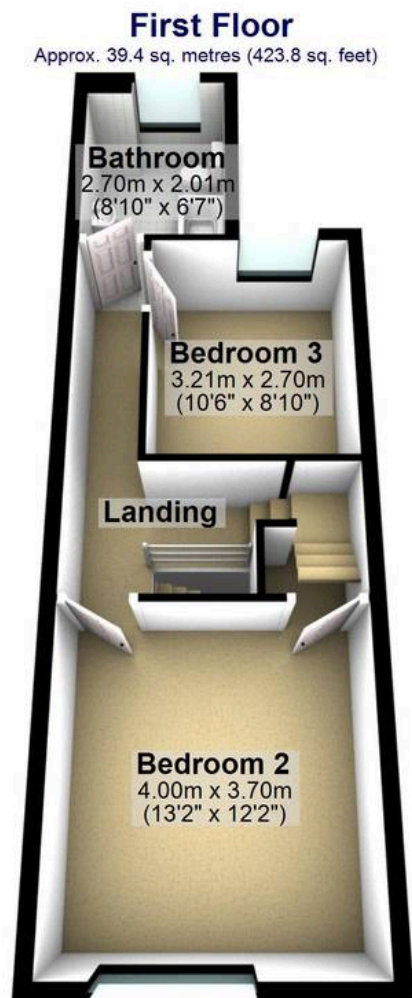
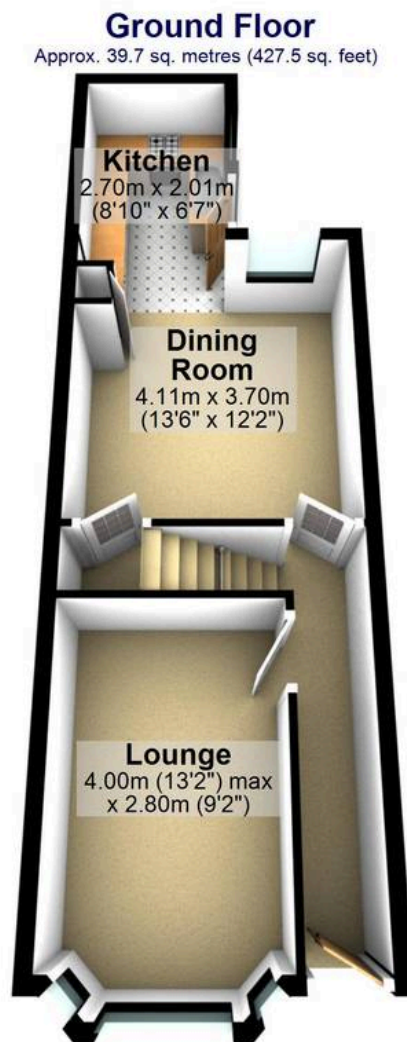
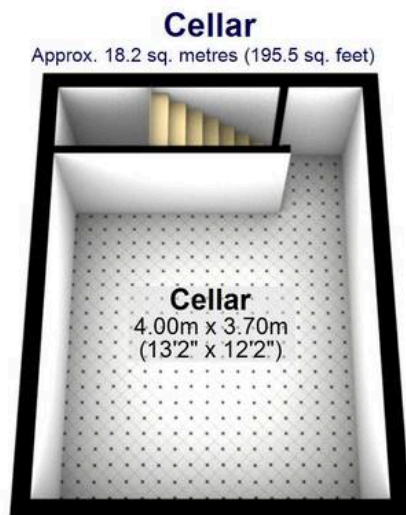

Total area: approx. 125.2 sq. metres (1347.7 sq. feet)

All measurements are approximate
Plan produced using PlanUp.