

Flat 4, Castlewood Court, 2 Castlewood Drive

Sheffield

Guide Price £200,000 - £210,000

Flat 4

Castlewood Court, Sheffield

An incredibly rare opportunity has arisen to purchase this wonderful two bedroom, first floor apartment. This lovely property will sure to be of interest to those looking to downsize or equally the professional couple. Located at the rear of this well sought development on this quiet no through road and in our opinion occupying one of the best spots with a peaceful and tranquil setting together with fabulous views over the communal grounds, woodland and The Mayfield Valley that are best enjoyed from the private balcony. With 603 sq feet of spacious and light accommodation all on one level, newly fitted out kitchen and bathroom, it's easy to say this apartment will need to be viewed internally to be fully appreciated. Offered to market with no upward chain involved, private single garage and ample visitor parking spaces number 4 is set within the very heart of well regarded Fulwood. Council Tax band: B Tenure: Leasehold

- STUNNING TWO BEDROOM FIRST FLOOR APARTMENT
- QUIET TUCKED AWAY POSITION ON THIS NO THROUGH ROAD
- FABULOUS VIEWS DOWN THE VALLEY TOWARDS FULWOOD VILLAGE
- GATED ACCESS FROM THE DEVELOPMENT TO WOODLAND WALKS
- PRIVATE SINGLE GARAGE AND LARGE COMMUNAL CAR PARK
- AVAILABLE TO MARKET WITH NO UPWARD CHAIN INVOLVED AND VIEWING ESSENTIAL
- PRIVATE BALCONY ACCESSED FROM SITTING ROOM





First Floor

Approx. 55.8 sq. metres (601.0 sq. feet)

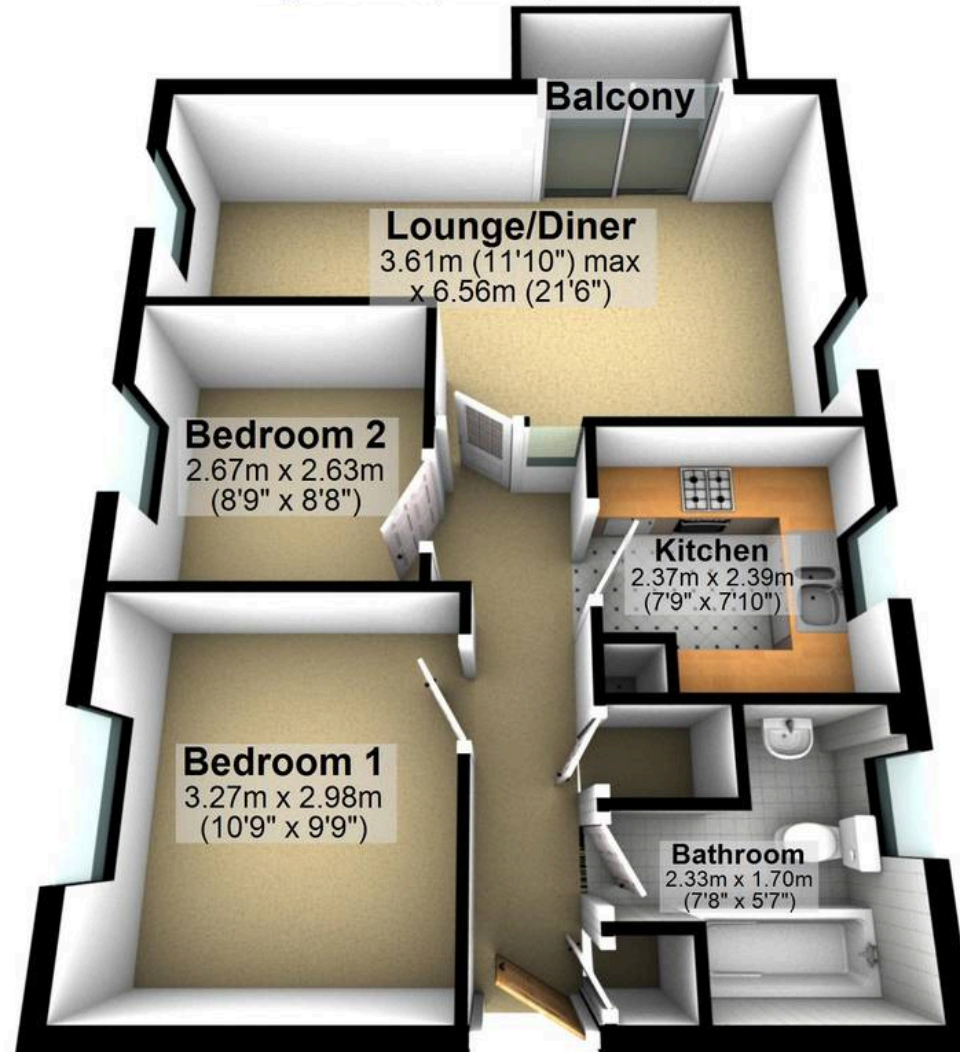

Total area: approx. 55.8 sq. metres (601.0 sq. feet)

All measurements are approximate
Plan produced using PlanUp.



WHITEHORNS

Buy. Sell. Let. Relax!

0114 268 8533
info@whitehorns.com
www.whitehorns.com