



WHITEHORNS

Buy. Sell. Let. Relax!

0114 268 8533
info@whitehorns.com
www.whitehorns.com

80 Brookhouse Hill, Fulwood Village

Sheffield

Guide Price £450,000 - £475,000

80 Brookhouse Hill

Fulwood Village, Sheffield

An incredibly rare opportunity has arisen to purchase this strikingly attractive, six bedroom, stone fronted, bay window, Victorian semi detached home. Retaining plenty of the original period features, character and charm associated with a property from this era together with offering the new buyers a real blank canvas from which to start from to create a personalised finish to their own taste and produce a stunning finished, forever family home. Offered to the market with the benefit of no upward chain involved number 88 serves up three spacious floors of accommodation that total an impressive 2,052 sq feet. With a private rear garden and on road parking to the front it goes without saying that viewing is absolutely essential to fully appreciate the potential on offer by this generous property. Council Tax band: E Tenure: Freehold

- INCREDIBLY RARE OPPORTUNITY TO MARKET WITH VIEWING ESSENTIAL
- BEAUTIFUL PERIOD STONE FRONTED BAY WINDOW SEMI DETACHED FAMILY HOME
- THREE FLOORS OF ACCOMMODATION TOTALLING AN IMPRESSIVE 2,052 SQ FEET
- HUGE POTENTIAL TO CREATE A FOREVER DREAM HOME OFFERING A REAL BLANK CANVAS FROM WHICH TO START FROM
- EXCELLENT LOCAL SCHOOL CATCHMENTS INCLUDING NETHER GREEN JUNIOR TAPTON AND HIGH STORRS SECONDARY
- HEART OF ULTRA POPULAR FULWOOD VILLAGE ON THE EDGE OF THE MAYFIELD VALLEY AND PEAK DISTRICT
- SHORT STROLL TO INDEPENDENT CAFES SHOPS EATERIES AND FORGE DAM
- EASY ACCESS TO PRINCIPAL HOSPITALS AND UNIVERSITIES





Cellar
 Approx. 27.7 sq. metres (298.1 sq. feet)

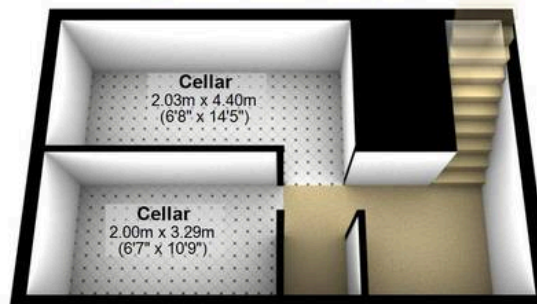

Ground Floor
 Approx. 68.7 sq. metres (739.9 sq. feet)

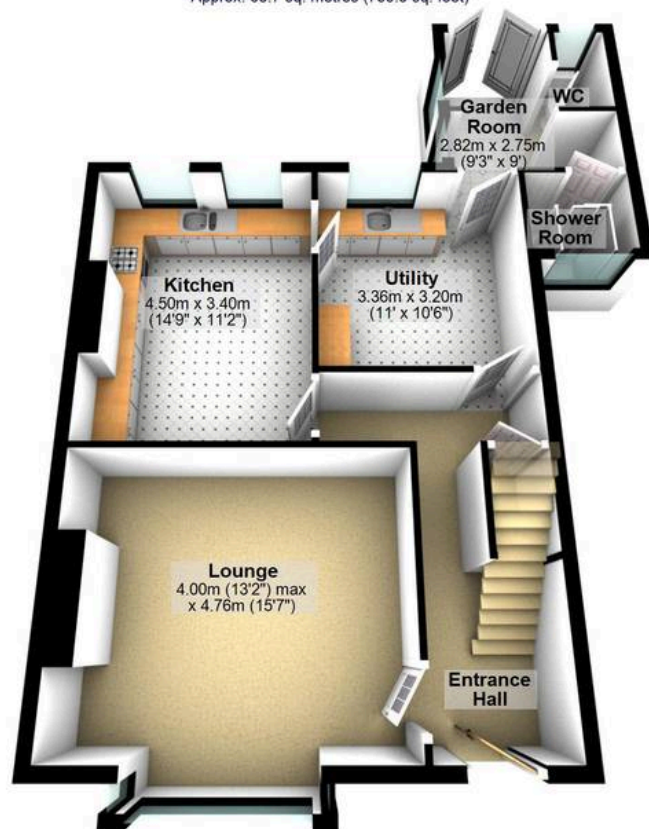

First Floor
 Approx. 57.6 sq. metres (620.5 sq. feet)



Second Floor
 Approx. 36.5 sq. metres (392.7 sq. feet)

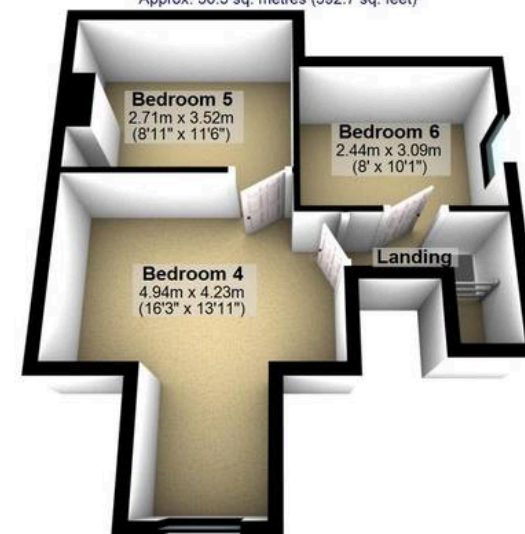

Total area: approx. 190.6 sq. metres (2051.3 sq. feet)

All measurements are approximate
 Plan produced using PlanUp.