



WHITEHORSES

Buy. Sell. Let. Relax!

0114 268 8533
info@whitehorses.com
www.whitehorses.com

75 Old Park Road, Beauchief

Sheffield

Offers in the region of £395,000

75 Old Park Road

Beauchief, Sheffield

An absolutely stunning, immaculately presented and very well proportioned three bedroom, bay window semi detached home. Having been expertly extended and finished internally to a super high standard with absolutely no expense spared to create this breathtaking and contemporary finish that is sure to impress the growing family market. Enjoying a rear fabulous open plan kitchen, living, diner that is flooded with light and gives direct garden access it's easy to say that viewing is absolutely essential to fully appreciate the style and finish on offer by this gorgeous family home. Offering further opportunities subject to planning to extend to the loft if required as neighbouring properties have done so to create further accommodation if required. With off road parking, garage and lovely rear private sunny garden. Located on this quiet residential road in the heart of this well sought after suburb, number 75 falls within easy access to

Council Tax band: C Tenure: Leasehold

- STUNNING THREE BEDROOM BAY WINDOWED SEMI-DETACHED HOME
- FINISHED INTERNALLY TO AN EXCEPTIONALLY HIGH STANDARD WITH NO EXPENSE SPARED
- OPEN PLAN REAR EXTENDED KITCHEN/LIVING/DINER WITH GARDEN ACCESS
- CONTEMPORARY DESIGN THROUGHOUT THAT NEEDS TO BE VIEWED TO BE FULLY APPRECIATED
- EXCELLENT LOCAL SCHOOL CATCHMENTS AVAILABLE
- PERFECT FOR THE GROWING FAMILY MARKET LOOKING FOR A FOREVER HOME
- HEART OF THIS ULTRA POPULAR RESIDENTIAL CLOSE TO AMENITIES





Ground Floor

Approx. 68.7 sq. metres (739.9 sq. feet)

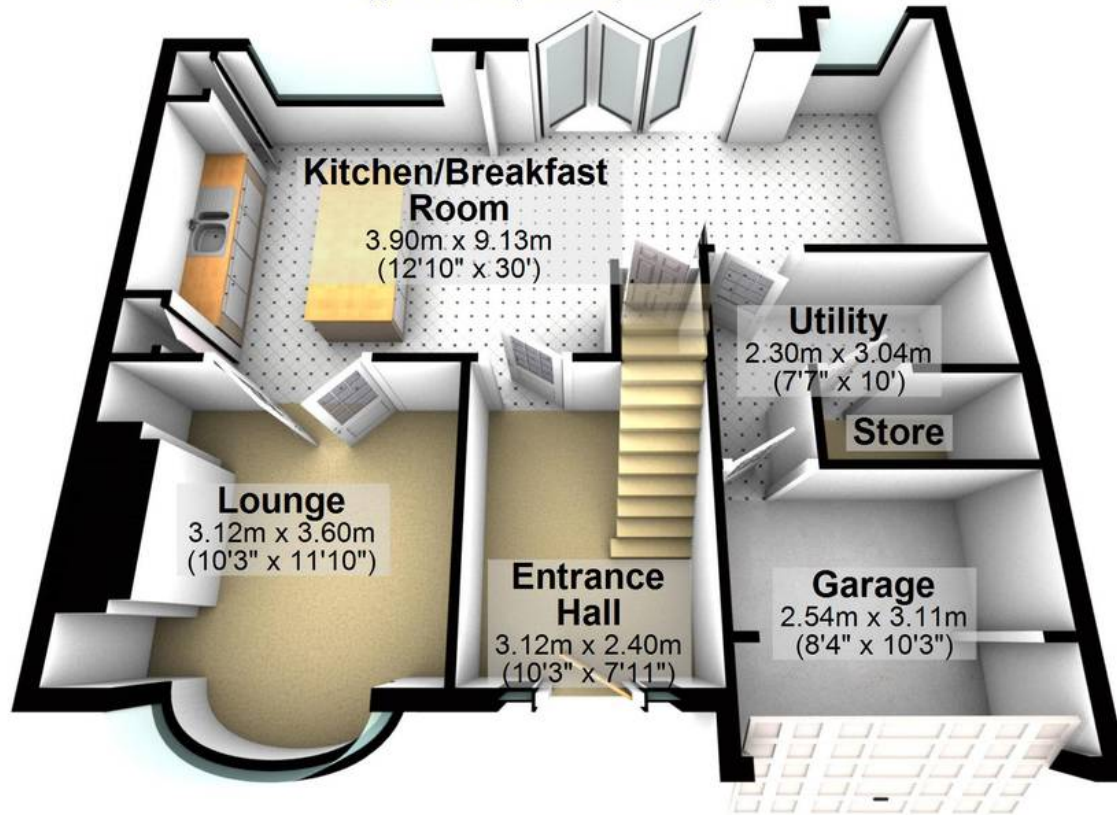

First Floor

Approx. 43.9 sq. metres (472.0 sq. feet)

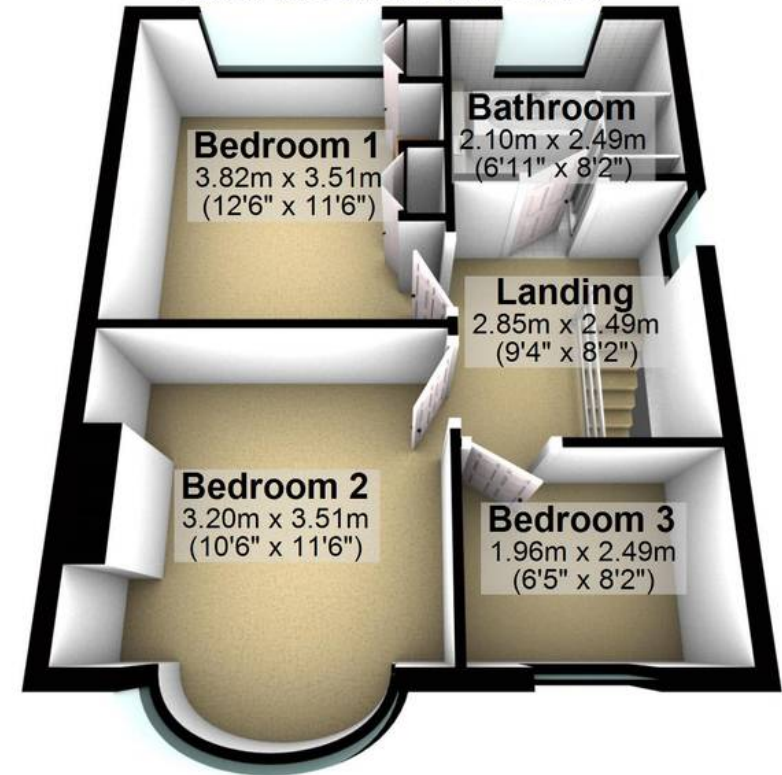

Total area: approx. 112.6 sq. metres (1211.9 sq. feet)

All measurements are approximate
Plan produced using PlanUp.



WHITEHORNES

Buy. Sell. Let. Relax!

0114 268 8533
info@whitehornes.com
www.whitehornes.com