



WHITEHORNES

Buy. Sell. Let. Relax!

0114 268 8533
info@whitehorses.com
www.whitehorses.com



296 Yew Lane, Sheffield

Sheffield

Guide Price **£215,000 – £225,000**

296 Yew Lane

Sheffield, Sheffield

Offered to the open market with the benefit of no onward chain and vacant on completion is this well presented and proportioned three bedroomed semi-detached family home. With off road parking to the front and a large garage the property offers an opportunity to further extend to the rear if required and subject to planning. With two floors of spacious and light accommodation the property will be of particular interest to the first time buyer or young family alike. Located in this established residential suburb close to numerous amenities, great public transport links and the open countryside. The property boasts three great sized bedrooms, two reception rooms, well appointed kitchen/dining room and family bathroom.

Council Tax band: C

Tenure: Freehold

- THREE BEDROOMED SEMI - DETACHED PROPERTY
- TWO RECEPTION ROOMS
- A WONDERFUL FAMILY HOME
- CLOSE TO MANY LOCAL AMENITIES
- AVAILABLE WITH NO ONWARD CHAIN
- POTENTIAL TO EXTEND
- GARAGE AND OFF ROAD PARKING
- PERFECT FAMILY HOME
- PRIVATE GARDENS
- FREEHOLD PROPERTY AND COUNCIL TAX BAND C
£2,021 P/A





Ground Floor

Approx. 73.6 sq. metres (792.4 sq. feet)

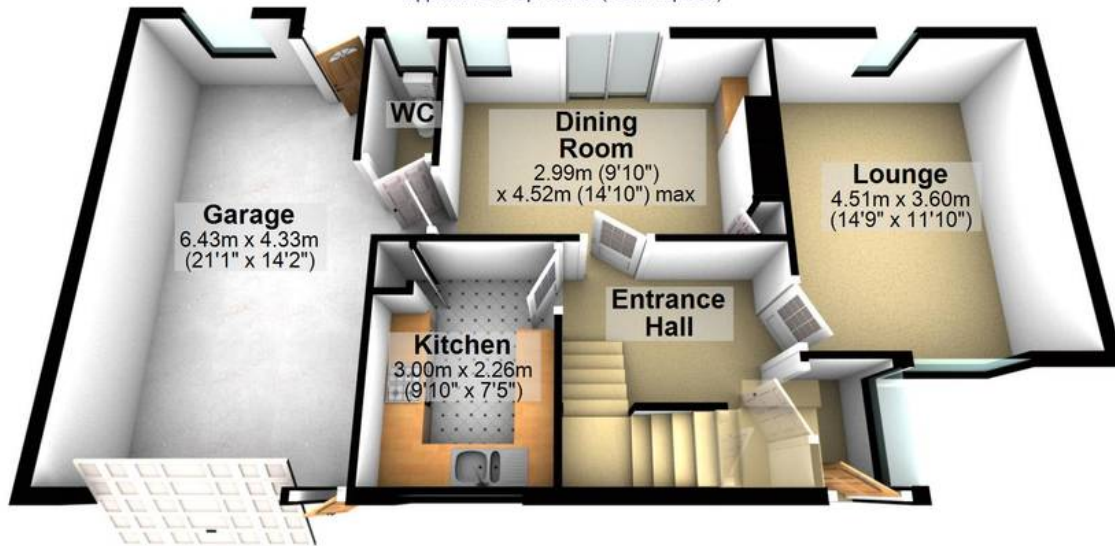

First Floor

Approx. 46.3 sq. metres (498.9 sq. feet)

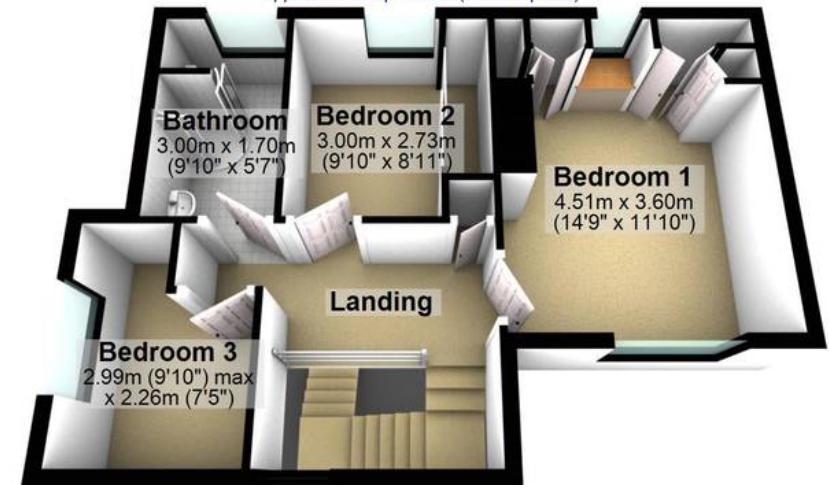

Total area: approx. 120.0 sq. metres (1291.3 sq. feet)

All measurements are approximate
Plan produced using PlanUp.