



WHITEHORNES
Buy. Sell. Let. Relax!
0114 268 8533
info@whitehorses.com
www.whitehorses.com

254 School Road, Crookes
Sheffield

Offers in Region of £300,000

254 School Road

Crookes, Sheffield

This impressive property is a well presented four bedroom terraced house nestled in the heart of the highly sought-after Crookes district in the southwest of the city. Boasting the charm of a Victorian stone-built construction, this property has been tastefully extended to provide a generous living space across three floors, totalling 1,167 sq feet. The property is offered to the market with the benefit of no upward chain, providing vacant possession for its new owners. One of the standout features of this property is its prime location within walking distance of local amenities, buzzing high street with independent cafes and shops, as well as renowned hospitals and universities. The property also benefits from excellent local school catchments, catering to families with children. Additionally, with the potential to easily create a driveway at the front, as neighbouring properties have already done, this home is ideal for a professional couple or a young family looking for a deceptive residence in

Council Tax band: B Tenure: Freehold

- FOUR BEDROOM STONE BUILT MID VICTORIAN TERRACED
- POTENTIAL TO EASILY CREATE A DRIVEWAY TO THE FRONT AS NEIGHBOURS HAVE ALREADY DONE SO
- AVAILABLE TO MARKET WITH NO UPWARD CHAIN AND VACANT POSSESSION
- HEART OF ULTRA POPULAR CROOKES ON THE SOUTH WEST OF THE CITY
- EXCELLENT LOCAL SCHOOL CATCHMENTS AVAILABLE
- SHORT STROLL TO BUZZING CROOKES HIGH STREET THAT OFFERS AN ARRAY OF INDEPENDENT CAFES AND SHOPS
- WALKING DISTANCE TO PRINCIPAL HOSPITALS AND UNIVERSITIES





Ground Floor

Approx. 42.3 sq. metres (455.7 sq. feet)

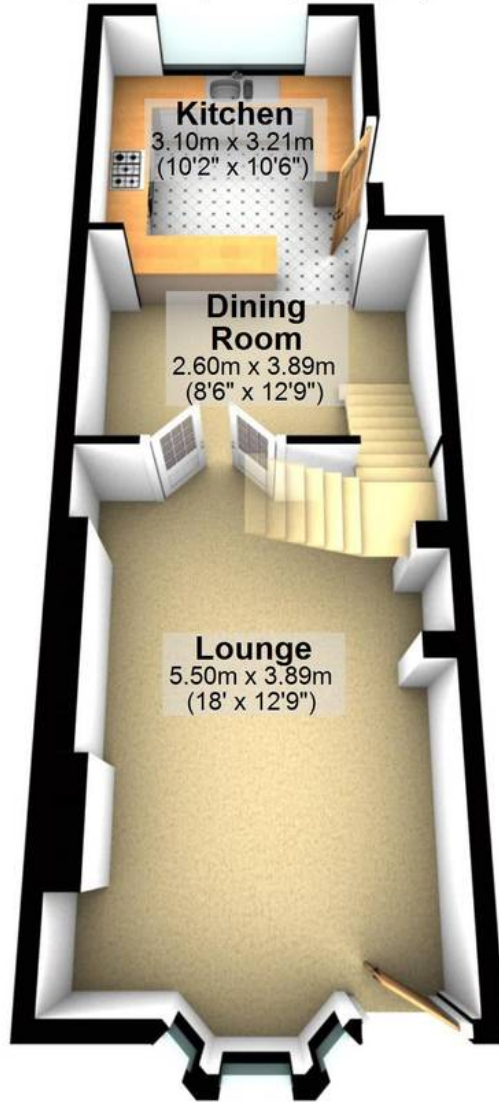

First Floor

Approx. 41.0 sq. metres (441.5 sq. feet)



Second Floor

Approx. 25.1 sq. metres (270.2 sq. feet)

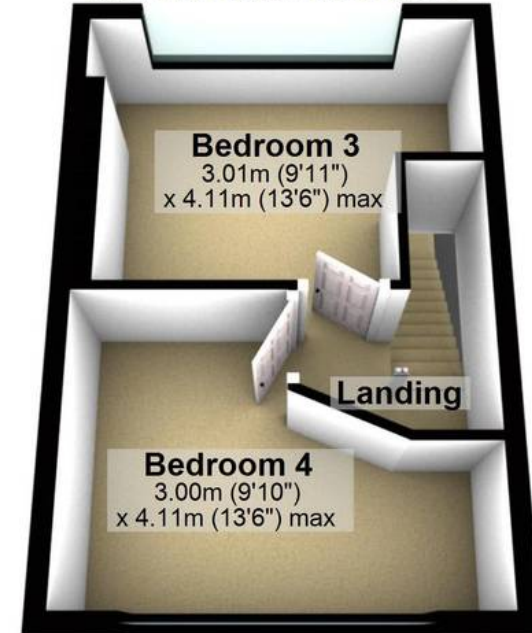

Total area: approx. 108.5 sq. metres (1167.5 sq. feet)

All measurements are approximate
Plan produced using PlanUp.