



WHITEHORNES

Buy. Sell. Let. Relax!

0114 268 8533
info@whitehorns.com
www.whitehorns.com

WHITEHORNES
FOR SALE
268 8533
WHITEHORNES.COM

256 Bradway Road, Sheffield

Sheffield

Guide Price £425,000 – £450,000

256 Bradway Road

Sheffield, Sheffield

An absolutely gorgeous, four bedroom, two bathroom, bay windowed semi detached family home. Having been tastefully extended to the rear and lift to create this spacious and light feel throughout. The property offers up three floors of accommodation that total an impressive 1,318 sq feet together with ample parking to the front and a substantial, very private rear family garden. Pitch perfect for the growing family market the property simply must be viewed to be fully appreciated. With further scope to open the kitchen in to dining room, number 256 is located on this incredibly popular residential road within the very heart of Bradway on the south west of the city. Falling within catchment for some excellent schools, numerous independent amenities are a short stroll and The Peak District is literally on the doorstep. In brief this wonderful home comprises entrance porch, hallway, through sitting/dining room, kitchen and WC. To the first floor are three bedrooms and a family bathroom whilst

Council Tax band: C Tenure: Leasehold

- FABULOUS FOUR BEDROOM TWO BATHROOM SEMI DETACHED FAMILY HOME
- TASTEFULLY EXTENDED TO THE REAR AND LOFT TO CREATE THIS SPACIOUS AND LIGHT FEEL THROUGHOUT
- THREE FLOORS OF ACCOMMODATION TOTALLING AN IMPRESSIVE 1,318 SQ FEET
- HEART OF ULTRA POPULAR BRADWAY ON THE SOUTH WEST OF THE CITY
- WELL REGARDED LOCAL SCHOOL CATCHMENTS AVAILABLE
- LARGE PRIVATE GARDEN AND AMPLE PARKING ON THE DRIVEWAY TO THE FRONT





Ground Floor

Approx. 47.1 sq. metres (506.5 sq. feet)

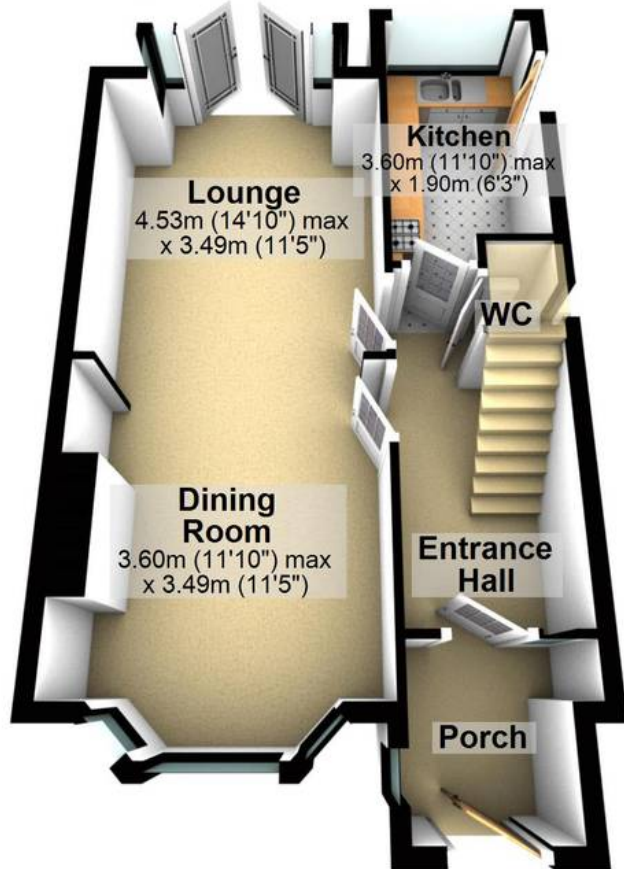

First Floor

Approx. 43.1 sq. metres (463.7 sq. feet)

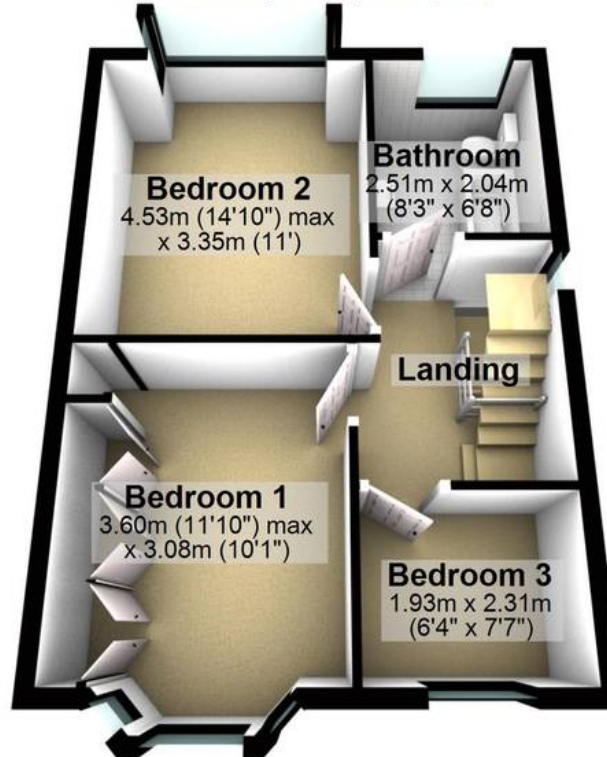

Second Floor

Approx. 32.3 sq. metres (348.1 sq. feet)

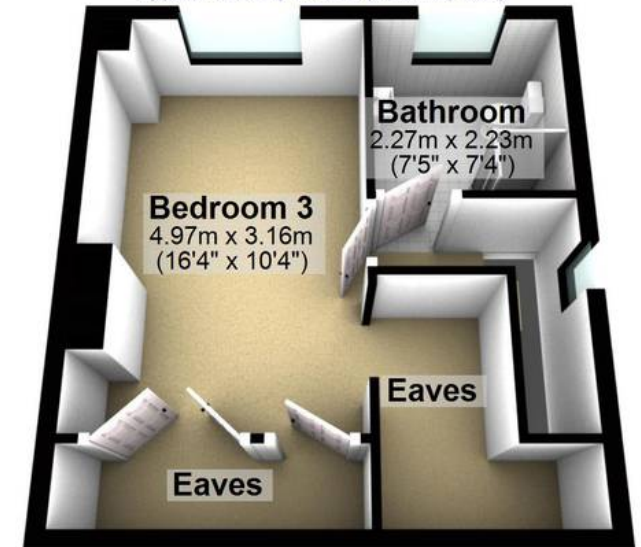

Total area: approx. 122.5 sq. metres (1318.3 sq. feet)

All measurements are approximate
Plan produced using PlanUp.