

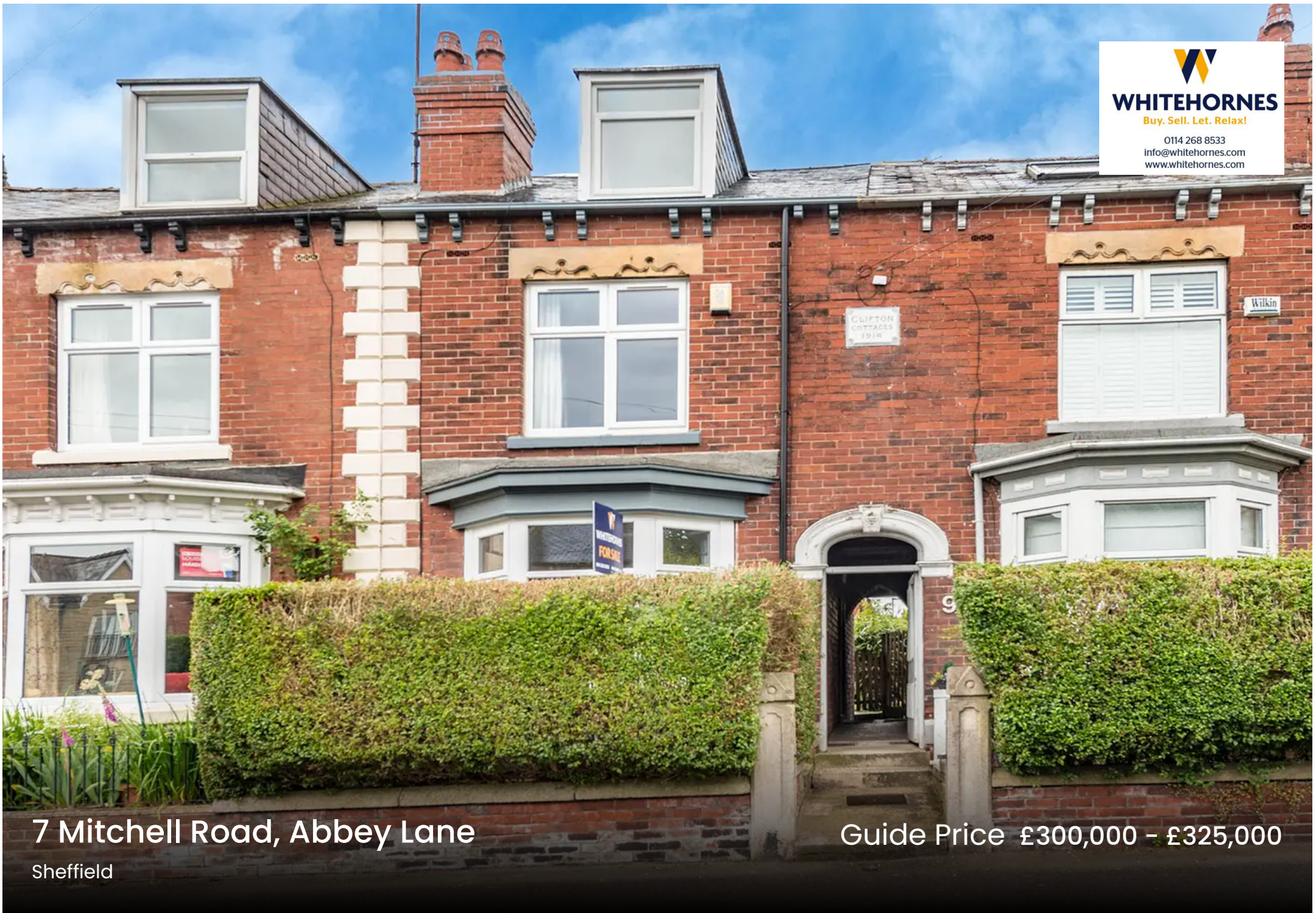

WHITEHORSES

Buy. Sell. Let. Relax!

0114 268 8533
info@whitehorses.com
www.whitehorses.com



7 Mitchell Road, Abbey Lane

Sheffield

Guide Price £300,000 - £325,000

7 Mitchell Road

Abbey Lane, Sheffield

An absolutely fabulous, immaculately presented, three double bedroom, bay windowed, Victorian terraced property. With three super spacious floors of accommodation totalling an impressive 1,340 sq feet the property enjoys a light and contemporary vibe throughout that has been careful to retain the original period features, character and charm associated with a property from this era. Boasting a double rear off shot, sizeable rear sunny and private garden together with easy on road parking to the front it's easy to say this property will sure to be a hit with the professional couple, young family and first time buyer alike. Enjoying a newly fitted slate roof, plenty of storage in all three bedrooms and available to the open market with no onward chain and vacant possession. Quietly tucked away on this incredibly popular residential road within the very heart of Abbey Lane number 7 is within a short stroll of numerous amenities within Woodseats, Graves park is a short hop.

Council Tax band: B Tenure: Leasehold

- FABULOUS THREE DOUBLE BEDROOM PERIOD VICTORIAN TERRACED
- THREE SPACIOUS FLOORS OF LIGHT ACCOMMODATION TOTALLING AN IMPRESSIVE 1,340 SQ FEET
- REAR PRIVATE LARGER THAN EXPECTED SUNNY GARDEN WITH NO THROUGH FARE FROM NEIGHBOURING PROPERTIES
- EXCELLENT LOCAL SCHOOLING CATCHMENTS INCLUDING ABBEY LANE
- PERFECT FOR THE YOUNG FAMILY MARKET OR THE PROFESSIONAL COUPLE
- NEWLY FITTED SLATE ROOF AND PKENTY OF STORAGE IN ALL BEDROOMS





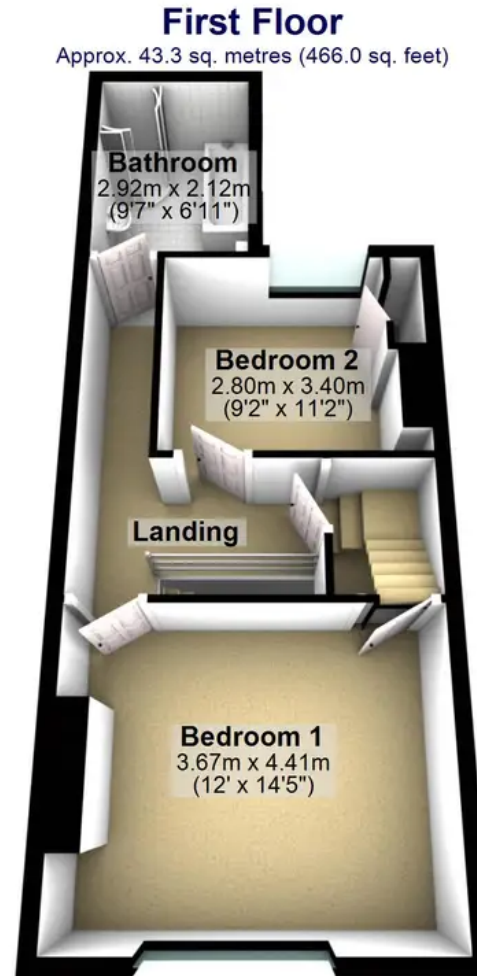
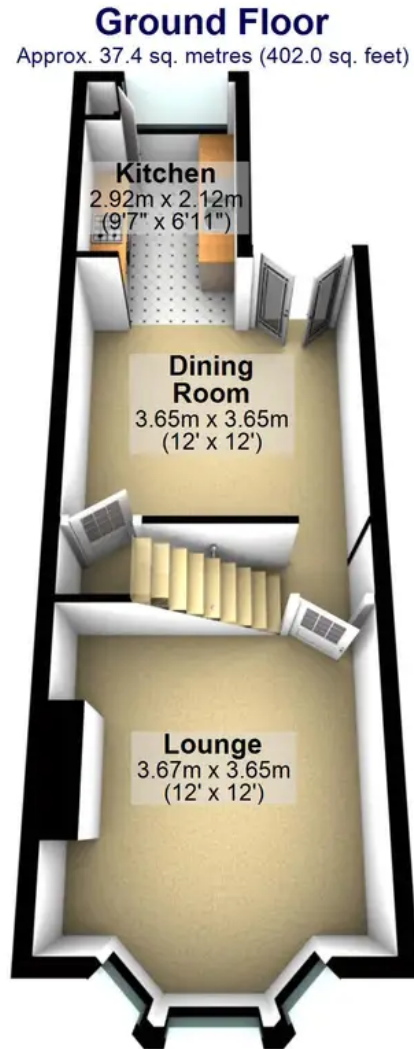
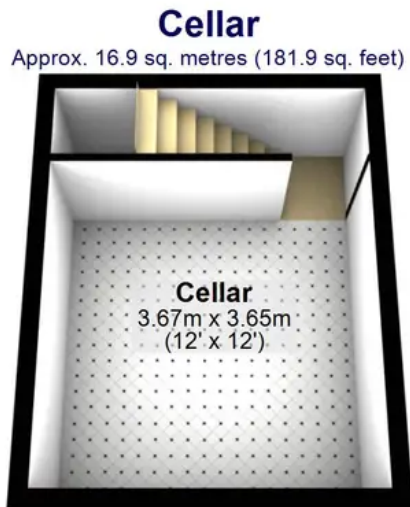

Total area: approx. 124.6 sq. metres (1340.8 sq. feet)

All measurements are approximate
Plan produced using PlanUp.

WHITEHORNES
Buy. Sell. Let. Relax!

0114 268 8533
info@whitehornes.com
www.whitehornes.com