



WHITEHORSES

Buy. Sell. Let. Relax!

0114 268 8533
info@whitehorses.com
www.whitehorses.com



4 Redthorn Road, Handsworth

Sheffield

Guide Price £250,000 – £260,000

4 Redthorn Road

Handsworth, Sheffield

An absolutely fabulous three bedroomed, bay windowed, semi detached family home. Recently finished to a super high standard by the current vendors to create this light bright and spacious feel framed by the rear open plan kitchen diner. Offered to the open market with the benefit of no upward chain and vacant possession its easy to say that viewing is essential to do full justice to this fabulous property. With off road parking, garage and larger than expected rear garden number four is perfect for the professional couple or the young family alike. With further potential to extend as neighboring properties have done so (subject to planning) to create a forever home the property is quietly tucked away within the very heart of popular Handsworth within easy access of numerous local amenities, excellent schooling catchments and commuting motorway networks. In brief the property comprises, entrance hall, bayed sitting room, rear dining kitchen.

Council Tax band: B Tenure: Leasehold

- FABULOUS THREE BEDROOM BAY WINDOWED SEMI DETACHED
- RECENTLY FINISHED AND REFURBISHED TO AN EXCELLENT STANDARD
- AVAILABLE WITH NO UPWARD CHAIN AND VACANT POSSESSION
- HEART OF ULTRA POPULAR HANDSWORTH SUBURB
- CLOSE TO NUMEROUS LOCAL AMENITIES AND COMMUTING MOTORWAY LINKS
- PERFECT FOR THE FIRST TIME BUYERS OR YOUNG FAMILY ALIKE
- VIEWING ESSENTIAL TO SEE THE FINISH ON OFFER
- OFF ROAD PARKING GARAGE AND REAR PRIVATE GARDEN





Ground Floor

Approx. 55.6 sq. metres (598.8 sq. feet)

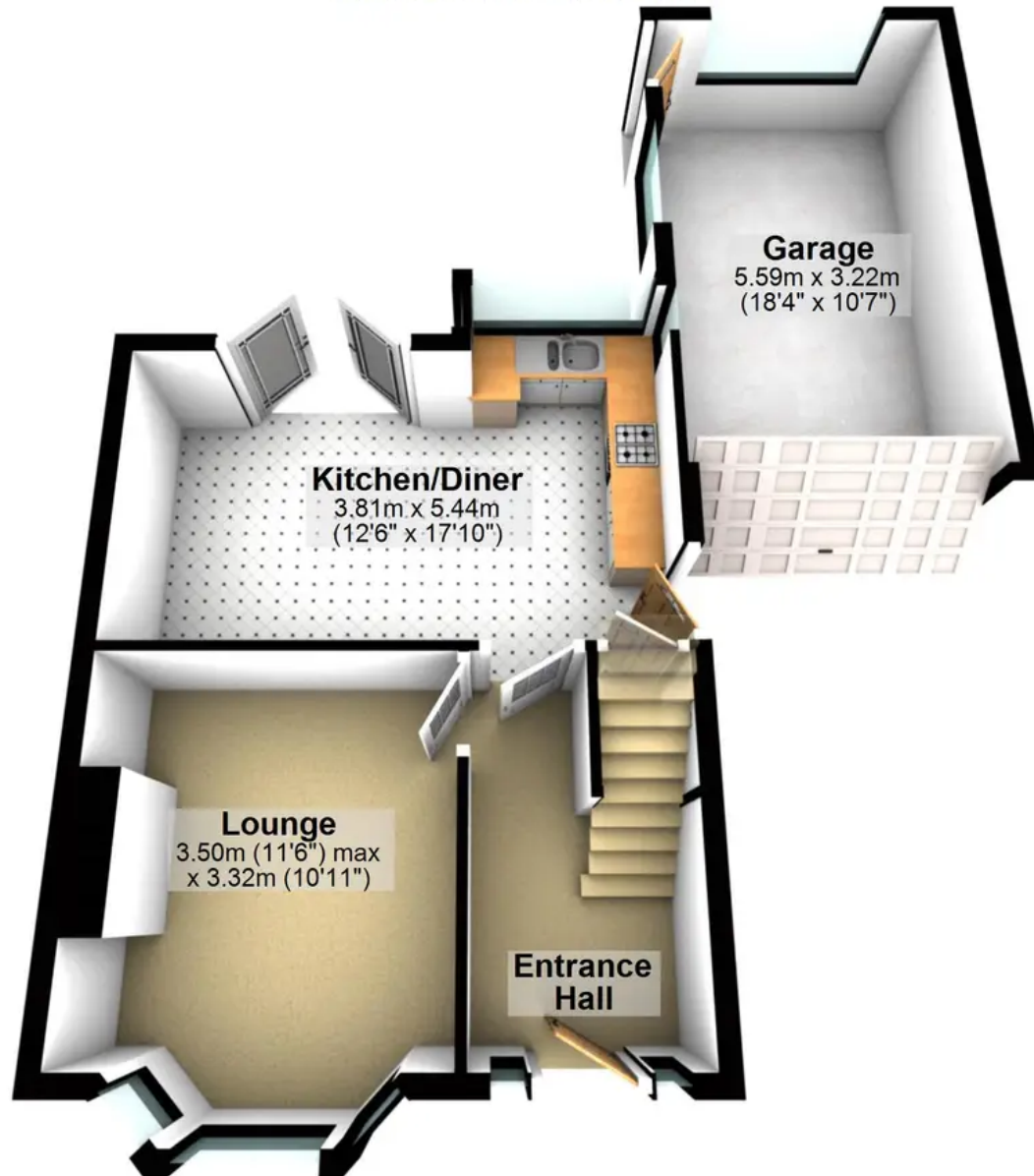

First Floor

Approx. 36.4 sq. metres (392.0 sq. feet)



Total area: approx. 92.0 sq. metres (990.8 sq. feet)

All measurements are approximate
Plan produced using PlanUp.