



WHITEHORNS

Buy. Sell. Let. Relax!

0114 268 8533
info@whitehorns.com
www.whitehorns.com

33 Tullibardine Road, Ecclesall

Sheffield

Guide Price £215,000 - £225,000

33 Tullibardine Road

Ecclesall, Sheffield

An excellent two bedroomed, mid Victorian terraced property. Offering huge opportunity and potential to create a personalised finished home and explore the opportunity to convert the existing loft and basement if required (subject to planning) to add value in the future. With a single rear off shot, private garden and easy on road parking to the front this property is sure to be popular with the professional couple, first time buyers or young family alike. Located within the very heart of ultra popular Ecclesall on the south west of tge city number lies within catchment fir Ofsted rated excellent schooling catchments of Greystones juniors and High Storrs secondary.

Council Tax band: A

Tenure: Leasehold

- WELL PRESENTED TWO BEDROOMED MID-TERRACED VICTORIAN PROPERTY
- PERFECT FOR THE PROFESSIONAL COUPLE OR YOUNG FAMILY
- OFSTED RATED EXCELLENT SCHOOLING CATCHMENTS OF GREYSTONES JUNIOR AND HIGH STORRS SECONDARY
- EASY ACCESS TO THE PEAK DISTRICT HOSPITALS AND UNIVERSITIES
- EASY ACCESS TO FASHIONABLE SHARROW VALE ECCLESALL ROAD AND BANNER CROSS AMENITIES
- HEART OF ULTRA POPULAR GREYSTONES ON THE SOUTH WEST OF THE CITY
- AVAILABLE WITH NO UPWARD CHAIN INVOLVED
- HUGE POTENTIAL TO CONVERT THE EXISTING LOFT AND BASEMENT (SUBJECT TO PLANNING)
- VIEWING ESSENTIAL TO SEE FULL POTENTIAL ON OFFER
- LEASEHOLD PROPERTY AND COUNCIL TAX BAND A





Ground Floor

Approx. 38.6 sq. metres (415.3 sq. feet)

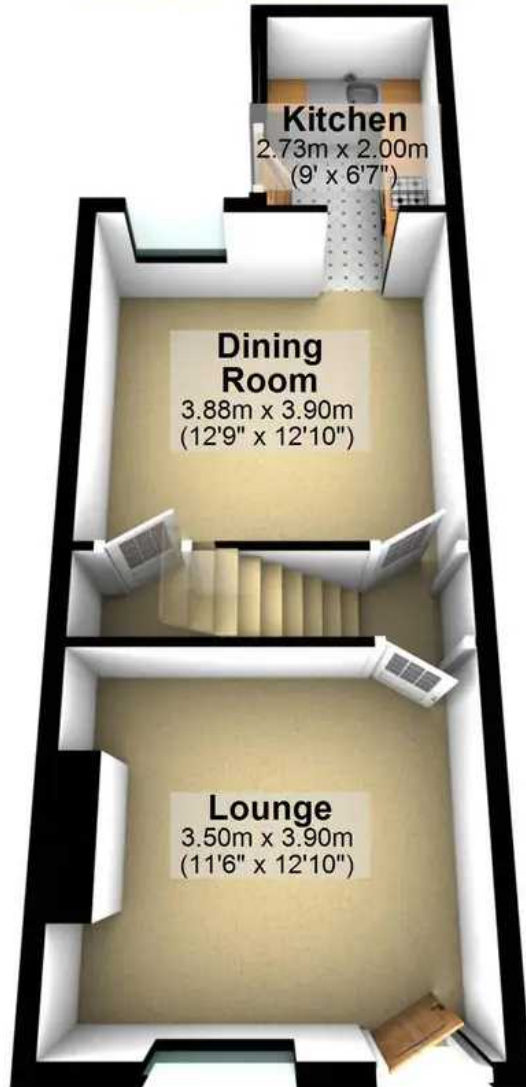

First Floor

Approx. 32.9 sq. metres (354.4 sq. feet)

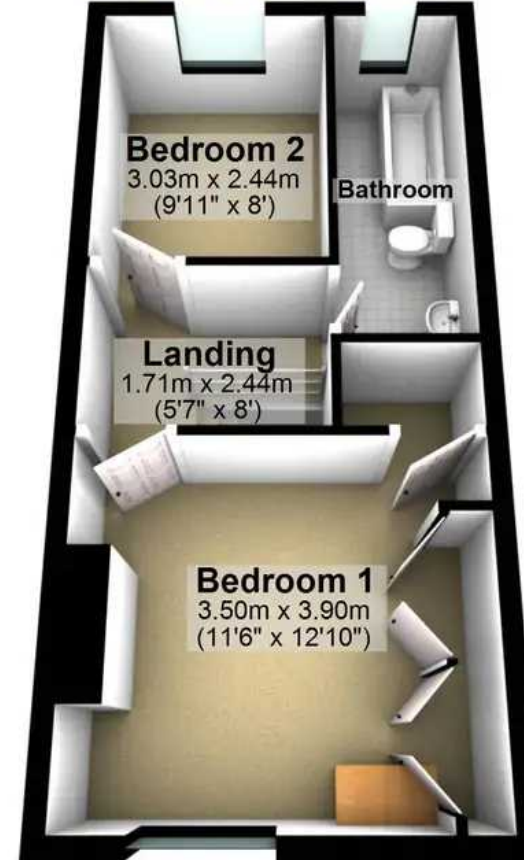

Total area: approx. 71.5 sq. metres (769.7 sq. feet)

All measurements are approximate
Plan produced using PlanUp.