



WHITEHORNES
Buy. Sell. Let. Relax!
0114 268 8533
info@whitehorses.com
www.whitehorses.com



42 Trap Lane, Bents Green

Sheffield

Guide Price £615,000-£630,000

42 Trap Lane

Bents Green, Sheffield

Redefining the term contemporary modern open plan family living is outstanding, immaculately presented and very deceptive five bedroomed, three bathroomed, semi detached home. Having been meticulously well finished and expertly extended by the current vendors with absolutely no expense spared to create this breathtaking end result. With accommodation arranged over two floors that total 1,853 sq feet this property has been specifically designed to cater perfectly for the growing family market. With a bespoke finish, off road parking, store and super private rear garden it's really easy to say that viewing is absolutely essential to fully appreciate the size and style on offer. Located on this incredibly popular residential road in the very heart of ultra popular Bents Green

Council Tax band: C

Tenure: Freehold

- STUNNING FIVE BEDROOMED SEMI DETACHED
- RECENTLY EXTENDED AND FINISHED TO THE HIGHEST OF STANDARDS
- CLOSE TO WOODLAND WALKS AND THE PEAK DISTRICT
- OFSTED RATED EXCELLENT SCHOOLING CATCHMENTS
- OFF ROAD PARKING GARAGE AND PRIVATE GARDEN
- VIEWING ABSOLUTELY ESSENTIAL TO FULLY APPRECIATE THE SIZE AND STYLE ON OFFER
- OPEN PLAN CONTEMPORARY LIVING DELIVERED AT ITS BEST
- AVAILABLE WITH NO ONWARD CHAIN





Ground Floor

Approx. 88.6 sq. metres (953.7 sq. feet)

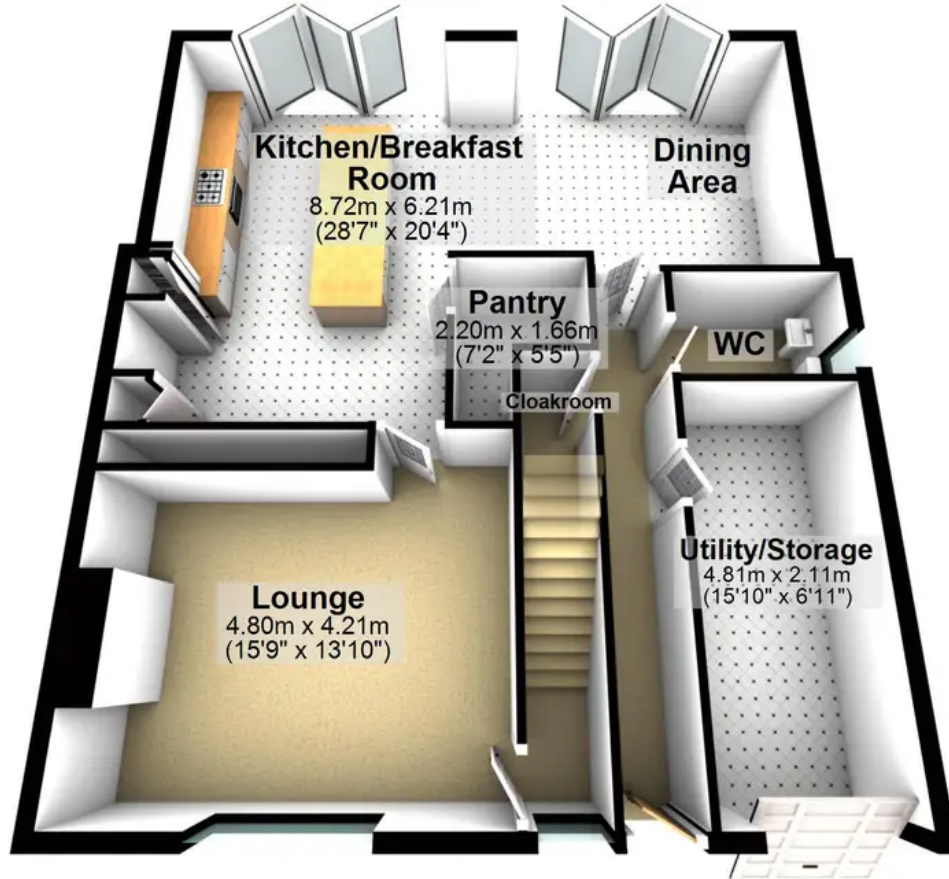

First Floor

Approx. 83.5 sq. metres (899.3 sq. feet)

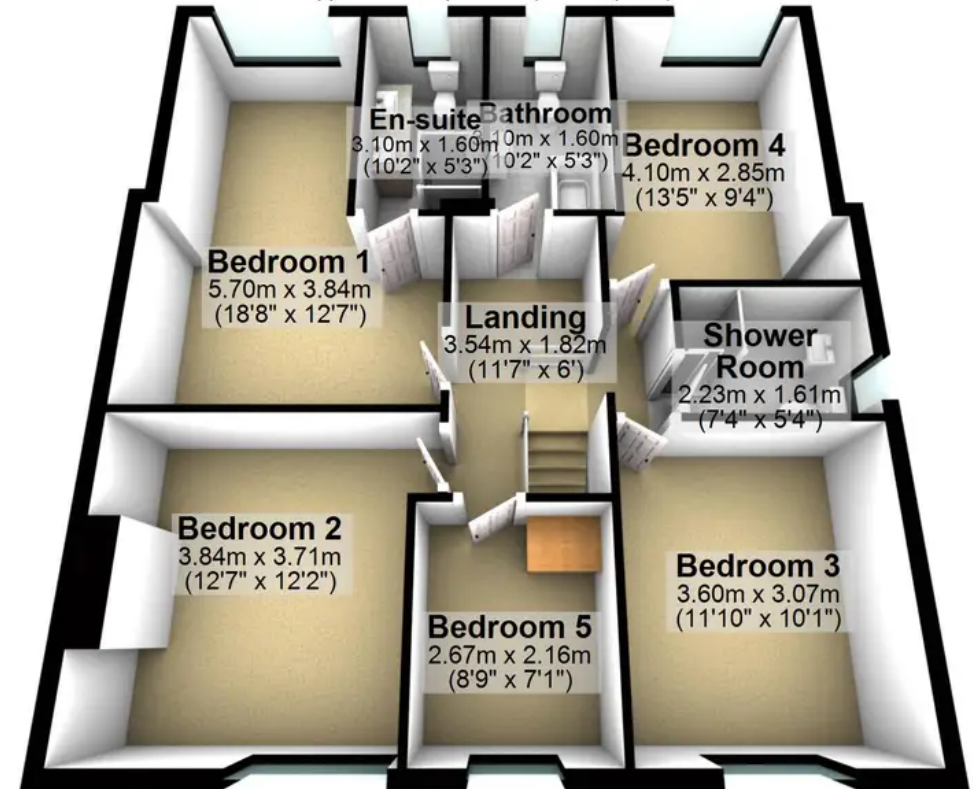

Total area: approx. 172.2 sq. metres (1853.0 sq. feet)

All measurements are approximate
Plan produced using PlanUp.



WHITEHORSES

Buy. Sell. Let. Relax!

0114 268 8533
info@whitehorses.com
www.whitehorses.com